

PITTSFIELD TWP
Middle Part Scale 1"=400'

PAGE 11

WAKEMAN BELDEN RD. ROUTE 303

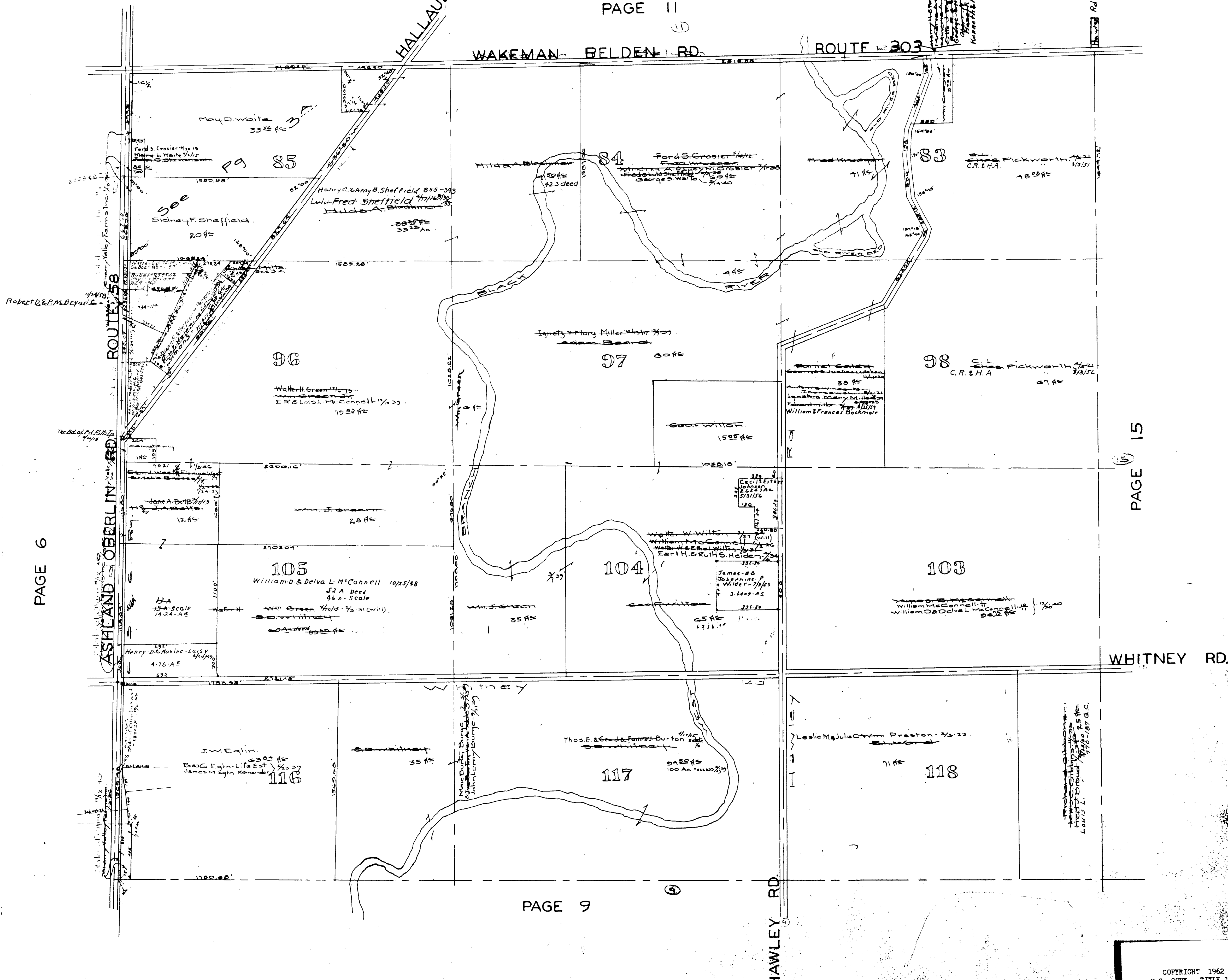

PAGE 6

PAGE 15

PAGE 9

MAP OF
PITTSFIELD TOWNSHIP

COPYRIGHT 1962
U.S. CODE, TITLE 17
LORAIN COUNTY, OHIO
Reproduced by
Allied Microfilm Corp.
Akron, Ohio