

WHITNEY RD.

LaGrange Twp.
South Middle Part.
Scale 1" = 400'

See Misc. App. No. 294295 stating that there is no school here.

PAGE 15

PAGE 13

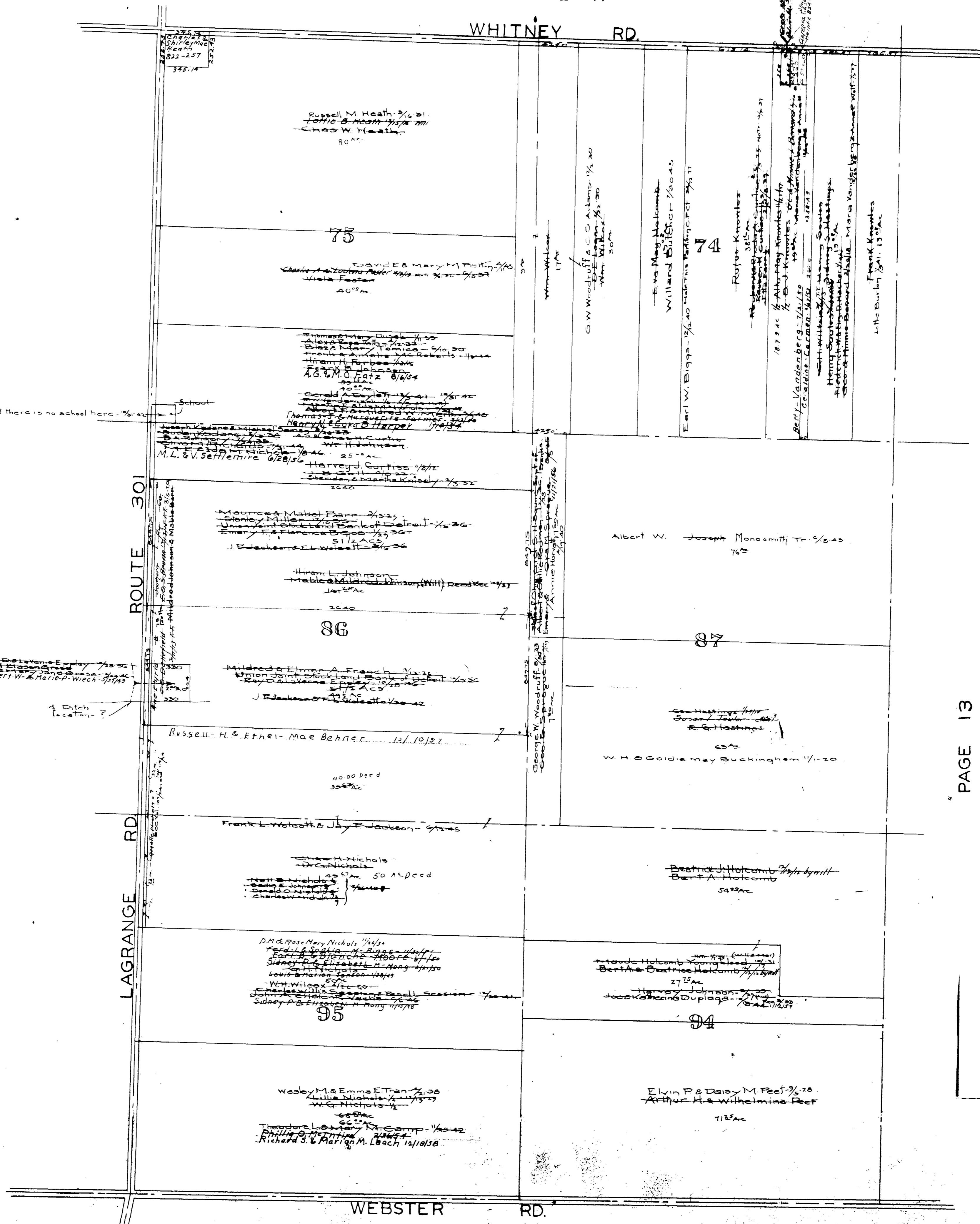

COPYRIGHT 1962
U.S. CODE, TITLE 17
LORAIN COUNTY, OHIO
Reproduced by,
Allied Microfilm Corp.
Akron, Ohio