

AVON MAP OF VILLAGE

COPYRIGHT 1962  
U.S. CODE, TITLE 17  
LORAIN COUNTY, OHIO  
Reproduced by,  
Allied Microfilm Corp.  
Akron, Ohio

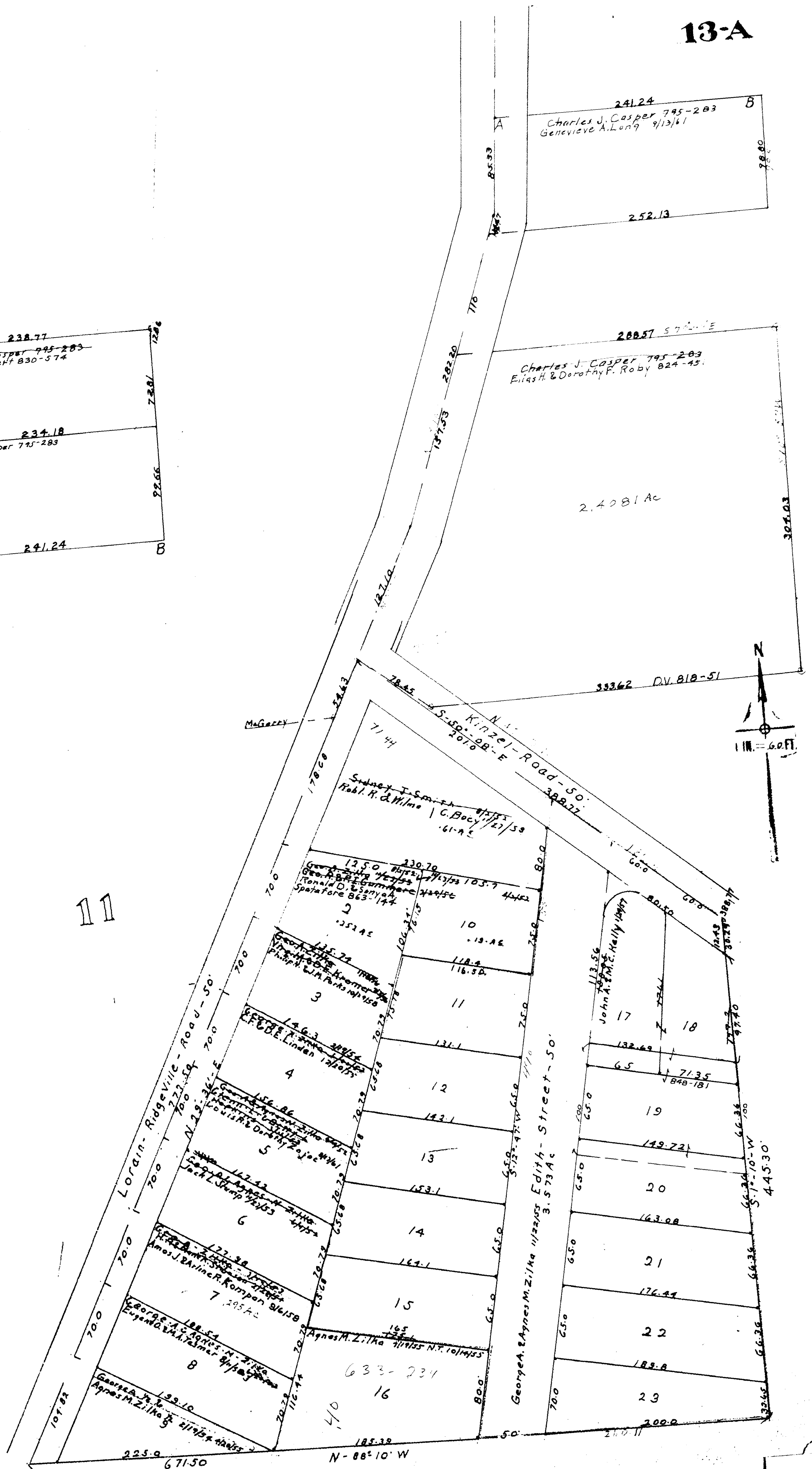
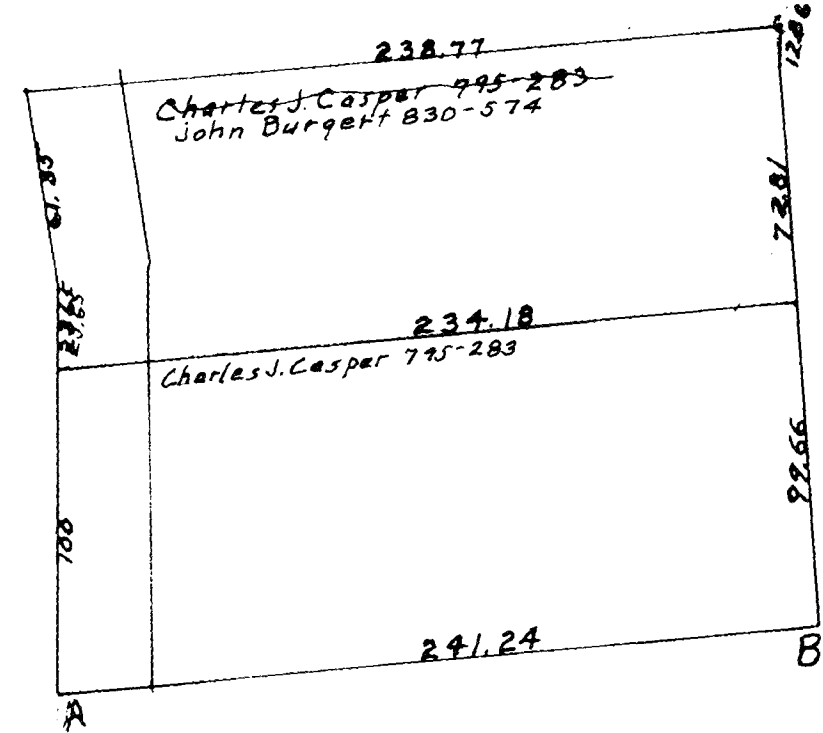

11

KLINGSHIRN-ALLOTMENT No. 2-PROPOSED  
 Section No. 11-AVON-Village  
 Lots in blank - Edith Klingshirn & Edward Klingshirn.

MAP OF  
**AVON VILLAGE**

COPYRIGHT 1962  
 U.S. GEO. TITLE 17  
 LORAIN COUNTY, OHIO  
 Reproduced by,  
 Allied Microfilm Corp.  
 Akron, Ohio



Sec 10 Sec 15  
JEROME FORTHOFFER SUB No 2 Vol. 20 Pg. 6A Lots in Blank Jerome & Marilyn Forthofer No 3 Vol. 21 Pg. 18  
N 89° 32' 20" W 150' 210.00' Wm. C. & Margaret E. Smith Lots in Blank Jerome & Marilyn Forthofer  
Gardenland Development Corp. 11/14/59

COPYRIGHT 1962  
U.S. CODE, TITLE 17  
LOHAIN COUNTY, OHIO  
Reproduced by  
Allied Microfilm Corp.  
Akron, Ohio

MAP OF  
AVON VILLAGE

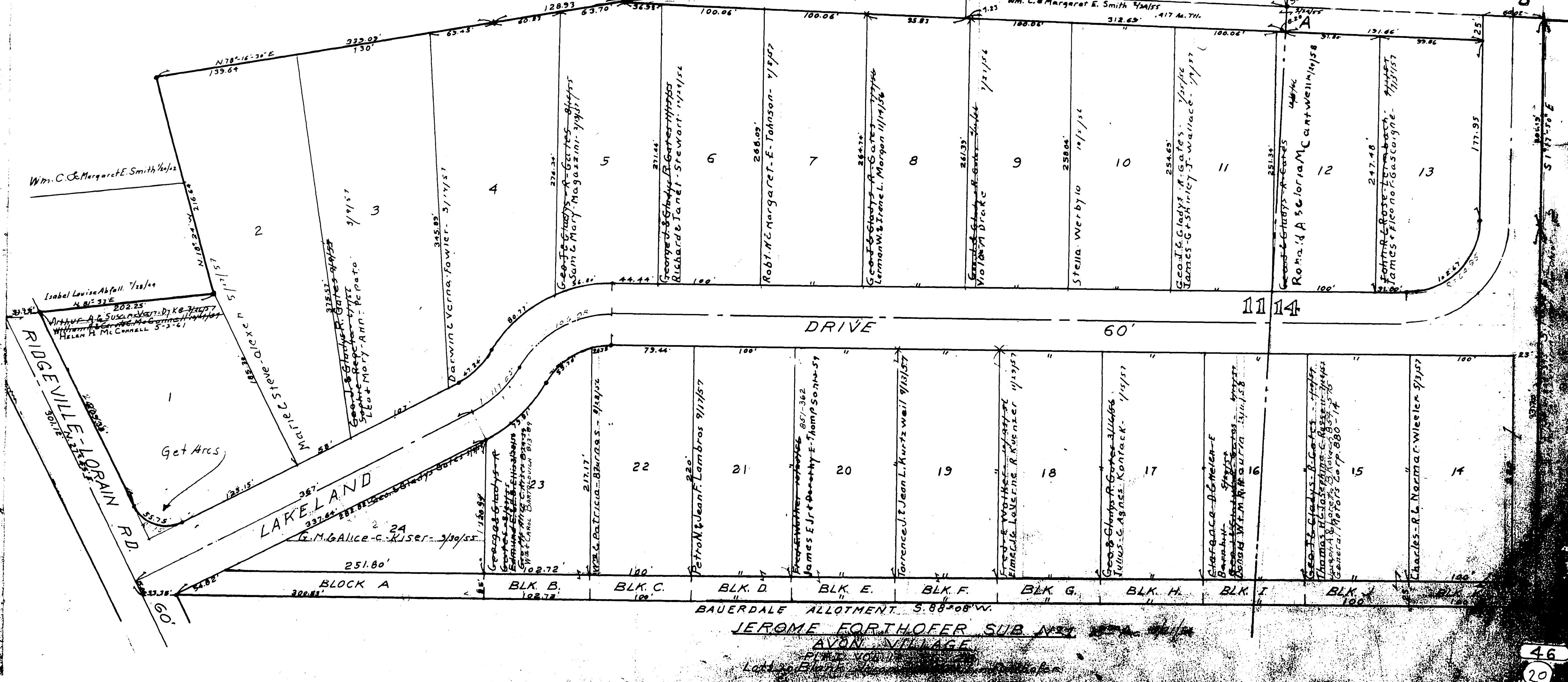
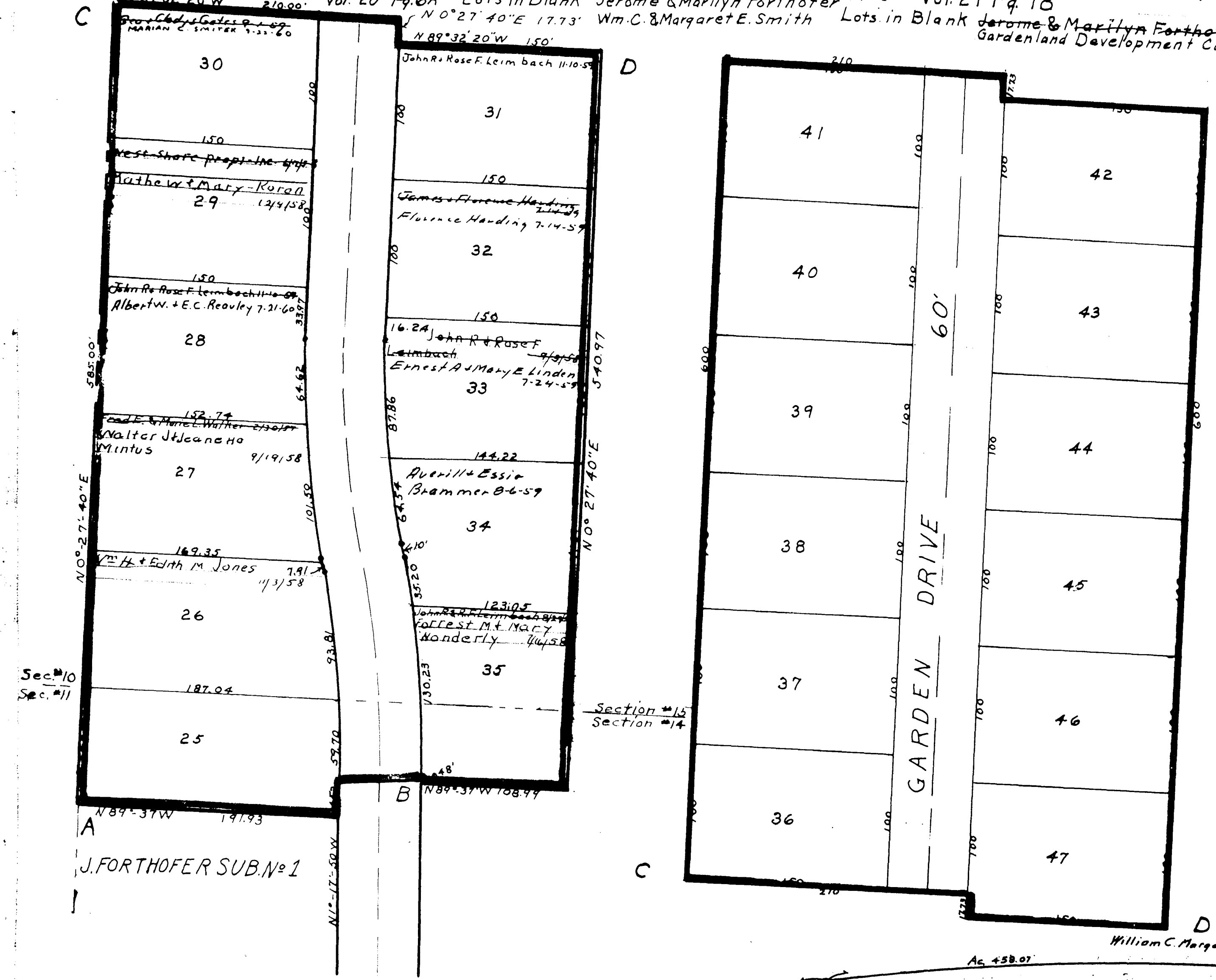

13  
B

46  
20

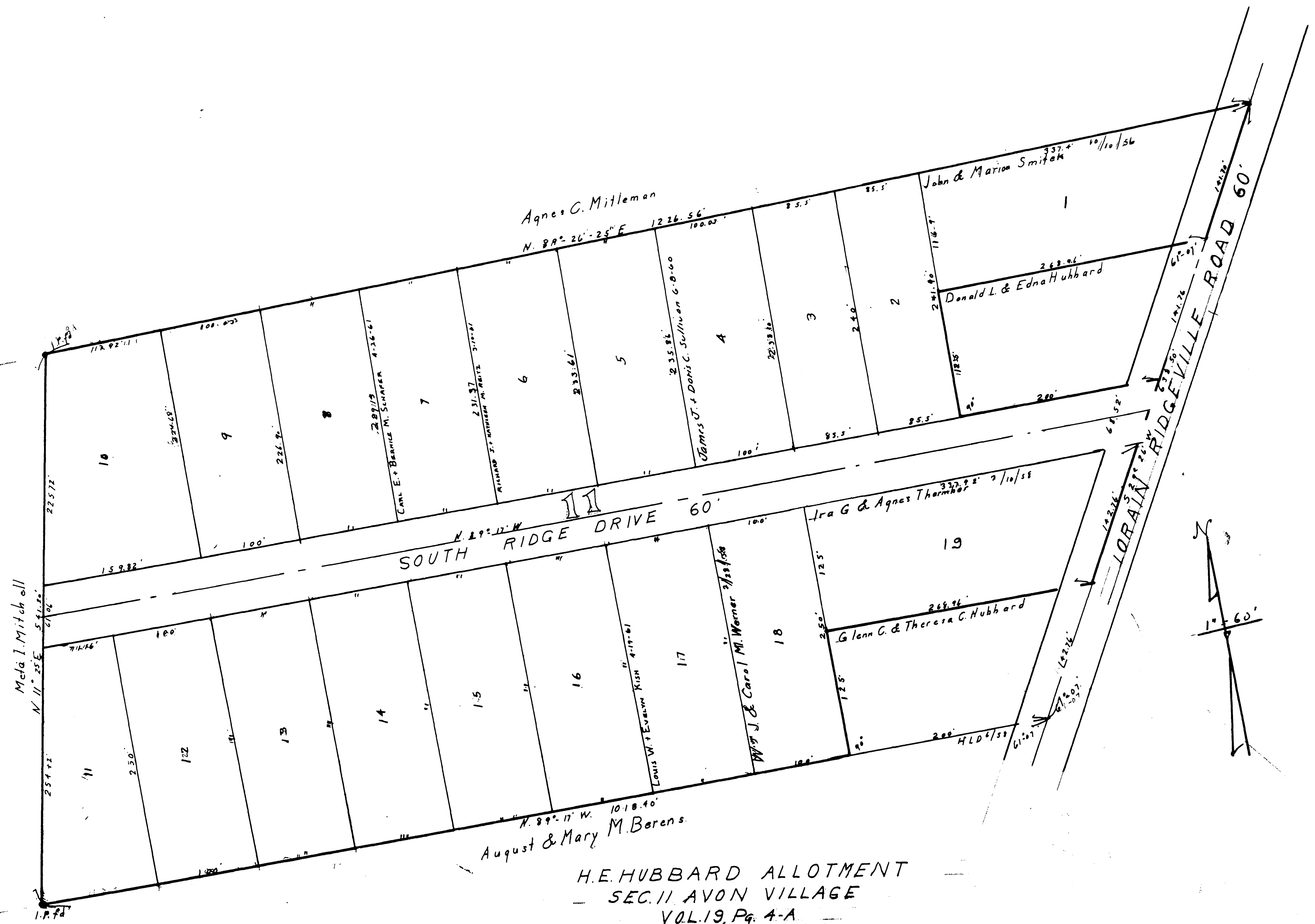

SOUTH RIDGE DRIVE 60'

RIDGEVILLE ROAD 60'  
LORAIN RIDGEVILLE ROAD 60'

H.E. HUBBARD ALLOTMENT  
- SEC. 11 AVON VILLAGE  
VOL. 19, Pg. 4-A  
Lots in Blank: H.E. Hubbard

AVON MAP OF VILLAGE

COPYRIGHT 1962  
U.S. CODE, TITLE 17  
LORAIN COUNTY, OHIO  
Reproduced by  
Allied Microfilm Corp.  
Akron, Ohio

13  
C

47  
21



# MAP OF AVON VILLAGE

COPYRIGHT 1962  
U.S. CODE, TITLE 17  
LORAIN COUNTY, OHIO  
Reproduced by,  
Allied Microfilm Corp.  
Akron, Ohio

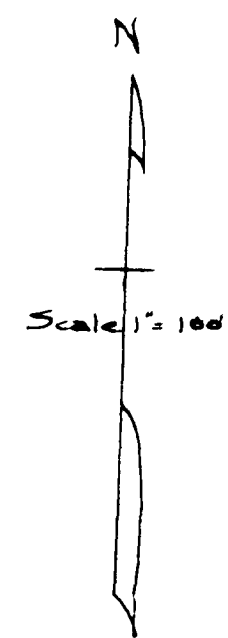

French Creek  
Section 11  
South End of Village  
Benham's First Add V.3-P.9

