

**BASIS OF BEARING**

BEARINGS ARE BASED ON THE CENTERLINE OF REED ROAD, OBSERVED AS NORTH 0°37'05" EAST FROM MONUMENTS FOUND, PER THE OHIO STATE PLANE COORDINATES SYSTEM, NORTH ZONE (3401), NAD83 (2011), 2010.0 EPOCH, AS DERIVED FROM GNSS OBSERVATIONS PER THE O.D.O.T. RTN (REAL-TIME-NETWORK).

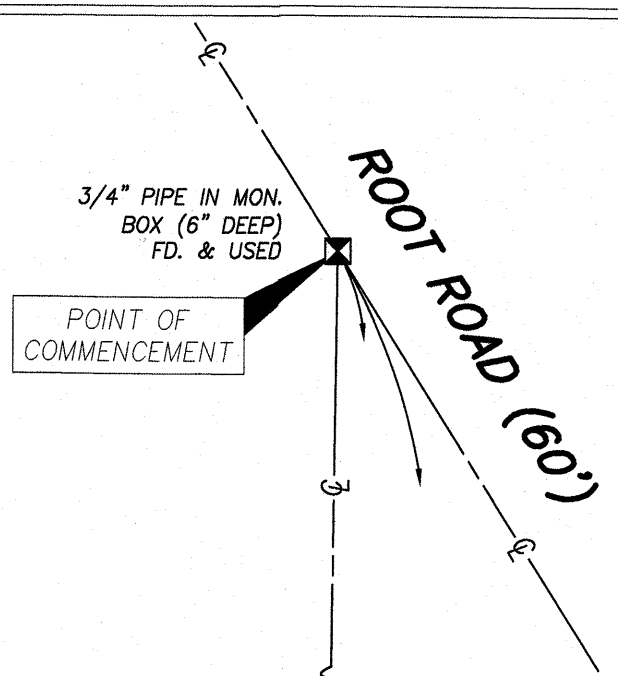

**BOUNDARY SURVEY**  
FOR  
**9438 REED ROAD**  
KNOWN AS BEING PART OF ORIGINAL RIDGEVILLE TOWNSHIP LOT 12,  
RANGE 16 WEST, TOWNSHIP 6 NORTH OF THE CONNECTICUT  
WESTERN RESERVE SURVEY, NOW SITUATED IN THE  
**CITY OF NORTH RIDGEVILLE**  
**COUNTY OF LORAIN - STATE OF OHIO**

**McSteen**  
LAND SURVEYORS  
1415 East 286th Street Wickliffe, OH 44092  
Phone: 440.585.9800 www.mcsteen.com

THIS SURVEY IS A BOUNDARY SURVEY PREPARED IN ACCORDANCE WITH CHAPTER 4733-37, OHIO ADMINISTRATIVE CODE. DISTANCES ARE GIVEN IN US SURVEY FEET AND DECIMAL PARTS THEREOF. ALL IRON PINS SHOWN AS SET ARE 30" LONG 5/8" REBAR WITH AN IDENTIFICATION CAP STAMPED "MCSTEEN CA 02236".

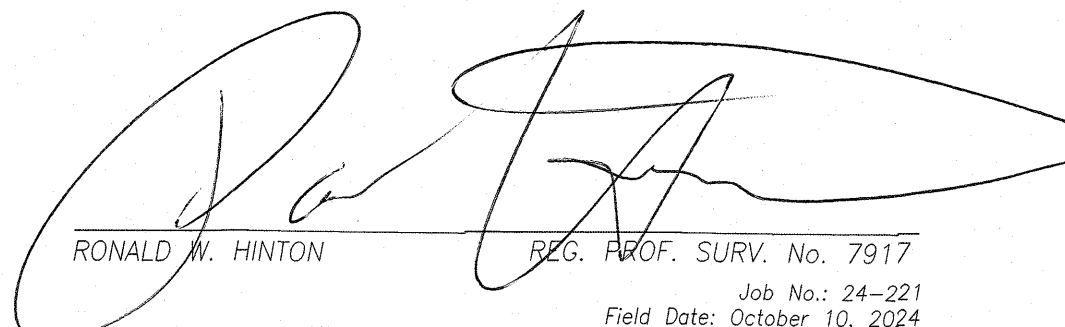
  
RONALD M. HINTON REG. PROF. SURV. No. 7917  
Job No.: 24-221  
Field Date: October 10, 2024  
Survey Date: October 31, 2024  
Drawn By: TEE

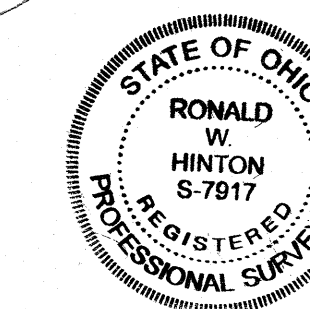

APPROVED  
LORAIN CO  
MAP DEPT  
DATE 11/5/24  
PAGE 07-00-012  
BY WRZ  
24-05398-C  
51317

PPN 07-00-012-101-041  
MARIA DELIA MONTEAGUDO  
INST. 1998-0561138 L.C.D.R.

PPN 07-00-012-101-023  
JOHN R. KUROWSKI & LINDSAY E. JAKUBOWSKI  
INST. 2020-0766083 L.C.D.R.

PPN 07-00-012-101-011  
WAYNE R. KOWALKA & MARY L. KOWALKA  
INST. 2022-0902560 L.C.D.R.  
0.654 ACRES CALC.  
(0.065 ACRES WITHIN REED ROAD R/W)

1 STORY  
FRAME  
DWELLING  
H.N. 9438

PPN 07-00-012-101-014  
JUSTIN MORAN  
INST. 2024-0020721 L.C.D.R.

PPN 07-00-012-101-012  
DANNY L. WILHELM & GLORIA J. WILHELM  
INST. 2005-0077891 L.C.D.R.

PPN 07-00-012-101-013  
BRADLEY D. BECKETT & SUSAN A. BECKETT  
DEED VOL. 793, Pg 991 L.C.D.R.

**LEGEND**

- REBAR FOUND AS NOTED
- 5/8" DIAMETER X 30" LONG REBAR WITH "MCSTEEN CA 02236" ID CAP SET
- ⊠ MONUMENT BOX FOUND AS NOTED
- PIPE FOUND AS NOTED
- ⊕ CENTERLINE
- R/W RIGHT-OF-WAY
- CALC. CALCULATED DISTANCE OR ANGLE
- OBS. OBSERVED DISTANCE OR ANGLE
- REC. RECORD DISTANCE OR ANGLE
- FD. FOUND
- MON. MONUMENT
- L.C.M.R. LORAIN COUNTY MAP RECORDS
- L.C.D.R. LORAIN COUNTY DEED RECORDS
- O.D.O.T. OHIO DEPARTMENT OF TRANSPORTATION

**SURVEY REFERENCES**

- "LOT SPLIT SURVEY" PERFORMED BY JOSEPH A. BURGOON, P.S. 8325, ON BEHALF OF LEWIS LAND PROFESSIONALS, INC. PROJ. NO. 19-143, DATED MAY 2019, LORAIN COUNTY SURVEY RECORD NO. 48,721.
- LORAIN COUNTY SURVEY RECORDS  
NO. 48,787  
NO. 40,234  
NO. 23,524  
NO. 23,521  
NO. 23,486
- LORAIN COUNTY DEED RECORDS
- LORAIN COUNTY TAX MAPS

O.L. 13  
O.L. 12

CITY OF NORTH RIDGEVILLE ORIGINAL RIDGEVILLE TOWNSHIP LOT 12  
EATON TOWNSHIP ORIGINAL EATON TOWNSHIP LOT 30