

COOLEY ROAD (60')

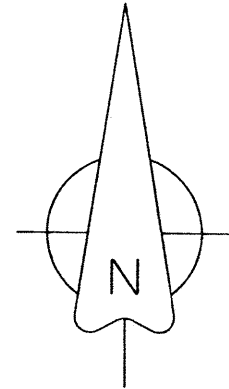

**APPROVED  
LORAIN CO  
MAP DEPT**

DATE 7/8/24

PAGE 11-00-014

BY WRZ

24-04878

11-00-014-000-031  
WOODS AT EATON, LLC  
DOC. #20190734644  
10/17/19  
(63.91 ACS.)

Course	Bearing	Distance
L1	N 88°43'13" E	151.20'
L2	S 87°44'33" W	213.00'
L3	S 87°44'33" W	151.15'

11-00-014-000-031  
WOODS AT EATON, LLC  
DOC. #20190734644  
10/17/19  
(63.91 ACS.)

DIMENSIONS SHOWN ON THIS PLAT ARE EXPRESSED IN FEET AND DECIMAL PARTS THEREOF. ALL BEARINGS ARE TO AN ASSUMED MERIDIAN AND ARE USED TO DESCRIBE ANGLES ONLY. PERMANENT MONUMENTS WERE FOUND OR SET AS INDICATED, ALL OF WHICH I CERTIFY TO BE CORRECT.

THOMAS A. SIMON, REGISTERED  
PROFESSIONAL SURVEYOR NO. S-7775

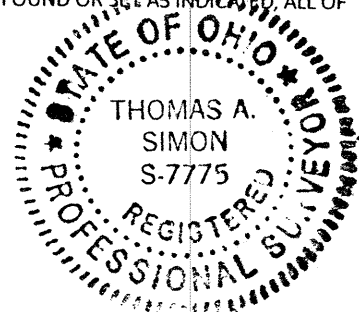

BASIS OF BEARINGS IS THE CENTERLINE OF COOLEY ROAD (NORTH 88°43'13" EAST). IRON PINS SET ARE 3/8" DIAMETER, 30" LONG WITH PLASTIC CAPS "T. SIMON, S-7775".

LARGE FALLEN TREE  
OVER TOP OF PROPERTY  
CORNER

11-00-014-000-039  
PALMER ENTERPRISES, LTD.  
DOC. #20220887889 8/18/22

PLAT OF BOUNDARY SURVEY  
AND SPLIT  
FOR  
WOODS AT EATON, LLC  
BEING KNOWN AS PART OF  
ORIGINAL EATON TOWNSHIP  
LOT NO. 14  
COUNTY OF LORAIN STATE OF OHIO  
APRIL, 2024 SCALE: 1" = 200'