

REFERENCES:
 PLAT OF SURVEY FOR OAK KNOLL INVESTMENTS CO.
 BY: LOWELL E. BENDER
 DATED: DEC, 1994
 SCANNED SURVEYS #10,055

WOODLANDS ESTATES SUBDIVISION NO.2
 PLAT VOL.51, PGS.18-19
 DATED: APRIL, 1993

BEARINGS ARE PER THE CENTERLINE BEARING OF WOODLANDS DRIVE (N73°17'01"E) PER THE WOODLANDS ESTATES SUBDIVISION NO. 2 AS RECORDED IN PLAT VOLUME 51, PAGE 18-19 OF THE LORAIN COUNTY PLAT RECORDS AND ARE USED TO DENOTE ANGLES ONLY.

LEGEND

- = MONUMENT BOX
- = IRON PIN/DRILL HOLE FND
- △ = STONE FND
- = IRON PIN SET 5/8"X30" REBAR CAPPED "AZTECH 8249"

I CERTIFY THAT I HAVE SURVEYED THE PREMISES AND PREPARED THE SURVEY MAP IN ACCORDANCE WITH THE PROVISIONS OF CHAPTER 4733-37 OF THE OHIO ADMINISTRATIVE CODE.

Stan Loch
 STAN LOCH DATE 6-7-2024
 REG SURVEYOR #8249

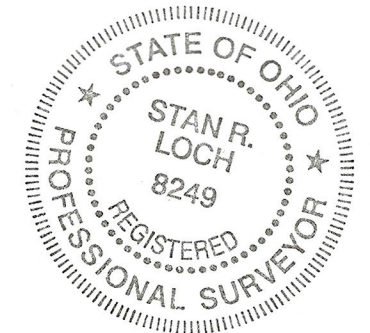

51205
 APPROVED
 LORAIN CO
 MAP DEPT

DATE 6/12/2024
 PAGE 01-00-002
 BY A.Carden
 #2404967

S/L 11
 WOODLANDS ESTATES
 SUBDIVISION NO.2
 PLAT VOLUME 51, PAGE 18-19

LOT CONSOLIDATION SURVEY
 FOR
 MICHAEL & MONICA STARK
 BEING PART OF SUBLot 13 IN THE WOODLANDS ESTATES SUBDIVISION NO. 2
 PLAT VOLUME 51, PAGE 18-19
 PART OF BROWNHELM TOWNSHIP ORIGINAL LOT NO. 2
 SITUATED IN THE CITY OF VERMILION
 COUNTY OF LORAIN, STATE OF OHIO

5425 WARNER ROAD - SUITE 12
 VALLEY VIEW, OHIO 44125
 440-602-9071 FAX 216-369-0259



HORIZ. SCALE: 1" = 20'	VERT. SCALE:
DRAWN BY: CL	DATE: 6/7/2024
CHECKED BY: SRL	DRAWING NO.: 20243975
JOB NO.: 20243975	SHEET: 1 OF 1

NO.	DATE	DESCRIPTION	BY

