

Survey # 51178

APPROVED
LORAIN CO
MAP DEPT

DATE 5-7-24

PAGE 05-00-017

BY D. Adelsberg

24-05290-C

05-00-017-000-027

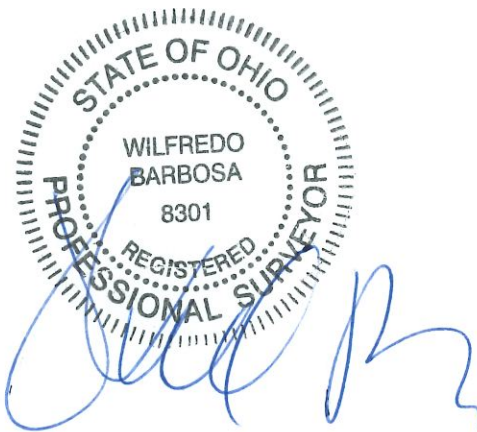

- LEGEND:**
- ⊕ = 5/8" REBAR SET WITH I.D. CAP
 - = PIPE FOUND
 - = PIPE FOUND AND USED
 - ▲ = IRON PIN/ REBAR FOUND
 - ▲ = IRON PIN/ REBAR FOUND AND USED
 - = MONUMENT BOX
 - ⊕ = DRILL HOLE FOUND
 - C.L. = CENTERLINE
 - O, OBS = OBSERVED
 - C, CALC = CALCULATED
 - R, REC = RECORDED
 - I.N. = INSTRUMENT NUMBER
 - ORV = OFFICIAL RECORD VOLUME
 - O.L. = ORIGINAL LOT
 - PCL = PARCEL
 - AC = ACREAGE

CHARLES AVENUE

30'

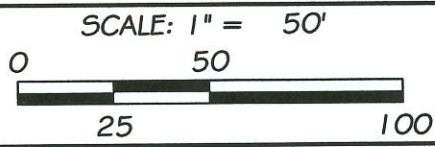

PREPARED AT THE REQUEST OF:
Lupe Bessette
EXECUTOR OF ESTATE

Survey
PARCEL 05-00-017-000-027
PART OF ORIGINAL LOT 17 AMHERST TWP
CITY OF AMHERST COUNTY OF LORAIN
STATE OF OHIO

BARBOSA AND ASSOCIATES LLC
5604 CASE ROAD
NORTH RIDGEVILLE, OH 44039
440 327-4776

5/1/2024	CHECKED BY:WB
JOB No: 2024-4-6	SHEET 1 of 1