

NORTH RIDGE ROAD (COUNTY ROAD 1) (66' R/W)

NORTH QUARRY ROAD (COUNTY ROAD 30) (60' R/W)

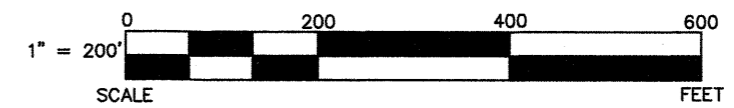

LEGEND

SET	FOUND	DESCRIPTION
⊗	⊗	MONUMENT
⊕	⊕	RAILROAD SPIKE
⊙	⊙	P.K. NAIL
○	●	IRON PIPE
○	⊖	DRILL HOLE
○	⊖	5/8"Øx30" IRON ROD
○	⊖	IRON ROD
■	■	FENCE POST
▲	▲	STONE
□	□	MONUMENT BOX
D		DEED
P		PLAT
M		MEASURED
C		CALCULATED
∅		OUTSIDE DIAMETER
SR		SURVEY RECORD



REFERENCES

DEED VOLUMES AND PAGES AS SHOWN
 LORAIN COUNTY ROAD RECORDS
 SURVEY FOR WESTWOOD ESTATES MHC, LLC DATED 11/11/19
 SURVEY FOR FABRIZIO DATED AUGUST, 2008
 SURVEY FOR BRAYLEY DATED FEBRUARY 20, 1995
 SURVEY FOR KNIGHT DEVELOPMENT DATED SEPTEMBER 2022
 PLAT VOLUME 36, PAGE 5

THIS SURVEY DOES NOT INCLUDE A TITLE SEARCH. ALL EASEMENTS OR OTHER ENCUMBRANCES ON OR OVER THE LAND ARE NOT SHOWN ON THIS SURVEY. PLEASE FURNISH ALL INFORMATION IF THESE ARE REQUIRED ON THIS PLAT. ALL FOUND SURVEY MONUMENTS WERE AT GRADE OR PAVEMENT SURFACE AND IN GOOD CONDITION, UNLESS OTHERWISE NOTED.

I HEREBY DECLARE THAT I HAVE SURVEYED THE ABOVE DESCRIBED PROPERTY DURING NOVEMBER, 2023 AS PER LEGAL DESCRIPTION FURNISHED TO ME. THIS SURVEY IS SUBJECT TO ALL LEGAL HIGHWAYS, EASEMENTS; RESTRICTIONS, LEASES OF RECORD AND OF RECORDS IN RESPECTIVE UTILITY OFFICES. THE BEARINGS REFERRED TO HEREON ARE BASED ON THE OHIO NORTH STATE PLANE COORDINATE SYSTEM.

PARCEL F
 1.2893 acres
 56,162.15 sq. ft.
 0.0975 acres in R/W
 4,247.83 sq. ft. in R/W
 1.2893 acres in PP# 0500097103146
 56,162.15 sq. ft. in PP# 0500097103146

PARCEL E
 6.1964 acres
 269,913.19 sq. ft.
 0.0947 acres in R/W
 4,125.00 sq. ft. in R/W
 1.2544 acres in PP# 0500097103145
 54,642.06 sq. ft. in PP# 0500097103145
 4.9420 acres in PP# 0500097103146
 215,271.13 sq. ft. in PP# 0500097103146

GARY DEIDRICK et al
 RN 20120437112

J&J PROPERTY HOLDINGS LLC
 RN 20230926835

NICHOLAS RADCA
 RN 20230908724

RICHARD A & CAROL J WALKUSH
 OR 55, Pg 296

RICHARD & CAROL J WALKUSH
 DV 1347, Pg 427

DEREK R, DANIEL G & MELANIE A WALKUSH
 RN 20110381352

CHRISTOPHER JOSEPH LAUER
 RN 20230906475

NEW DEAL & LAURA OWENS
 RN 19970471722

MICHAEL & JOANN PRICE
 RN 20180678386

PEGGY JEAN MARTY
 RN 20170636212

APPROVED
LORAIN CO
MAP DEPT
DATE 4/17/24
PAGE 05-00-097
BY WJRZ
51165

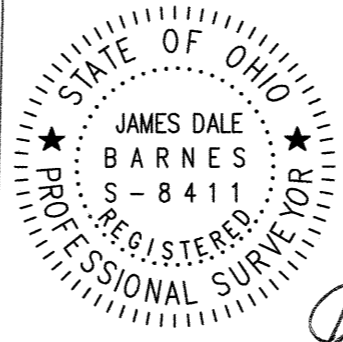

James Dale Barnes 4/12/23

JAMES DALE BARNES, P.S. 8411 DATE

BARNES SURVEYING
 10312 MASON ROAD, CASTALIA, OHIO 44824-9218
 OFFICE: (419) 684-7742 CELL: (419) 871-1780
SURVEY FOR: CHRIS LAUER
 SITUATED IN ORIGINAL LOT 97 OF AMHERST TOWNSHIP, LORAIN COUNTY, OHIO