

LOT CONSOLIDATION PLAT

FOR: WINK BELL, INC.

SITUATED IN THE CITY OF NORTH RIDGEVILLE, COUNTY OF LORAIN AND STATE OF OHIO AND KNOWN AS BEING PART OF ORIGINAL RIDGEVILLE TOWNSHIP LOT NO. 28.

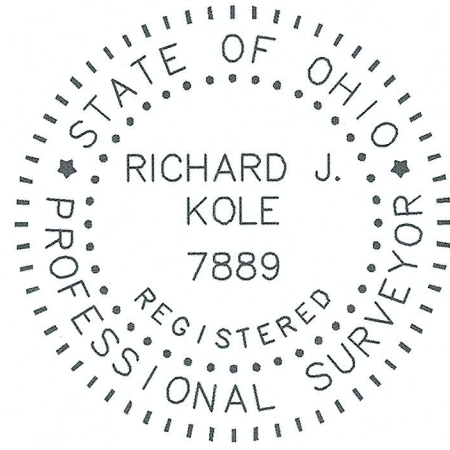

Dimensions shown hereon are expressed in feet and decimal parts thereof. Monuments were found or set as indicated hereon. Bearings shown are to an assumed meridian and are for the sole purpose of describing the relative angular value between lines, all of which I certify to be correct to the best of my knowledge and belief.

Richard J. Kole 1/18/24
Richard J. Kole, Reg. Surveyor #7889 Date

CENTER RIDGE ROAD 60' (U.S. ROUTE 20)

GREENLAWN DRIVE 60'

MADDOCK ROAD 60'

LOT 28
LOT 33

LOT 33
LOT 34

PARCEL 1
135,895 SQ. FT.
3.1197 ACRES
(including 0.5174 Ac. in R.O.W.)

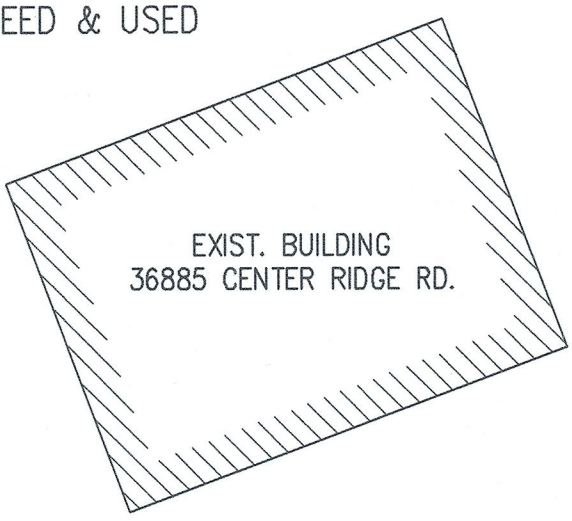

P.P.N. 07-00-028-103-002
WINK BELL, INC.
FILE NO. 2022-0880357
(VACANT)

P.P.N. 07-00-028-103-001
WINK BELL, INC.
FILE NO. 2022-0880351

P.P.N. 07-00-028-103-003
JULIE GREEN and TIMOTHY GREEN
FILE NO. 2017-0643346
7261 MADDOCK RD.

P.P.N. 07-00-028-103-004
MARTIN J. PLAS and CAROL C. PLAS
VOL. 1310, PG. 296
7281 MADDOCK RD.

P.P.N. 07-00-028-103-005
MARIE ANN KJAER, BARBARA ANN SMITH,
BRIAN RICHARD KJAER and KRISTINA DOMOKOS
FILE NO. 2016-0573583

P.P.N. 07-00-027-101-002
JOSEPH J. BUESCHER
FILE NO. 2015-0537201

P.P.N. 07-00-027-101-003
ROBERT TEITENBERG
FILE NO. 2020-0780200

P.P.N. 07-00-027-101-004
JOSEPH BARNES, TIMOTHY BARNES,
KENNETH BARNES and JERRY BARNES
FILE NO. 2003-0913903

P.P.N. 07-00-028-103-107
FILE NO. 2021-0820162
PAULA FOX
36777 CENTER RIDGE RD.

P.P.N. 07-00-027-101-005
FILE NO. 2021-0820162
PAULA FOX
36777 CENTER RIDGE RD.

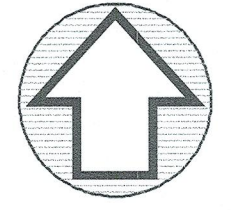

NORTH

GRAPHIC SCALE

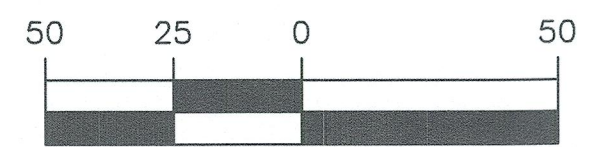

(IN FEET)

1 INCH = 50 FT.

JANUARY 18, 2024

LEGEND:

○	IRON PIN FOUND & USED.
⊗	IRON PIPE FOUND & USED.
⊙	5/8" CAPPED "KOLE #7889" IRON PIN SET (30" LONG)
■	IRON PIN MONUMENT FOUND & USED

51135

APPROVED
LORAIN CO
MAP DEPT

DATE 3/12/2024

PAGE 07-00-024

BY A. Corder
#27-04630

Basis of Bearings:

State Plane Grid North, NAD 83 (2011),
Ohio North Zone. Tied by GNSS to O.D.O.T. VRS.

Prepared by:



5316 Ridge Road - Cleveland, Ohio 44129
Phone 440.885.7137 - Fax 440.885.7139
www.kolesurvey.com
File No. XXXX