

APPROVED
LORAIN CO
MAP DEPT

DATE 11/12/24

PAGE 06-24-056

BY *AP*

24-05230-C

#51106

TOTAL AREA
0.2284 acres (9,949.1917 ft²)

**Retracement Survey for
Guardian Asset Management**

Being a parcel of land located in part of Original Elyria Township Lot Nos. 55 and 56 and part of Sublots 6 and 7, Wm. A. Ely's and Mary E. Pember's Addition, City of Elyria, Township 6 North, Range 17 West, Connecticut Western Reserve, County of Lorain, State of Ohio

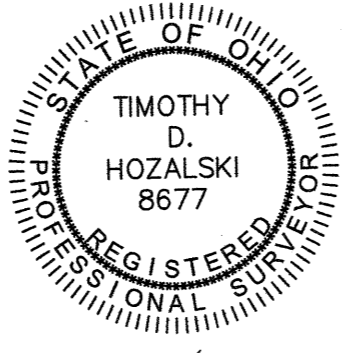

SCALE 1"=60'

BEARINGS ARE RELATIVE TO THE OHIO STATE PLANE COORDINATE SYSTEM, NORTH ZONE (3401), NAD83(2011) EPOCH 2010.00, AND CORRECTED VIA THE ORTN

MINIMUM ERROR OF CLOSURE: 1 : 10,000



OFFICE: 440-865-8445 AMHERST, OH
TIM@VECTORSURVEYING.COM

Job No.	23-100	Drawn By:	CAD
Date:	Nov, 2023	Checked By:	TDH

NOTES

- All iron pins set are 5/8"x30" rebar with yellow plastic caps stamped "HOZALSKI P.S. 8677/ VECTOR SURVEYING", set 5" above ground in areas where future discovery may be difficult, unless otherwise noted. All others set flush with ground, unless otherwise noted.
- Occupation of existing fence lines were used to establish the southwest and southeast boundary corners of the subject property.

REFERENCES

- Lorain County Survey Records**
- Survey for Nina S. McDaniel & Lillian Notkin by J.W. Warden (Apr, 1943)
 - Survey for Blaz & Sons Properties, Ltd. by Vector Surveying Services, LLC (Aug, 2015)
 - Survey for Patricia A. Votino by Seiler & Craig Surveying, Inc. (Apr, 2019)
 - Survey for Rick Thompson by Thomas Simon & Assoc., Inc. (May, 2019)
 - Survey by McSteen Land Surveyors (Aug, 2020)
- Lorain County Recorder's Plat Records**
- Wm. A. Ely's & Mary E. Pember's Addition to Elyria Village (Vol. 3, Pg. 26)(Jul, 1884)
- Lorain County Deed Records**
- Volume and Pages as indicated

LEGEND

SET	FOUND	DESCRIPTION
○	●	IRON PIN/ROD
○	○	SURVEY NAIL
○	○	MAG SPIKE
○	○	DRILL HOLE
○	○	RAILROAD SPIKE
○	○	MONUMENT BOX
○	○	CONCRETE MONUMENT
○	○	IRON PIPE
○	○	STONE
○	○	WOOD POST
---	---	CENTERLINE
---	---	RIGHT-OF-WAY
---	---	SUBLOT LINE
---	---	FENCELINE

ABBREVIATIONS

D	per deed	PC	point of curvature
P	per plat	PI	point of intersection
M	measured	PT	point of tangency
C	calculated	OL	Original Lot
U	used	GL	Great Lot
FND	found	SL	Sublot
CL	centerline	R/W	right-of-way
POB	place of beginning		
PPOB	principal place of beginning		