

**LEGEND:**

- ⊙ = 3/8" REBAR SET WITH I.D. CAP
- ⊗ = PIPE FOUND
- ⊙ = PK NAIL SET
- = PIPE FOUND AND USED
- = IRON PIN/ REBAR FOUND
- ▲ = IRON PIN/ REBAR FOUND AND USED
- = MONUMENT BOX

**APPROVED**  
**LORAIN CO**  
**MAP DEPT**

DATE 6/5/23

PAGE 10-00-006

BY WRZ

23-04705

50907



MARDUN ROAD 40'

GRAFTON ROAD 60'

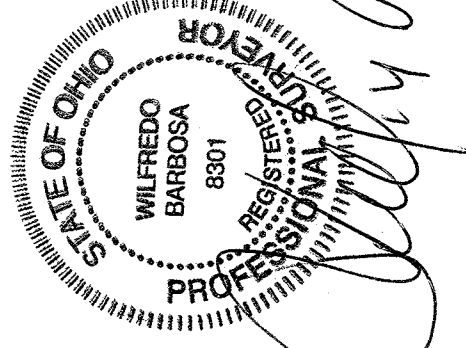

N49°15'57"E 594.19' R

594.14' C 594.19' R

605.92' C 606.04' R

73.94' C 74.07' R

99.04' C 99.10' R

88.94' C 88.98' R

94.32' C 94.24' R

37.94' R 37.61' C

191.19' C 191.74' D

104.04' R 103.91' C

76.97' R 76.88' C

70.11' OB; 70.00' REC

N40°44'36"W 806.01'

CONSOLIDATION = 0.934 OF AN ACRE

0.72' SE @ 90°

19.73' OS. C.

66.36' C 66.58' R

17.48' U

20.70' C

191.19' C 191.74' D

104.04' R 103.91' C

839.97' R#U

N88°18'06"W 313.46' C

Parcel #: 1000006101014  
 CARLISLE TOWNSHIP BOARD OF TRUSTEES  
 1959 GRAFTON RD ELYRIA, OH 44035  
 INSTRUMENT NO. 2006-0121226

Parcel #: 100006101020  
 CARLISLE TOWNSHIP BOARD OF TRUSTEES  
 INSTRUMENT NO. 2006-0121226

SCALE: 1" = 100'

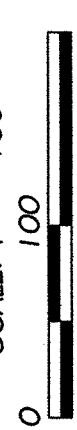

PREPARED AT THE REQUEST OF:  
 Randolph Shephard

**Survey and Consolidation**

of  
**Parcel 10-00-006-101-012 & 10-00-006-101-021**  
**Part of Original Brownhelm Township Sec. 50**  
**Township of Carlisle**  
 COUNTY OF LORAIN STATE OF OHIO

**BARBOSA AND ASSOCIATES LLC**

5604 CASE ROAD  
 NORTH RIDGEVILLE, OH 44039  
 440 327-4776

5/25/2023  
 JOB No: 2023-5-5  
 CHECKED BY: WB  
 SHEET 1 of 1