

GRAPHIC SCALE - FEET

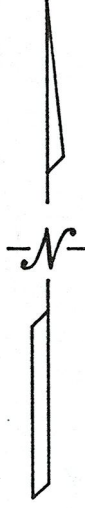

PROSPECT STREET (66')

S 00°00'22"E 285.00' REC.
285.01' M.

I. PIPE
FD. & USED

N 00°00'22"W 150.00'

S/L 196
51.19'

S/L 195
51.05'

N 00°00'22"W 150.00'

S/L 194

S/L 193

COMBINATION
0.4442 ACS.

S/L 192

S 00°00'22"E 150.00'

S/L 191

EXISTING FENCE ALONG SOUTH
PROPERTY LINE PREVENTS
IRON PINS FROM BEING SET AT
PROPERTY CORNERS

HARVARD AVENUE ALLOTMENT
PLAT VOLUME 15 PAGE 26

EASTERN HEIGHTS BLVD. (80')

N 90°00'00"E 642.41' M.
642.35' REC.

N 90°00'00"W 411.17'

N 90°00'00"W 700.38'

DIMENSIONS SHOWN ON THIS PLAT ARE EXPRESSED
IN FEET AND DECIMAL PARTS THEREOF, ALL BEARINGS
ARE TO AN ASSUMED MERIDIAN AND ARE USED TO
INDICATE ANGLES ONLY. PERMANENT MONUMENTS
WERE FOUND OR SET AT ALL POINTS INDICATED
HEREON; ALL OF WHICH I CERTIFY TO BE CORRECT.

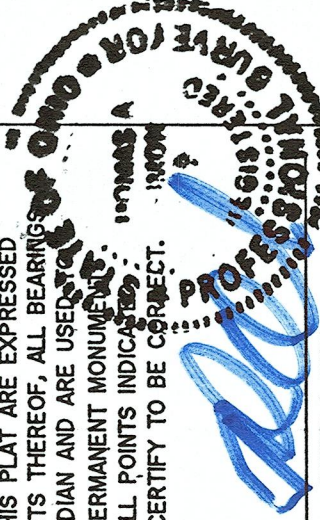

THOMAS A. SIMON
REG. PROFESSIONAL SURVEYOR
NO. S-7775

BASIS OF BEARINGS IS THE SOUTHERLY LINE OF EASTERN HEIGHTS BOULEVARD
(NORTH 90°00'00" WEST).

50894

APPROVED
LORAIN CO
MAP DEPT
DATE 5/18/23
PAGE 66-128
BY A C Menden
#23-04693

I. PIPE FD.
USED N-S
E. 0.25'

S 00°05'41"E 284.55' CALC.

FAIRLAWN AVE. (50')

I. PIPE
FD. & USED

THOMAS SIMON & ASSOCIATES, INC.
PROFESSIONAL LAND SURVEYORS

150 SOUTH OLIVE STREET
ELYRIA, OHIO 44035

(440) 327-2925
FAX 327-2864

PLAT OF BOUNDARY SURVEY
AND COMBINATION FOR

THOMAS & AMANDA STEINDL
BEING KNOWN AS ALL OF SUBLOT NOS. 192 AND 193 AND
PART OF SUBLOT NO. 194 OF EAST BROAD STREET HEIGHTS
AS RECORDED IN PLAT VOLUME 10 PAGE 9
AND PART OF ORIGINAL ELYRIA TOWNSHIP LOT NO. 6
EAST OF THE BLACK RIVER

CITY OF ELYRIA COUNTY OF LORAIN
STATE OF OHIO
MARCH, 2023 SCALE: 1" = 60'

JOB NO. 2023-020