

LEGEND

- FENCE
- LOT LINE
- CENTERLINE
- RIGHT OF WAY
- FINISH FLOOR
- EOP
- EDGE OF PAVEMENT
- PPN
- PERMANENT PARCEL NUMBER
- (M)
- MEASURED
- (R)
- RECORD
- (C)
- CALCULATED
- (U)
- USED
- (D)
- DEED
- (S)
- 5/8" IRON BAR WITH CAP #7503 SET

DATA USED

- TAX MAPS - LORAIN COUNTY GIS
- DEEDS - Doc. No. 2017-0615938
- Doc. No. 2017-0634034
- Doc. No. 2019-0742035
- Doc. No. 2022-0873194
- D.V. 1396 Pg. 747
- PLATS - Street Dedication Plat
- Plat Vol. 42 Pg. 55
- Street Dedication Plat
- Plat Vol. 60 Pg. 71
- Street Dedication Plat
- Plat Vol. 45 Pg. 09

NORTH

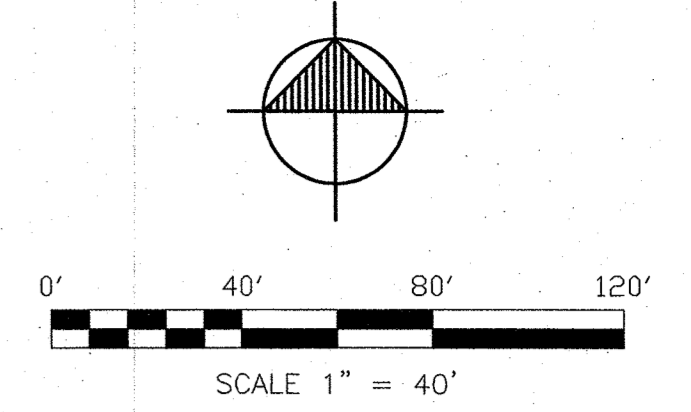

Basis of Bearings
Grid North
Ohio Coordinate System of 1983
North Zone, NAD 1983 (2011),
Referenced to ODOT VRS

LOT SPLIT

Located in the Village of Wellington,
County of Lorain, State of Ohio
Being part of Lot 20,
Wellington Township

OWNER'S ACCEPTANCE

We the undersigned owner/agent of the land shown on this plat, have caused the same to be surveyed and platted and acknowledge this to be our free act and deed.

Amy J. Sword *Amy J. Sword*
Owner/Agent Print/Title

County of Lorain
State of Ohio

Before me a Notary Public in and for said County and State, personally appeared the above named owner/agent who acknowledged that they did sign the foregoing instrument and the same was their free act and deed.

in witness whereof I have hereunto set my hand and official seal

At Wellington Ohio this 6 Day of JANUARY 2023

Charles E. Schilly
Notary Public

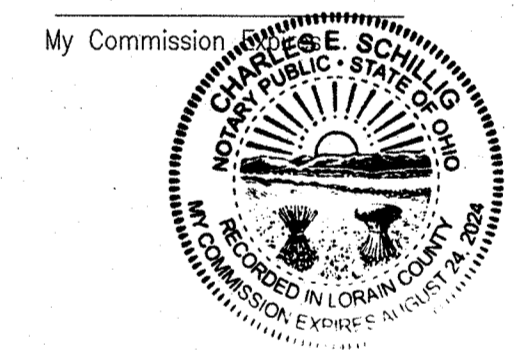

Industrial Avenue - 60'

Shiloh Avenue - 60'

State Route 58

Maple Street - 66'



S.W. Corner
Lot 20
Mon. Box Fd.
Shot Center (Used)

S88°55'46"E
2089.78' (M)

P.O.B.
S.E. Corner
Lot 20

5/8" Iron Bar Fd.
(Used)

Approved by the Village of Wellington,
Lorain County, Planning Commission, no
plat required.

Thomas J. King Jr.
Chairman, Planning Commission
Village of Wellington, Ohio

I hereby certify this survey to be correct to the best of my knowledge and that this plat is based on a field survey prepared under my supervision. Distance are shown in feet and decimal parts there of.

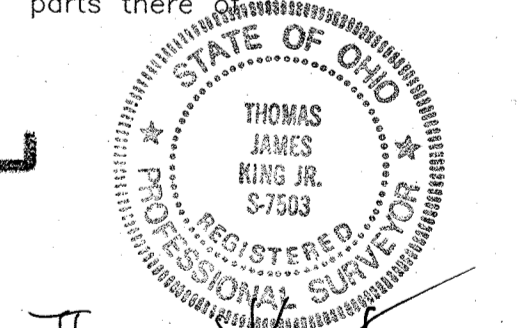

Thomas J. King Jr. 8/21/2022
Thomas J. King Jr. P.S. #7503 Date of Survey

ALBER & RICE
CIVIL + STRUCTURAL + SURVEY
31813 Cook Road | North Ridgeville | Ohio | 44039
216-252-7840 Office 216-252-7841 Fax

PROJECT
Wellington Sword

ADDRESS
311 Maple Street
Wellington, OH 44090

REVISION	DATE
Preliminary Issue	10-10-22
Misc. Revisions	11-12-22

PROJECT NO. 2208-13

SHEET NO. 1 of 1