

PARCELS A, B & C
 1.2544 acres
 54,642.06 sq. ft.
 0.0947 acres in R/W
 4,125.00 sq. ft. in R/W

PARCEL D
 6.2313 acres
 271,433.28 sq. ft.
 0.0975 acres in R/W
 4,247.83 sq. ft. in R/W

**NORTH RIDGE ROAD
 (COUNTY ROAD 1)
 (66' R/W)**

NORTH QUARRY ROAD
 (COUNTY ROAD 30)
 (60' R/W)

S89°22'45"W
 227.78'(C)
 237.72'(SR)

N85°02'33"W
 121.32'(SR)

1" 8" 1" 271.47'(SR)

P.O.C.

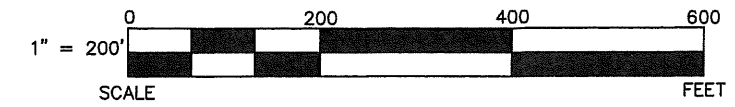

LEGEND

SET FOUND	DESCRIPTION
⊗	MONUMENT
⊕	RAILROAD SPIKE
⊙	P.K. NAIL
○	IRON PIPE
⊖	DRILL HOLE
⊗	5/8"Øx30" IRON ROD
⬢	IRON ROD
■	FENCE POST
▲	STONE
□	MONUMENT BOX
D	DEED
P	PLAT
M	MEASURED
C	CALCULATED
∅	OUTSIDE DIAMETER
SR	SURVEY RECORD



REFERENCES

DEED VOLUMES AND PAGES AS SHOWN
 LORAIN COUNTY ROAD RECORDS
 SURVEY FOR WESTWOOD ESTATES MHC, LLC DATED 11/11/19
 SURVEY FOR FABRIZIO DATED AUGUST, 2008
 SURVEY FOR BRAYLEY DATED FEBRUARY 20, 1995
 PLAT VOLUME 36, PAGE 5

THIS SURVEY DOES NOT INCLUDE A TITLE SEARCH. ALL EASEMENTS OR OTHER ENCUMBRANCES ON OR OVER THE LAND ARE NOT SHOWN ON THIS SURVEY. PLEASE FURNISH ALL INFORMATION IF THESE ARE REQUIRED ON THIS PLAT. ALL FOUND SURVEY MONUMENTS WERE AT GRADE OR PAVEMENT SURFACE AND IN GOOD CONDITION, UNLESS OTHERWISE NOTED.

I HEREBY DECLARE THAT I HAVE SURVEYED THE ABOVE DESCRIBED PROPERTY DURING SEPTEMBER, 2022 AS PER LEGAL DESCRIPTION FURNISHED TO ME. THIS SURVEY IS SUBJECT TO ALL LEGAL HIGHWAYS, EASEMENTS, RESTRICTIONS, LEASES OF RECORD AND OF RECORDS IN RESPECTIVE UTILITY OFFICES. THE BEARINGS REFERRED TO HEREON ARE BASED ON THE OHIO NORTH STATE PLANE COORDINATE SYSTEM.

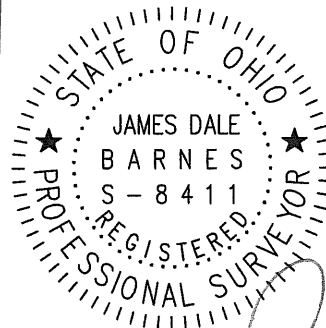

James Dale Barnes 9/5/22
 JAMES DALE BARNES, P.S. 8411 DATE

GARY DEIDRICK et al
 RN 20120437112

PEGGY JEAN MARTY
 RN 20170636212

KNITE DEVELOPMENT LLC
 RN 20220886060
 PARCEL # 0500097103008

NEW DEAL & LAURA OWENS
 RN 19970471722

DEREK R, DANIEL G & MELANIE A WALKUSH
 RN 20110381352

RICHARD & CAROL J WALKUSH
 DV 1347, Pg 427

RICHARD A & CAROL J WALKUSH
 DR 55, Pg 296

MICHAEL & JOANN PRICE
 RN 20180678386

Survey #50712

APPROVED
 LORAIN CO.
 MAP DEPT

DATE 10-12-22

PAGE 05-00-097

BY *D. Adelsberg*

05-00-097-103-008

SURVEY FOR: KNITE DEVELOPMENT, LLC

BARNES SURVEYING
 10312 MASON ROAD, CASTALIA, OHIO 44824-9218
 OFFICE: (419) 684-7742 CELL: (419) 871-1780

SITUATED IN ORIGINAL LOT 97 OF AMHERST TOWNSHIP, LORAIN COUNTY, OHIO