

ESTHER DR. 60'

N6°06'01"E 919.55'

29.54' REC
J.W. WARDEN 1964
29.37' CALC.

Parcel #: 1000015114007
MULDER DANA C & ZAKRAJSEK CHRISTINE R
INSTRUMENT NO. 2012-0414943
PARCEL 1

Parcel #: 1000015114026
PAYNE FLOYD K & PAYNE MELANIE L
INSTRUMENT NO. 2019-0712407

Parcel #: 1000015114024
ROSS DENISE R TRUSTEE
INSTRUMENT NO. 2012-0399685

Parcel #: 1000015114033
MULDER DANA C & ZAKRAJSEK CHRISTINE R
INSTRUMENT NO. 2012-0414943
PARCEL 2
0.3534 ACRES CALCULATED

Parcel #: 1000015114032
MUNOZ SUSAN MARIE
INSTRUMENT NO. 2017-0645077

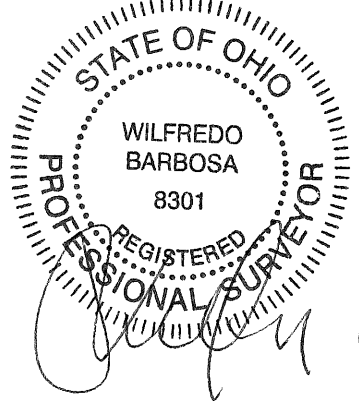

ROBSON ROAD 45'

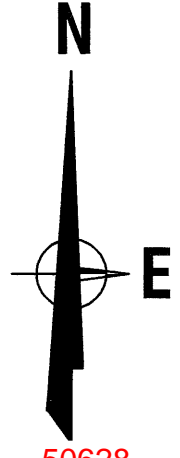

Survey # 50628

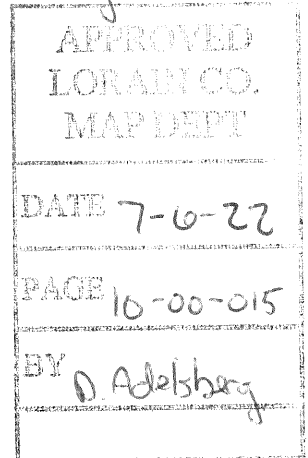

10-00-015-114-033

N6°22'37"E
82.45' REC & OBS.
N06°22'37"E
82.90' R. & OBS.

N81°09'00"W 227.28' R&U

78.81' R&U
N05°30'19"E

N88°48'13"W 228.80' CALC
228.14' REC

N83°53'38"E 234.20 R&U

71.37
110.00' REC
110.2' + OBS.

BARBOSA AND ASSOCIATES LLC
5604 CASE ROAD
NORTH RIDGEVILLE, OH 44039
440 327-4776

PREPARED AT THE REQUEST OF:
CHRISTINE ZAKRAJSEK

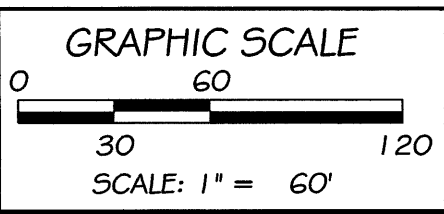

SURVEY- BOUNDARY UPDATE
PARCEL 10-00-015-114-033
TOWNSHIP OF CARLISLE COUNTY OF LORAIN
STATE OF OHIO

June 19, 2022

JOB No: 2022-5-7

- LEGEND:
- ⊙ = PK NAIL FOUND
 - ⊕ = 3/8" REBAR SET WITH I.D. CAP
 - = PIPE FOUND
 - = PIPE USED
 - ▲ = IRON PIN/ REBAR FOUND
 - △ = IRON PIN/ REBAR FOUND AND USED
 - = MONUMENT BOX
 - = STEEL POST
 - R, REC = RECORD U= USED
 - C, CALC = CALCULATED T.M. = TAX MAP
 - OBS = OBSERVED CL = CENTERLINE