

**LEGEND**

SET FOUND DESCRIPTION

- ● IRON PIN/ROD
- ◇ ◆ SURVEY NAIL
- ⊗ ⊙ MAG SPIKE
- ⊗ ⊙ DRILL HOLE
- ⊕ ⊖ RAILROAD SPIKE
- ⊠ □ MONUMENT BOX
- ⊙ ○ CONCRETE MONUMENT
- ○ IRON PIPE
- ▲ ▲ STONE
- ■ WOOD POST

**ABBREVIATIONS**

- (D) PER DEED (M) MEASURED (P) PER PLAT
- (C) CALCULATED (WS) PER WARDEN SURVEY
- (NS) PER NELSON SURVEY
- (KS) PER KS ASSOCIATES SURVEY

ALL IRON PINS SET ARE 5/8"x30" REBAR WITH YELLOW PLASTIC CAPS STAMPED "HOZALSKI P.S. 8677/ VECTOR SURVEYING"  
ALL DRILL HOLES ARE 1/2" IN DIAMETER

**Retracement Survey for Frank Root, Jr.**

Being a parcel of land located in part of Original Sections 1 & 2 of Avon Township, City of Avon, Twp 7 North, Range 16 West, Connecticut Western Reserve, Lorain County, Ohio

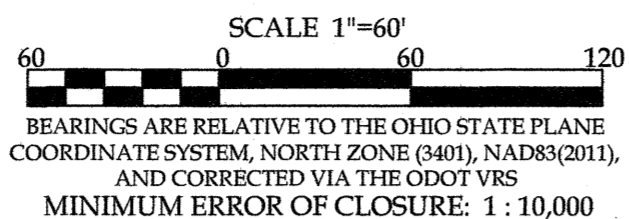

**REFERENCES**

Lorain County Survey Records  
Survey by J.W. Warden (Nov, 1959)  
Survey by Arnold F. Koepf (Jan, 1982)  
Survey by Giles Nelson & Assoc. (May, 1999)  
Survey by KS Associates (Aug, 2003)

Lorain County Deed Records  
Volume and Pages as indicated



OFFICE: 440-865-8445  
VECTORSURVEYING@YAHOO.COM  
Job No. 15-009 Drawn By: CAD  
Date: Aug, 2015 Checked By: TDH

**AREA BREAKDOWN**

Parcel 1 Total: 1.7859 acres  
within R/W: 0.0886 ac. (3,861.4580 ft<sup>2</sup>)

Parcel 2 Total: 2.5547 acres  
within R/W: 0.0559 ac. (2,433.5651 ft<sup>2</sup>)

Parcel 3 Total: 0.9166 ac. (39,925.0197 ft<sup>2</sup>)  
within R/W: 0.1174 ac. (5,112.8007 ft<sup>2</sup>)

**C/L DETROIT RD. (R/W VARIES)**  
1297.20'(C)  
N53° 54' 12"E

**C/L CASE RD. (R/W VARIES)**

File Name: C:\Users\Vector Surveying\Documents\Surveying files\Surveys\2015\15-009-Frank Root-39017 Detroit Rd Retracement\15-009.dwg

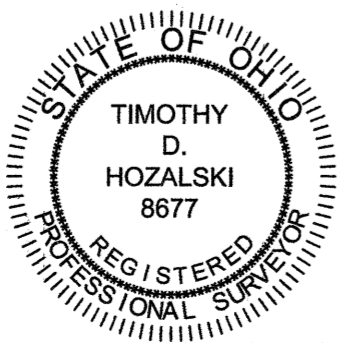

*Timothy D. Hozalski*  
8-6-2015



1/2" IRON PIN FND & USED DOWN 1"

236.47'(M) 236.53'(NS) 236.00'(D)  
N86° 23' 42"E

1/2" IRON PIN FND & USED DOWN 3"

444.61'(M) 444.45'(D & WS)  
S34° 48' 18"W

KB Compost Services, Inc.  
Instrument # 2009-0280377  
Parcel #: 04-00-001-103-298

Michael W. & Sherry D. Stockard  
Instrument # 2001-0737053  
Parcel #: 04-00-001-103-131

Survey # 50624

APPROVED	
LORAIN CO. MAP DEPT	
DATE	7/1/22
PAGE	04-00-001
BY	D. Adelsberg

04-00-001-103-073

William D. Biggs  
Instrument # 2001-0751517  
Parcel #: 04-00-002-103-058

Troy & Zachary Zoltai  
Instrument # 2010-0346915  
Parcel #: 04-00-002-103-057

PARCEL 1  
Frank A. Root & Ruth Ann Root  
Instrument # 2012-0432839  
Parcel #: 04-00-001-103-073

PARCEL 2  
Frank A. Root, Jr.  
Instrument # 2009-0287204  
Parcel #: 04-00-001-103-078

James W. Thomson  
Instrument # 2003-0954095  
Instrument # 2008-0276138  
Parcel #: 04-00-001-103-072

PARCEL 3  
Frank A. Root III & Frank A. Root, Jr.  
Instrument # 2005-0081971  
Parcel #: 04-00-001-103-071

PARCEL 1  
P.P.O.B.

PARCEL 2  
P.P.O.B.

P.O.B.  
3/4" IRON PIN FOUND IN MONUMENT BOX

1" IRON PIPE FND & USED  
S41° 58' 51"E 29.64' FROM CORNER  
DOWN 7"

5/8" IRON PIN  
SET N41° 20' 33"W 1.00'  
FROM CORNER

5/8" IRON PIN  
SET N13° 11' 59"W 1.00'  
FROM CORNER

5/8" IRON PIN  
SET S13° 11' 59"E 1.00'  
FROM CORNER

1/2" IRON PIPE  
FND & USED  
FLUSH W/ GROUND

3/4" IRON PIPE  
FND & USED  
FLUSH W/ GROUND

3/4" IRON PIPE FND & USED FOR LINE  
FLUSH W/ GROUND

3/4" IRON PIPE FND & USED  
DOWN 4"

5/8" IRON PIN  
FND & USED  
DOWN 4"

5/8" IRON PIN FND & USED FOR LINE  
N86° 22' 41"E 0.09' FROM CORNER  
DOWN 2"

3/4" IRON PIPE FND & USED  
UP 4"

