

APPROVED
LORAIN CO.
MAP DEPT
DATE 4/14/22
PAGE 19-00-007
BY WRZ
22-04462
50551

DIMENSIONS SHOWN ON THIS PLAT ARE EXPRESSED IN FEET AND DECIMAL PARTS THEREOF, ALL BEARINGS ARE TO AN ASSUMED MERIDIAN AND ARE USED TO INDICATE ANGLES ONLY. PERMANENT MONUMENTS WERE FOUND OR SET AT ALL POINTS INDICATED HEREON AND I HEREBY CERTIFY TO BE CORRECT.

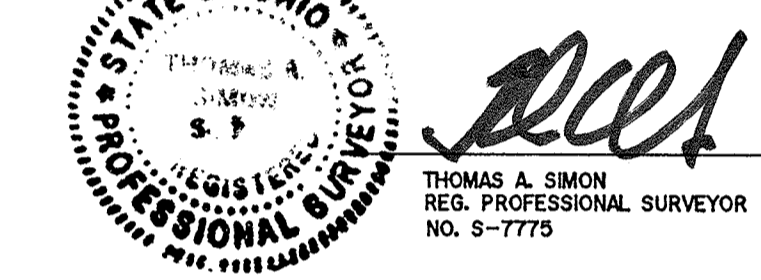

BASIS OF BEARINGS IS THE CENTERLINE OF PECK WADSWORTH ROAD (NORTH 89°55'35" WEST), IRON PINS SET ARE 5/8" DIAMETER, 30" LONG WITH PLASTIC CAPS "T. SIMON, S-7775".

COURSE	BEARING	DISTANCE
L-1	N 89°55'35"W	208.50'
L-2	S 00°04'25"W	208.92'
L-3	N 23°35'35"W	144.99'
L-4	N 89°25'35"W	60.02'
L-5	N 09°25'35"W	192.21'
L-6	N 89°55'35"W	185.09'
L-7	S 03°04'25"W	105.04'
L-8	S 29°55'35"E	275.00'

- ① 18-00-006-000-047
JAMES A. KIMMEL
DOC. #20210812007
4/12/21
- ② 18-00-006-000-045
RICHARD SUGASKI
DOC. #2000697288
7/28/2000
- ③ 18-00-006-000-004
W.L. & B.L. MCGINTY
DOC. #20210848380
11/4/21
- ④ 18-00-006-000-009
D.L. SUGASKI
ORV 377 PG 938
3/15/91

THOMAS SIMON & ASSOCIATES, INC.
PROFESSIONAL LAND SURVEYORS
150 SOUTH OLIVE STREET
ELYRIA, OHIO 44035
(440) 327-2925
FAX 327-2964

PLAT OF BOUNDARY SURVEY
AND SPLIT
FOR
LAURA W. KIMMEL
BEING KNOWN AS PARTS OF
ORIGINAL WELLINGTON TOWNSHIP
LOT NOS. 6 AND 7
COUNTY OF LORAIN STATE OF OHIO
MARCH, 2022 SCALE: 1" = 300'