

NOTES

- All iron pins set are 5/8"x30" rebar with yellow plastic caps stamped "HOZALSKI P.S. 8677/ VECTOR SURVEYING", set 5" above ground in areas where future discovery may be difficult, unless otherwise noted. All others set flush with ground, unless otherwise noted.
- All drillholes set are 5/8" in diameter.

ABBREVIATIONS

D	per deed	PC	point of curvature
P	per plat	PI	point of intersection
M	measured	PT	point of tangency
C	calculated	OL	Original Lot
U	used	GL	Great Lot
FND	found	SL	Sublot
CL	centerline	R/W	right-of-way
POB	place of beginning		
PPOB	principal place of beginning		
PS	per Penfound survey		

LEGEND

SET	FOUND	DESCRIPTION
○	●	IRON PIN/ROD
◇	◆	SURVEY NAIL
⊙	⊚	MAG SPIKE
⊗	⊘	DRILL HOLE
⊠	⊡	RAILROAD SPIKE
⊞	⊟	MONUMENT BOX
⊞	⊟	CONCRETE MONUMENT
○	○	IRON PIPE
○	○	STONE
■	■	WOOD POST
---	---	CENTERLINE
---	---	RIGHT-OF-WAY
---	---	ORIGINAL LOT LINE
×××	×××	FENCELINE

REFERENCES

Lorain County Survey Records

- Survey for Newton G. Whitmore by Gary E. Penfound (Jan, 1959)
- Survey for Newton G. Whitmore by Gary E. Penfound (Apr-Jul, 1971)
- Survey by Arnold F. Koepp (June, 1973)
- Survey for Larry A. Eshelman by Laundon, Simon, Cahl & Assoc. (Aug, 1991)
- Survey by KS Associates (May, 1999)
- Survey for David Darrah by Vector Surveying (Jan, 2016)
- Survey for Jerry Gerstacker by McGannon Surveying, LLC (Jun, 2016)
- Survey for Linda Kelley by Thomas M. Snezek (Aug, 2020)

Lorain County Deed Records

Volume and Pages as indicated

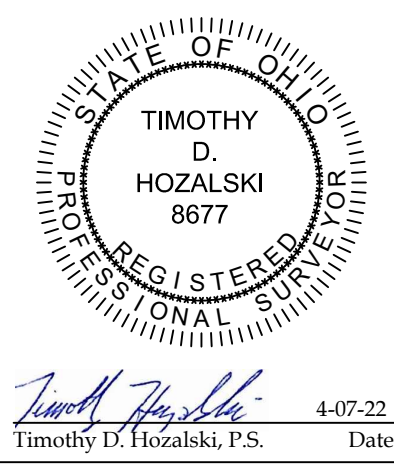

**Retracement for
Walter & Gwen Stokeley**

Being a parcel of land located in part of Original Lot 26, Brownhelm Township, Township 6 North, Range 19 West, Connecticut Western Reserve, County of Lorain, State of Ohio

SCALE 1"=80'

80 0 80 160

BEARINGS ARE RELATIVE TO THE OHIO STATE PLANE COORDINATE SYSTEM, NORTH ZONE (3401), NAD83(2011) EPOCH 2010.00, AND CORRECTED VIA THE ORTN

MINIMUM ERROR OF CLOSURE: 1 : 10,000

VECTOR SURVEYING SERVICES, LLC

OFFICE: 440-865-8445 AMHERST, OH
TIM@VECTORSURVEYING.COM

Job No.	22-014	Drawn By:	CAD
Date:	Apr, 2022	Checked By:	TDH