

2" BRASS CAP
FOUND & USED

BURSLEY ROAD - 60'
(A PUBLIC RIGHT-OF-WAY)

PLAT OF BOUNDARY SURVEY OF 26405 HAWLEY ROAD, WELLINGTON, OHIO KNOWN AS PPN 21-12-000-000-103

SITUATED IN THE TOWNSHIP OF HUNTINGTON, COUNTY OF LORAIN
AND STATE OF OHIO AND KNOWN AS BEING PART OF TRACT
NUMBER 12 OF ORIGINAL HUNTINGTON TOWNSHIP.

BEARINGS BASED ON THE CENTERLINE OF
HAWLEY ROAD, FIRST SECTION SOUTH OF
BURSLEY ROAD (SOUTH 00°26'00" WEST) AS
SHOWN ON THE PLAT OF SURVEY PREPARED
BY J & L ENGINEERING DATED 6-18-1997
AND FILED WITH THE LORAIN COUNTY MAP
DEPARTMENT AS #22709.

HAWLEY ROAD - 60'
(A PUBLIC RIGHT-OF-WAY)

P.O.B.

S 00°26'00" W
(BASIS OF BEARINGS)
1852.23'(R)

5/8" IPF & USED
ANGLE POINT

S 00°58'38" W
910.68'(R)

30.00' OFF CL
ANGLE POINT

350.16'(C), 350.00'(R)

5/8" IPF & USED
ONLINE @ 30.06'
"WELLERT"

30.00'(R)

S 00°51'46" W 835.70'(C)

S 00°51'46" E 485.71'(C), 485.95'(R)

N 00°51'46" E 485.71'(C), 485.95'(R)

N 00°51'46" E 485.71'(C), 485.95'(R)

N 00°51'46" E 485.71'(C), 485.95'(R)

N 00°51'46" E 485.71'(C), 485.95'(R)

N 00°51'46" E 485.71'(C), 485.95'(R)

N 00°51'46" E 485.71'(C), 485.95'(R)

N 00°51'46" E 485.71'(C), 485.95'(R)

N 00°51'46" E 485.71'(C), 485.95'(R)

N 00°51'46" E 485.71'(C), 485.95'(R)

N 00°51'46" E 485.71'(C), 485.95'(R)

N 00°51'46" E 485.71'(C), 485.95'(R)

N 00°51'46" E 485.71'(C), 485.95'(R)

N 00°51'46" E 485.71'(C), 485.95'(R)

N 00°51'46" E 485.71'(C), 485.95'(R)

N 00°51'46" E 485.71'(C), 485.95'(R)

N 00°51'46" E 485.71'(C), 485.95'(R)

N 00°51'46" E 485.71'(C), 485.95'(R)

N 00°51'46" E 485.71'(C), 485.95'(R)

N 00°51'46" E 485.71'(C), 485.95'(R)

N 00°51'46" E 485.71'(C), 485.95'(R)

N 00°51'46" E 485.71'(C), 485.95'(R)

N 00°51'46" E 485.71'(C), 485.95'(R)

N 00°51'46" E 485.71'(C), 485.95'(R)

N 00°51'46" E 485.71'(C), 485.95'(R)

N 00°51'46" E 485.71'(C), 485.95'(R)

N 00°51'46" E 485.71'(C), 485.95'(R)

N 00°51'46" E 485.71'(C), 485.95'(R)

N 00°51'46" E 485.71'(C), 485.95'(R)

N 00°51'46" E 485.71'(C), 485.95'(R)

N 00°51'46" E 485.71'(C), 485.95'(R)

N 00°51'46" E 485.71'(C), 485.95'(R)

S 88°56'46" E 1153.17'(C), 1153.22'(R)

1123.17'(C)

5/8" IPF & USED
"WELLERT"

170.4'

BARN

304.1'

POND

490.6'

166.2'

651.75'(C)

5/8" IPF & USED
"WELLERT"

681.43'(R-ADJACENT DEED), 681.59'(R-SUBJECT DEED)
N 88°52'11" W 681.75'(C)

472.23'(R-SUBJECT DEED), 472.73'(R-ADJACENT DEED)
N 89°25'24" W 472.39'(C)

N 89°25'24" W
190.01'(R)

PPN 21-12-000-000-077
DANNY FRANKLIN
INST. NO. 2016-0610982
"PARCEL 1"

APPROVED
LORAIN CO.
MAP DEPT.
3/21/22
21-12-000
Y. S. J. [Signature]
22-04812-A
SCAN # 50533

PPN 21-12-000-000-081
DANIEL DONALD & LINDA
MARIE WASIL
INST. NO. 1999-0602485

GRAPHIC SCALE

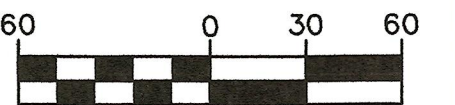

(IN FEET)
1 INCH = 60 FEET

● - 5/8" BY 30" IRON PIN SET AND CAPPED "CASEY PROFESSIONAL SERVICES PS&TIP" - IPS	A. ACRES	PG. PAGE
○ - MONUMENT BOX FOUND	AFN AUDITOR'S FILE NUMBER	P.P.N. PERMANENT PARCEL
○ - IRON PIN (IPF)/PIPE (PIPF) FOUND	CL CENTERLINE	NUMBER
○ - DRILL HOLE SET - DHS	C.L.F. CHAIN LINK FENCE	R/W RIGHT-OF-WAY
○ - MAG NAIL SET - MNS	CLRS CLEARS	S SOUTH
(R) RECORD	E EAST	S.F. SQUARE FEET
(C) CALCULATED	ENCRS. ENCROACHES	VOL. VOLUME
(M) MEASURED	L.C.R. LORAIN COUNTY RECORDS	W. WEST
(U) USED	N NORTH	

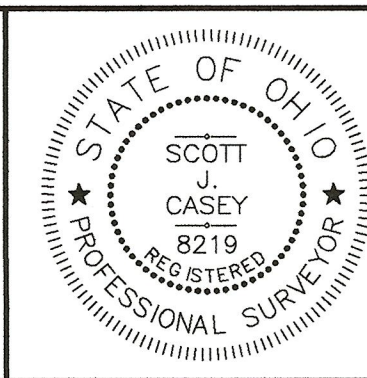

I HEREBY CERTIFY THAT THE BOUNDARIES SHOWN
HEREON ARE THE RESULT OF A SURVEY DONE BY
MYSELF ON MARCH 8TH OF 2022. THIS
BOUNDARY RETRACEMENT SURVEY IS IN
ACCORDANCE WITH THE OHIO ADMINISTRATIVE
CODE CHAPTER 4733.37.
3/9/2022
SCOTT J. CASEY 8219

Casey Professional Services, LLC
1159 Holden Avenue, Cleveland, OH 44109
216-781-1644 office & fax; 216-299-9555 mobile
www.caseyps.com

JOB NO.	22029
SCALE:	1"=60'
DRAWN BY:	SJC
FIELD WORK DATE:	3/8/22

60D NAIL
FOUND & USED
CL S.R. 162 - 60'R/W