

SCALE: 1" = 60'
DATE: AUGUST, 2021

BASIS OF BEARING

Center Line Dye Road
Lorain County Survey Record N 89°53'17" W

SURVEY REFERENCES

Lot Split Map of Parcel No. 11-00-029-000-054 # 50190
Lot Split Map of Parcel No. 11-00-029-000-047 # 50143
Plat of Survey & Lot Split Map for Richard & Cheryl Murphy # 47295

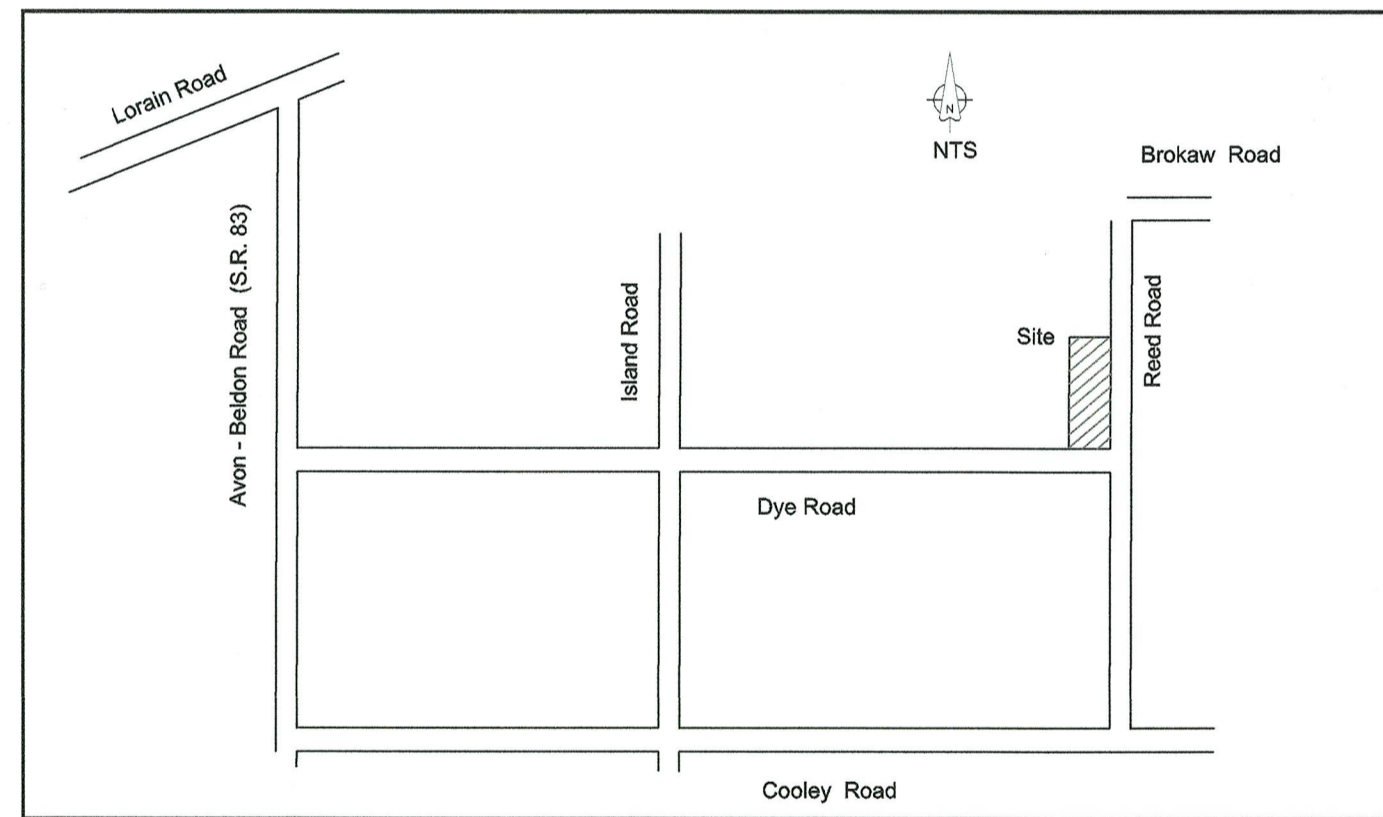

Vicinity Map

Parcel No. 11-00-0229-000-039
Joseph G. & Pauletta C. Stanslawski
Instr. No. 1975-0994722

Parcel No. 11-00-0229-000-058
The Dale R. Sandvick Trust
Instr. No. 2021-0804902

Parcel No. 11-00-029-000-057
Richard A. & Lindsay T. Gorski
Instr. No. 2021-0812547

PARCEL A
TOTAL AREA
220992.1 Sq. Feet
5.0733 Acres

AREA IN R/W
26174.0 Sq. Feet
0.6009 Acres

PARCEL B
TOTAL AREA
87120.8 Sq. Feet
2.0000 Acres

AREA IN R/W
7993.5 Sq. Feet
0.1835 Acres

**PLAT OF LOT SPLIT
PREPARED FOR
GORSKI**

SITUATED IN THE TOWNSHIP OF EATON, COUNTY OF LORAIN AND STATE OF OHIO; AND KNOWN AS BEING PART OF ORIGINAL EATON TOWNSHIP LOT NO. 29 AND LOT D IN THE LOT SPLIT MAP OF PARCEL NO. 11-00-029-000-054 AS SHOWN BY LORAIN COUNTY SURVEY RECORDS.

LEGEND

- IPCF = Iron Pin Cap Found
- IPMF = Iron Pin Monument Found
- IPCS = Iron Pin Cap Set
- IPF = Iron Pin Found
- ⊗ DHS = Drill Hole Set

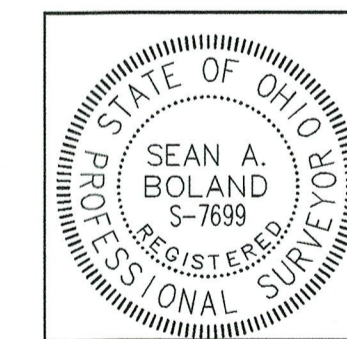

CERTIFICATION

THIS PLAT WAS PREPARED FROM A FIELD SURVEY, ANALYSIS OF RECORDED DEEDS AND LORAIN COUNTY RECORDS, BEARINGS SHOWN HEREON ARE CALCULATED FROM DEED AND SURVEY RECORD, DISTANCES ARE GIVEN IN FEET AND DECIMAL PARTS THEREOF. ALL OF WHICH I BELIEVE TO BE CORRECT.

Sean A. Boland

SEAN A. BOLAND, P.S.
REGISTERED OHIO PROFESSIONAL
SURVEYOR NO. 7699
Boland Land Surveying LLC
bolandsurveying@gmail.com
440-785-2943

505.07
APPROVED
LORAIN CO.
MAP DEPT
DATE 7/14/22
PAGE 11-00-029
BY A. Carden
22-04435

ISLAND ROAD 60'
IPMF & used

REED ROAD 60'

DYE ROAD 40'

