

Harvey D. Born Company, Inc.
Deed Volume 1300, Pg. 105
Parcel # 08-00-082-000-027

Survey # 50505

APPROVED
LORAIN CO.
MAP DEPT
DATE 2-1-22
PAGE 08-00-082
BY D. Adelsberg

08-00-082-000-026

Curve Table						
CURVE	RADIUS	DELTA ANGLE	TANGENT	CHORD LENGTH	CHORD BEARING	ARC LENGTH
C1	763.94'(C) 764.49'(DP)	20°08'22"(C) 20°52'(DP)	135.66'(C) 140.77'(DP)	267.14'	S9°56'55"W	268.53'(C) 278.22'(DP)
C2	763.94'	12°17'59"	82.31'	163.68'	S13°52'06"W	164.00'
C3	763.94'	7°50'23"	52.35'	104.45'	N3°47'55"E	104.53'

TOTAL AREA
2.6037 acres (Calculated)
≈2.62 acres (Deed)
0.1715 acres (7,471.0949 ft²) Within R/W
0.0402 acres (1,749.7896 ft²) Within Easement

LEGEND

SET	FOUND	DESCRIPTION
○	●	IRON PIN/ROD
○	○	SURVEY NAIL
○	○	MAG SPIKE
○	○	DRILL HOLE
○	○	RAILROAD SPIKE
○	○	MONUMENT BOX
○	○	CONCRETE MONUMENT
○	○	IRON PIPE
○	○	STONE
○	○	WOOD POST
○	○	CENTERLINE
○	○	RIGHT-OF-WAY
○	○	35'x50' EASEMENT AREA

NOTES

- All iron pins set are 5/8"x30" rebar with yellow plastic caps stamped "HOZALSKI P.S. 8677/ VECTOR SURVEYING", set 5" above ground in areas where future discovery may be difficult, unless otherwise noted. All others set flush with ground, unless otherwise noted.
- The 35'x50' easement shown hereon is a utility easement in which the subject property is the servient tenement per Instrument No. 2021-0852944. The status of the easement at the time of this survey is unknown.

REFERENCES

- Lorain County Survey Records
Survey for L.H. Webber & D.B. Symons (May, 1926)
Dedication Plat of Gore Orphanage Road (Jul, 1930)
Survey by Norman R. Hura & Assoc. (Nov, 1984)
- Lorain County Engineer's Office Records
Field Book Volume 138, Pages 23-29
- Lorain County Deed Records
Volume and Pages as indicated

ABBREVIATIONS

D	per deed	PC	point of curvature
P	per plat	PI	point of intersection
M	measured	PT	point of tangency
C	calculated	OL	Original Lot
U	used	GL	Great Lot
FND	found	SL	Sublot
CL	centerline	R/W	right-of-way
POB	place of beginning		
PPOB	principal place of beginning		
FB	per LCE County Field Book		
DP	per Dedication Plat		

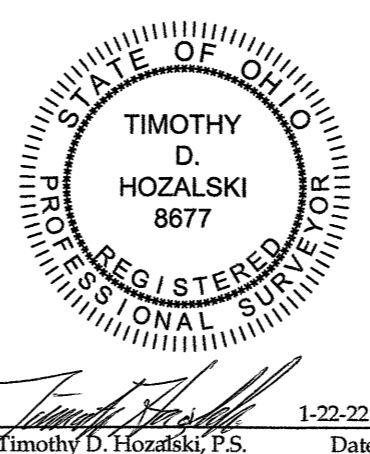

Retracement for Adam & Sarah McCann
Being a parcel of land located in part of Original Lot 82, Henrietta Township, Township 5 North, Range 19 West, Connecticut Western Reserve, County of Lorain, State of Ohio
SCALE 1"=100'
BEARINGS ARE RELATIVE TO THE OHIO STATE PLANE COORDINATE SYSTEM, NORTH ZONE (3401), NAD83(2011) EPOCH 2010.00, AND CORRECTED VIA THE ORTN MINIMUM ERROR OF CLOSURE: 1 : 10,000

VECTOR SURVEYING SERVICES, LLC
OFFICE: 440-865-8445 AMHERST, OH
TIM@VECTORSURVEYING.COM
Job No. 21-106 Drawn By: CAD
Date: Jan, 2022 Checked By: TDH