

BOUNDARY SURVEY
FOR
1114 GULF ROAD
R/W AS BEING PART OF GENEVA, ELGIN TOWNSHIP LOT
NO. 173, EAST OF THE BLACK RIVER
CITY OF ELVIRA
COUNTY OF LOHMAN - STATE OF OHIO

McSteen
LAND SURVEYORS
1415 East 26th Street, Wickliffe, OH 44092
Phone: 330.953.9500 www.mcsteen.com

THIS SURVEY IS A BOUNDARY SURVEY PREPARED IN ACCORDANCE WITH CHAPTER 4713.17 OF THE OHIO REVISIONS TO THE SURVEYING CODE. DISTANCES ARE GIVEN IN FEET AND DECIMAL FRACTIONS THEREOF. STATIONED "WESTERN" IS 102231'.

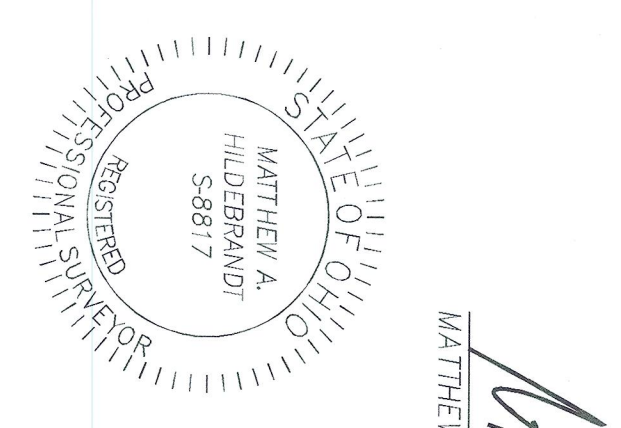

Matthew A. Hildebrandt
REG. PROF. SURVY. NO. 6817
JOB NO.: 21-219
FIELD DATE: SEPTEMBER 20, 2021
SURVEY DATE: SEPTEMBER 20, 2021
DRAWN BY: HHS
DATE: 04-25-22
BY: H. Gorden
E: 03946

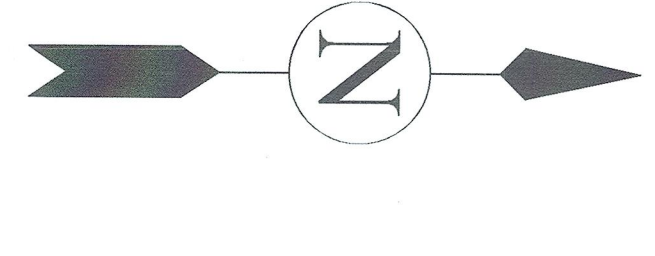
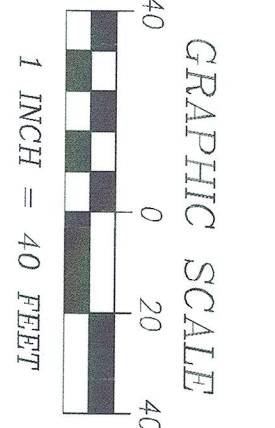

LINE	BEARING	DISTANCE
L1	S 21°31'28" W	78.87' CALC. & USED
L2	S 89°42'53" W	182.29' CALC. & USED
L3	N 0°06'51" E	57.91' OBS. & USED
L4	N 78°27'48" E	76.69' OBS. & USED
L5	N 88°23'28" E	141.33' CALC. & USED
L6	S 88°19'28" W	32.72' REC. & USED
L7	S 87°42'28" W	172.43' CALC. & USED
L8	S 33°50'11" W	31.11' REC. & USED

LEGEND

- NEAR POINT AS NOTED
- 5/8" DIAMETER X 3/4" LONG IRON PIN PLACED ON SURFACE OF POINT
- 1" IRON PIPE (SEE SCALE)
- CONCRETE
- R/W - RIGHT-OF-WAY
- CALC. - CALCULATED DISTANCE OR ANGLE
- OBS. - OBSERVED DISTANCE OR ANGLE
- F.S. - FOUND
- L.C.M. - LOCAL COUNTY MAP RECORDS
- D.O.D. - DEPARTMENT OF TRANSPORTATION
- CONCRETE
- ASPHALT
- WOOD FENCE

BASE OF BEARING
BEARING ARE BASED ON THE OHIO STATE PLANE COORDINATE SYSTEM, NAD 83, ZONE 17N, DATUM OF 1983, AS DERIVED FROM THE NATIONAL BUREAU OF SURVEYING (NBS) DATA. THE SURVEYOR HAS VERIFIED THE ACCURACY OF THE COORDINATE DATA.

SURVEY REFERENCES

- SECTION OF GULF ROAD ACQUIRED BY KAYDON, SIMON, CHIL, & ASSOCIATES, INC., DATED MARCH 1920.
- RECORDS OF GULF ROAD ACQUIRED BY KAYDON, SIMON, CHIL, & ASSOCIATES, INC., DATED MARCH 1920.
- RECORDS OF GULF ROAD ACQUIRED BY KAYDON, SIMON, CHIL, & ASSOCIATES, INC., DATED MARCH 1920.
- RECORDS OF GULF ROAD ACQUIRED BY KAYDON, SIMON, CHIL, & ASSOCIATES, INC., DATED MARCH 1920.
- RECORDS OF GULF ROAD ACQUIRED BY KAYDON, SIMON, CHIL, & ASSOCIATES, INC., DATED MARCH 1920.
- RECORDS OF GULF ROAD ACQUIRED BY KAYDON, SIMON, CHIL, & ASSOCIATES, INC., DATED MARCH 1920.
- RECORDS OF GULF ROAD ACQUIRED BY KAYDON, SIMON, CHIL, & ASSOCIATES, INC., DATED MARCH 1920.
- RECORDS OF GULF ROAD ACQUIRED BY KAYDON, SIMON, CHIL, & ASSOCIATES, INC., DATED MARCH 1920.
- RECORDS OF GULF ROAD ACQUIRED BY KAYDON, SIMON, CHIL, & ASSOCIATES, INC., DATED MARCH 1920.
- RECORDS OF GULF ROAD ACQUIRED BY KAYDON, SIMON, CHIL, & ASSOCIATES, INC., DATED MARCH 1920.

SHOWPOINT OBSERVATIONS

- ▲ A WOOD FENCE CROSSES THE NORTHERLY LINE OF SURVEYED PROPERTY.
- ▲ A WOOD FENCE CROSSES THE SOUTHERLY LINE OF SURVEYED PROPERTY.

