



ORIGINAL LOT 16

ORIGINAL LOT 17

N89°24'25" E
347.00'

30.00'
**PARTITION = 1.386 ACRES
FROM 11-00-004-000-001**

N89°24'25" E
347.00'

N0°26'32" E
174.00'
N0°26'32" E
238.08'

N0°26'32" E
174.00'

EXISTING POND

50' MIN.

30.00' EX. GAR.

10' MIN. EX. BARN

EX. HOUSE

EX. BARN

N89°24'25" E
2664.21' OBS.

N89°24'25" E
2317.21' CALC.

EATON TWP ORIGINAL LOT 5
EATON TWP ORIGINAL LOT 4

Parcel # 11-00-004-000-001
PHILLIP J & BARBARA K
WILLIAMSON
12509 COWLEY RD COLUMBIA
STATION, OH 44028
INSTRUMENT NO. 2001-0753934
APROXIMATELY 25 ACRES DEED
25.181 CALCULATED

**REMAINDER = 23.795 ACRES
FROM 11-00-004-000-001**

N0°49'42" E
411.96' CALC.

EATON TWP.
COLUMBIA TWP.

N89°24'11" E 2661.44' CALC.

Parcel # 11-00-004-000-002
DANIEL R COSSEL & JOHN SCOSSEL
COWLEY RD COLUMBIA STATION, OH 44028
INSTRUMENT NO. 2016-0612075
22.64 ACRES DEED AND CALCULATED

N0°49'42" E 2459.80' REC. 2459.77' CALC.

EATON TWP.
COLUMBIA TWP.

CAPEL ROAD

CAPEL RD.

11-00-004-000-016, 017

N0°26'32" E
2428.40' REC. AND USED

COWLEY ROAD 60'

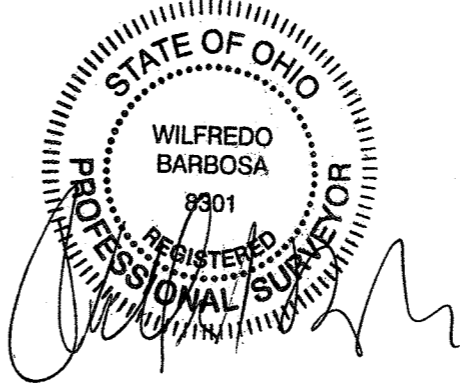
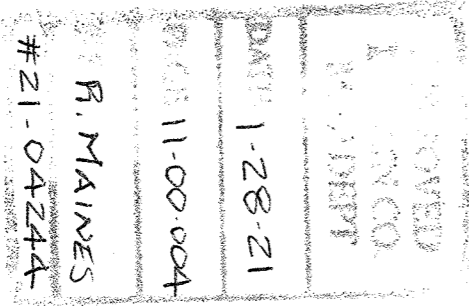

ORIGINAL LOT 17

EATON TWP ORIGINAL LOT 4

CAPEL ROAD 60'

EATON TWP ORIGINAL LOT 4

ORIGINAL LOT 18

ORIGINAL LOT 3

ORIGINAL LOT 3

PROPERTY ADDRESS:
12509 COWLEY ROAD
COLUMBIA STATION, OHIO 44050

BARBOSA AND ASSOCIATES LLC
5604 CASE ROAD
NORTH RIDGEVILLE, OH 44039
440 327-4776

PREPARED AT THE REQUEST OF:
CLAYTON HOMES (HEATHER McCURDY)

10/17/2020
JOB No: 2020-9-3

REVISED 11-3-2020
SHEET 1 of 1

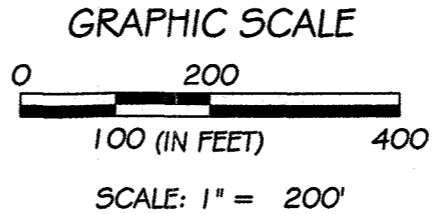

SURVEY- LAND PARTITION
PART OF ORIGINAL EATON TWP LOT 4
TOWNSHIP OF EATON
COUNTY OF LORAIN
STATE OF OHIO

- LEGEND:
- ⊙ = 5/8" REBAR SET WITH I.D. CAP
 - = PIPE FOUND ● = PIPE USED
 - ▲ = IRON PIN/ REBAR FOUND
 - ▲ = IRON PIN/ REBAR FOUND AND USED
 - = MONUMENT BOX ⊙ = SPIKE ⊠ = FENCE POST
 - R, REC = RECORD U= USED
 - C, CALC = CALCULATED T.M. = TAX MAP
 - OBS = OBSERVED CL = CENTERLINE