

# LOT SURVEY

OF  
**PPN: 1000016000051 & 1000016000016**

SITUATED IN THE TOWNSHIP OF CARLISLE, COUNTY OF LORAIN AND STATE OF OHIO;  
AND KNOWN AS BEING PART OF ORIGINAL SECTION No. 16.

APPROVED  
LORAIN CO.  
DEPT

DATE 12-17-20

BOOK 10-00-016

R. MAINES

#20-04459-A

10-00-016-000-016

**SURVEY NOTES:**

1. NO TITLE SEARCH WAS PERFORMED FOR THIS SURVEY, NO EASEMENTS OR ZONING REQUIREMENTS ARE SHOWN HEREON.
2. CONTRACTOR IS RESPONSIBLE TO CONTACT "811" BEFORE ANY SITE IMPROVEMENTS ARE TO BE MADE.

**BASIS OF BEARINGS:**

BEARINGS BASED ON THE OHIO STATE PLANE COORDINATE SYSTEM, NORTH ZONE, ESTABLISHED FROM GPS OBSERVATIONS ON 12/11/2020.

**SURVEY REFERENCES:**

1. RECORDED DEEDS AS NOTED
2. COUNTY TAX MAP SURVEY 24807
3. COUNTY TAX MAP SURVEY 02123-C

**LEGEND:**

- S 5/8" BY 30" IRON PIN WITH CAP "ENGL", TO BE SET
- M FOUND MONUMENTATION AS SHOWN
- R/W RIGHT OF WAY
- P.N. PARCEL NUMBER
- n/f NOW OR FORMALLY OWNER BY
- SQ. FT. SQUARE FEET
- P.R.O. PRESENT ROAD OCCUPIED

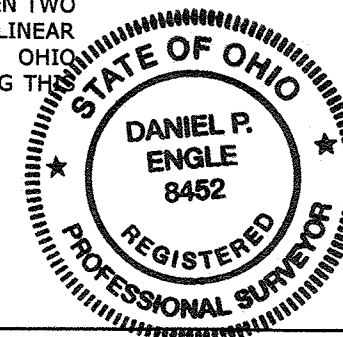

**SURVEYOR'S CERTIFICATION:**

I HEREBY CERTIFY THAT I HAVE PREPARED THIS PLAT AND SURVEY, AND THAT THE SAME IS CORRECT AND ACCURATE. THIS PLAT WAS PREPARED FROM A FIELD SURVEY, ANALYSIS OF RECORDED PLATS, RECORDED DEEDS, AND CITY SURVEY RECORDS, (AS APPLICABLE). BEARINGS ARE BASED ON STATE PLANE, OHIO NORTH, AND ARE SHOWN TO DENOTE ANGLES ONLY. DISTANCES ARE GIVEN IN FEET AND DECIMAL PART THEREOF. THE PLAN REPRESENTS A SURVEY PERFORMED IN SUCH A MANNER THAT THE LINEAR ERROR IN THE DISTANCE BETWEEN TWO (2) POINTS DOES NOT EXCEED THE LIMITS OF ONE (1) FOOT TO TEN THOUSAND (10,000) FEET (ALLOWABLE LINEAR ERROR = REPORTED DISTANCE DIVIDED BY TEN THOUSAND) AS PER SECTION 4733-37 OF THE OHIO ADMINISTRATIVE CODE AND ADJACENT PROPERTY DESCRIPTIONS HAVE BEEN CONSIDERED IN PERFORMING THE SURVEY. ALL OF WHICH I CERTIFY TO BE CORRECT TO THE BEST OF MY KNOWLEDGE.

*[Signature]*  
DANIEL P. ENGLE  
A REGISTERED SURVEYOR IN THE STATE OF OHIO (#8452).  
1789 ABBEVILLE RD VALLEY CITY OH 44280 PH:330.441.2561  
E-MAIL: DANIEL@ENGLESURVEYING.COM

12/14/2020  
DATE:

