

PLAT OF BOUNDARY SURVEY

OF
259 MILLER COURT, ELYRIA, OHIO

KNOWN AS

PARCEL NUMBER 10-00-004-124-037

SITUATED IN THE TOWNSHIP OF CARLISLE, COUNTY OF LORAIN,
STATE OF OHIO AND KNOWN AS BEING A PART OF ORIGINAL
CARLISLE TOWNSHIP SECTION NUMBER 4. BEING ALL THAT LAND
CONVEYED TO RYAN A. MAINS IN INSTRUMENT NUMBER
2017-0650088

APPROVED
LORAIN CO.
NOV 10 2020
DATE 10-26-20
PAGE 10-00-004
R. MAINES
#20-04430D

10-00-004-124-037

BEARINGS BASED ON:
THE RIGHT OF WAY OF MILLER COURT
(NORTH 89°53'00" EAST) AS SHOWN IN THE
THEO CARPENTER SUBDIVISION RECORDED IN
VOLUME 21 OF MAPS, PAGE 5 L.C.R.

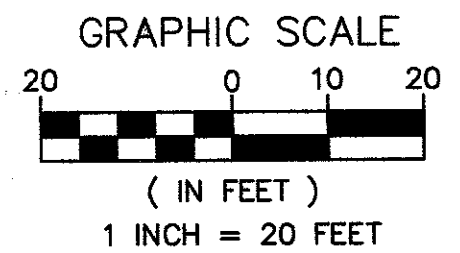

PARCEL NUMBER 10-00-004-124-082
ROBERT J. THOMPSON
ELAINE MARIE KINTER
ALAN W. THOMPSON
INST. NO. 1997-0499267

PARCEL NUMBER 10-00-004-124-038
AMBER HISSOM
INST. NO. 2012-0420988

PARCEL NUMBER 10-00-004-124-083
THOMAS M. DONAGHUE
INST. NO. 1999-0595113

PARCEL NUMBER 10-00-004-124-037
RYAN A. MAINS
INST. NO. 2017-0650088
11,955 S.F. OR 0.2745 ACRES

ACCESS TO
ADJACENT
PARCEL
OVER
SUBJECT

S/L 22

S/L 21

25' ALLEY
PER 1950 SURVEY

Theo Carpenter Subdivision
Vol. 21 of Maps, Pg. 5 L.C.R.

MILLER COURT - 50'
(A PUBLIC RIGHT-OF-WAY)

REFERENCES USED:
LORAIN COUNTY GIS AND HISTORIC TAXMAPS
REFERENCES AS SHOWN HEREON.

● - 5/8" BY 30" IRON PIN SET AND CAPPED "CASEY PS8219" - IPS	ADJ. CL	ADJACENT CENTERLINE	R/W S	RIGHT-OF-WAY SOUTH
[M] - MONUMENT BOX FOUND	CLF	CHAIN LINK FENCE	P.O.B.	POINT OF BEGINNING
○ - IRON PIN/PIPE FOUND - IFF/PIPF	DIST.	DISTURBED	P.O.C.	POINT OF COMMENCEMENT
⊙ - DRILL HOLE SET	E	EAST	P.O.T.	POINT OF TANGENCY
✕ - MAG NAIL SET	ENCRS.	ENCROACHES	S.F.	SQUARE FEET
(R) RECORD	L.C.R.	LORAIN COUNTY	VOL.	VOLUME
(C) CALCULATED	N	NORTH	W.F.	WEST
(M) MEASURED	INST. NO.	INSTRUMENT NUMBER	⊙	WOOD FRAME GAS LINE MARKER UTILITY POLE

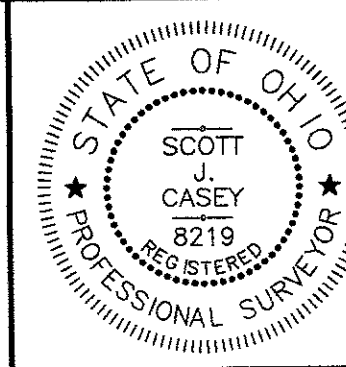

THIS MAP REPRESENTS A SURVEY DONE BY
MYSELF ON OCTOBER 6TH OF 2020 WHICH
CONFORMS TO THE MINIMUM STANDARDS FOR
BOUNDARY SURVEYS IS IN ACCORDANCE WITH
THE OHIO ADMINISTRATIVE CODE CHAPTER
4733-37.

SCOTT J. CASEY 10/10/2020

Casey Professional Services, LLC

1159 Holmden Avenue, Cleveland, OH 44109
216-781-8644 office & fax 216-249-9555 mobile
www.caseyps.com

JOB NO.	20132
SCALE:	1"=20'
DRAWN BY:	SJC
FIELD WORK DATE:	10/6/2020

LINE	BEARING	DISTANCE
L1	N 00°07'00" E	2.82'