

APPROVED
LORAIN CO.
MANIFEST

DATE 8-21-20

PAGE 6-25-038

BY R. MAINES

#20 04163

06-25-038-108-007
-046

THOMAS SIMON & ASSOCIATES, INC.
PROFESSIONAL LAND SURVEYORS

150 SOUTH OLIVE STREET
ELYRIA, OHIO 44035
(440) 327-2925
FAX 327-2964

DIMENSIONS SHOWN ON THIS PLAT ARE EXPRESSED IN FEET AND DECIMAL PARTS THEREOF, ALL BEARINGS ARE TO AN ASSUMED MERIDIAN AND ARE USED TO INDICATE ANGLES ONLY. PERMANENT MONUMENTS WERE FOUND OR SET AT ALL POINTS INDICATED HEREON, ALL OF WHICH I CERTIFY TO BE CORRECT.

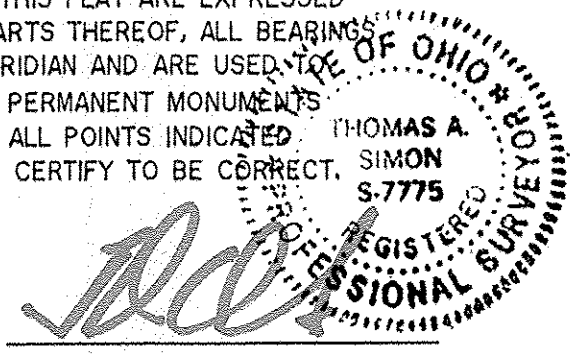

THOMAS A. SIMON
REG. PROFESSIONAL SURVEYOR
NO. S-7775

BASIS OF BEARINGS IS THE CENTERLINE OF GULF ROAD (NORTH 02°02'46" WEST).

PLAT OF BOUNDARY SURVEY AND SPLIT FOR THE TWELVE, INC.

BEING KNOWN AS ALL OF SUBLOT NOS. 46, 47, 48, AND 49 OF EAST LAWN ALLOTMENT AS RECORDED IN PLAT VOLUME 10 PAGE 2, AND PART OF SUBLOT NO. 10 OF ABBHEY'S ADDITION AS RECORDED IN PLAT VOLUME 4 PAGE 4 BOTH OF LORAIN COUNTY MAP RECORDS AND PART OF ORIGINAL ELYRIA TOWNSHIP LOT NO. 38 EAST OF THE BLACK RIVER

CITY OF ELYRIA COUNTY OF LORAIN STATE OF OHIO

JULY, 2020 SCALE: 1" = 40'