

POINT OF COMMENCEMENT

SW COR., BLOCK "A", WESTMINSTER SUBDIVISION NO. 1  
PLAT VOLUME 28, PAGE 6  
(HIGHWAY STATION 1359+29.17, 65.00' RT)  
REFERENCED BY A 1/2" IRON PIPE FOUND S13°46'05"W, 81.66'  
(HIGHWAY STATION 1358+50.00, 45.00' RT)  
UTILITY POLE ON CORNER

GLOBAL SCHOOL PROPERTIES OHIO LLC  
INS. #20190717996  
2.6212 ACRES  
PP#0202007101060

PLAT OF BOUNDARY SURVEY  
PART OF BLACK RIVER TOWNSHIP LOT 7, TRACT 2  
TOWNSHIP SEVEN NORTH (7N),  
RANGE EIGHTEEN WEST (18W)  
CONNECTICUT WESTERN RESERVE &  
PART OF VACATED TEMPLE AVENUE,  
PART OF VACATED WESTMINSTER DRIVE,  
& PART OF VACATED SHELLY DRIVE  
CITY OF LORAIN, LORAIN COUNTY, OHIO

REFERENCE MATERIALS

- DEEDS AS SHOWN
- TAX MAPS
- PLAT VOLUME 28, PAGE 6
- PLAT VOLUME 25, PAGE 61
- THE FOLLOWING LORAIN COUNTY SURVEYS:
- SURVEY BY HAYWOOD CIVIL ENGINEERING & LAND SURVEYING, INC. DATED MAY 9, 2015
- SURVEY BY GBC DESIGN, INC. DATED MARCH 25, 2013
- SURVEY BY GPD ASSOCIATES DATED MARCH 27, 2006
- SURVEY BY MICHAEL G. HURA DATED SEPTEMBER 5, 1986
- SURVEY BY ROY E. SCHAFFER, JR. DATED MAY 13, 1970
- SURVEY BY C.H. LAWRENCE DATED NOVEMBER 28, 1910
- ODOT PLANS LOR-58-(23.81-24.66)

LEAVITT ROAD (S.R. 58) - WIDTH VARIES

POINT OF BEGINNING

TEMPLE AVENUE - 60'  
(VACATED)

REMAINDER  
L.F. KAYATIN & M. BOARD, TRUSTEES  
INS. #20170646657  
PP#0202007101061  
5.4513 ACRES

SHELLY DRIVE - 60'  
(VACATED)

WESTMINSTER DRIVE - 60'

ST. NICHOLAS GREEK ORTHODOX  
CHURCH OF LORAIN, OHIO  
DV 998/859  
4.430 ACRES  
PP#0202007101031

BEARINGS ARE BASED ON OHIO  
STATE PLANE COORDINATE SYSTEM,  
GRID NORTH, ODOT VRS, NORTH ZONE.

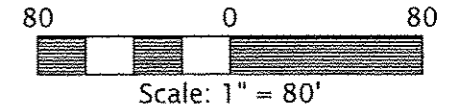

LEGEND

- ▲ IRON PIN FOUND
- 1/2" DIAMETER IRON PIPE FOUND (UNLESS NOTED)
- ⊕ DRILL HOLE FOUND IN CONCRETE
- 5/8" DIAMETER, 30" LONG IRON PIN SET WITH CAP STAMPED "KROCKA & ASSOC."

APPROVED  
LORAIN CO.  
MAY 10 2019  
DATE: 4-3-20  
PAGE 2-02-007  
BY R. MAINES  
#20-04113

PREPARED BY  
**F.E. KROCKA & ASSOCIATES, INC.**  
100 NORTH GAMBLE STREET  
SHELBY, OHIO 44875  
(419) 342-4556

I CERTIFY THIS SURVEY WAS PREPARED FROM ACTUAL FIELD MEASUREMENTS IN ACCORDANCE WITH CHAPTER 4733-37 OF THE OHIO ADMINISTRATIVE CODE AND THAT ALL MONUMENTS WERE FOUND OR SET AS INDICATED.

*Nathan W. Sautter*  
NATHAN W. SAUTTER  
OHIO REGISTERED SURVEYOR NO. 8252  
DATE: DECEMBER 9, 2019

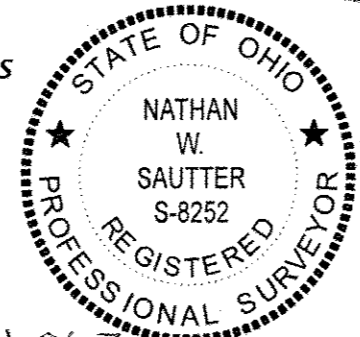

APPROVED BY THE LORAIN CITY PLANNING COMMISSION  
NO PLAT REQUIRED  
*[Signature]*  
SECRETARY LORAIN CITY PLANNING COMMISSION

APPROVED  
AS TO DESCRIPTION ONLY  
Date: Dec 10 2019  
City of Lorain  
Per: *[Signature]* P.S.  
Engineering Dept.

02-02-007-101-067