

THOMAS SIMON & ASSOCIATES, INC.
PROFESSIONAL LAND SURVEYORS

150 SOUTH OLIVE STREET
ELYRIA, OHIO 44035
(440) 327-2925
FAX 327-2964

BASIS OF BEARINGS IS THE CENTERLINE OF OBERLIN ROAD (NORTH 01°41'54" EAST). IRON PINS SET ARE 5/8" DIAMETER, 30" LONG WITH PLASTIC CAPS "T. SIMON, S-7775".

DIMENSIONS SHOWN ON THIS PLAT ARE EXPRESSED IN FEET AND DECIMAL PARTS THEREOF, ALL BEARINGS ARE TO AN ASSUMED MERIDIAN AND ARE USED TO INDICATE ANGLES ONLY. PERMANENT MONUMENTS WERE FOUND OR SET AT ALL POINTS INDICATED HEREON, ALL OF WHICH I CERTIFY TO BE CORRECT.

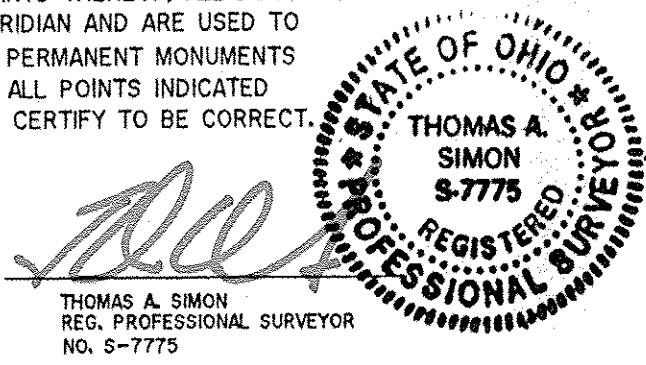

THOMAS A. SIMON
REG. PROFESSIONAL SURVEYOR
NO. S-7775

05-00-069-000-002
BAUS FARMS, INC.
ORV 527 PG 158

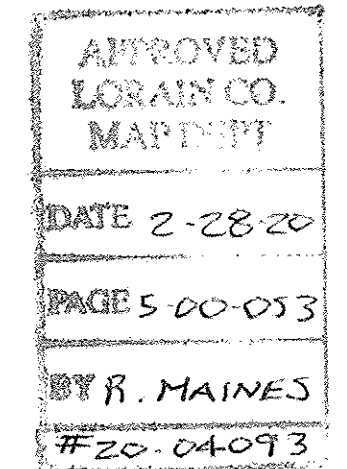

05-00-053-000-107
-108

PLAT OF SURVEY & SPLIT

BEING KNOWN AS PARTS OF ORIGINAL AMHERST TOWNSHIP LOT NOS. 52, 53 AND 69

COUNTY OF LORAIN STATE OF OHIO
DECEMBER, 2019 SCALE: 1" = 200'