

Robert L. Thomas, Jr.  
 \*Instrument # 1988-0027880  
 Parcel # 05-00-095-000-050

**PRE-SURVEY SUMMARY**  
 SCALE 1"=100'

Parcel #	Parcel #	Parcel #
05-00-095-000-053	05-00-095-000-054	05-00-095-000-055
1.0487 acres (Calc.)	1.0418 acres (Calc.)	1.0262 acres (Calc.)
1.048 acres (Deed)	1.040 acres (Deed)	1.024 acres (Deed)

**SURVEY SUMMARY**  
 SCALE 1"=100'

Consolidation Parcel	Parcel #
	05-00-095-000-055

**NOTES**

- All iron pins set are 5/8"x30" rebar with yellow plastic caps stamped "HOZALSKI P.S. 8677 / VECTOR SURVEYING", set 5" above ground in areas where future discovery may be difficult, unless otherwise noted. All others set flush with ground, unless otherwise noted.
- All drillholes set are 5/8" in diameter.

**REFERENCES**

- Lorain County Survey Records
- None used
- Lorain County Deed Records
- Volume and Pages as indicated

APPROVED  
 LORAIN CO.  
 MAP DEPT  
 DATE 1-13-20  
 PAGE 5-00-095  
 BY R. MAINES  
 #20-04079  
 05-00-095-000-089

**LEGEND**

SET	FOUND	DESCRIPTION
○	●	IRON PIN/ROD
⊗	⊙	SURVEY NAIL
⊕	⊖	MAG SPIKE
⊘	⊙	DRILL HOLE
⊗	⊙	RAILROAD SPIKE
⊕	⊙	MONUMENT BOX
⊘	⊙	CONCRETE MONUMENT
⊗	⊙	IRON PIPE
⊕	⊙	STONE
⊘	⊙	WOOD POST
⊗	⊙	CENTERLINE
⊕	⊙	RIGHT-OF-WAY
⊘	⊙	ORIGINAL LOT LINE

**ABBREVIATIONS**

D	per deed	PC	point of curvature
P	per plat	PRC	point of reverse curvature
M	measured	PT	point of tangency
C	calculated	OL	Original Lot
U	used	GL	Great Lot
FND	found	SL	Sublot
CL	centerline	R/W	right-of-way
POB	place of beginning		
PPOB	principal place of beginning		

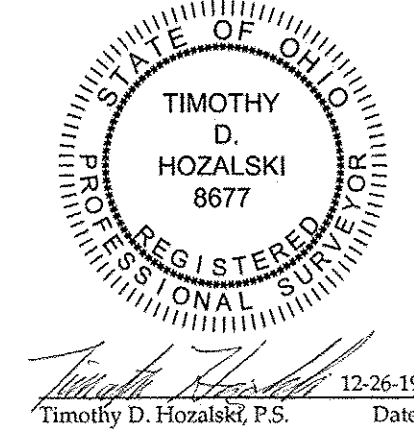

**AREA BREAKDOWN**

Within Parcel # 05-00-095-000-055: 1.0262 acres  
 Within R/W: 0.0865 acres (3,768.9136 ft<sup>2</sup>)  
 Within Consolidation Parcel: 2.0905 acres  
 Within R/W: 0.1722 acres (7,502.3266 ft<sup>2</sup>)

**Consolidation & Retracement for Perritt Homes, LLC**  
 Being a parcel of land located in part of Original Lot 95, Amherst Township, Township 6 North, Range 18 West, Connecticut Western Reserve, Lorain County, Ohio  
 SCALE 1"=60'  
 BEARINGS ARE RELATIVE TO THE OHIO STATE PLANE COORDINATE SYSTEM, NORTH ZONE (8401), NAD83(2011), AND CORRECTED VIA THE ODOT VRS  
 MINIMUM ERROR OF CLOSURE: 1 : 10,000

**VECTOR SURVEYING SERVICES, LLC**  
 OFFICE: 440-865-8445 AMHERST, OH  
 VECTORSURVEYING@YAHOO.COM  
 Job No. 19-112 Drawn By: CAD  
 Date: Dec, 2019 Checked By: TDH