

PLAT OF SURVEY
BOUNDARY RETRACEMENT SURVEY
OF THE LAND OF PATRICIA A. WALKO
DESCRIBING 0.2421 ACRES OF LAND

SITUATED IN THE TOWNSHIP OF CARLISLE, COUNTY OF LORAIN, AND STATE OF OHIO AND BEING A PART OF ORIGINAL CARLISLE TOWNSHIP LOT NO. 15 AND ALSO KNOWN AS BEING A PART OF SUBLOT 203, IN THE BRENTWOOD ALLOTMENT NO. 5, AS RECORDED IN PLAT VOLUME 22, PAGE 58 OF LORAIN COUNTY RECORDER'S RECORDS

P.N. 1000015112006
 MATTHEW J. MARLOWE
 INSTR. NO. 2013-0465278
 06/12/2013

RETRACEMENT = 0.2421 Acres
 P.N. 1000015112016
 PATRICIA A. WALKO
 INSTR. NO. 2013-0489603 12/17/2013
 INSTR. NO. 1989-0072638 09/21/1989

P.N. 1000015112118
 JAMES BASSAK
 INSTR. NO. 2001-0780686-A
 09/28/2001

BRENTWOOD ALLOTMENT NO. 5
 PLAT VOLUME 22, PAGE 58

C-1 CURVE:
 RAD. = 40.00'
 ARC = 42.50'
 TAN. = 23.50'
 Δ = 60°52'21"
 CH. = 40.53'
 N 29°48'08" W

LEGEND

- - 5/8" IRON PIN FOUND W/CAP
- - 5/8" IRON PIN SET W/CAP ROLLING~HOCEVAR
- ⊠ - MONUMENT BOX W/ IRON PIN FOUND
- - 5/8" IRON PIN FOUND (NO CAP)
- ⊙ - IRON PIPE FOUND
- - STONE FOUND
- ☆ - RAILROAD SPIKE FOUND
- ⊠ - WOOD POST FOUND
- ▲ - PK NAIL SET
- △ - PK NAIL FOUND
- Fnd. - FOUND
- Msd. - MEASURED
- Obs. - OBSERVED
- Rec. - RECORD
- Usd. - USED
- "R&H" = ROLLING~HOCEVAR

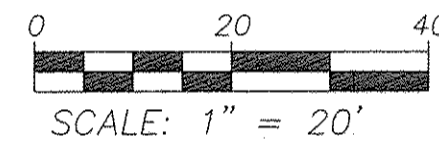

NOTE: BEARINGS ARE BASED ON AN ASSUMED MERIDIAN AND ARE USED TO DENOTE ANGLES ONLY.

- CENTERLINE
- RIGHT OF WAY
- TWP. LOT LINE
- PARCEL LINE
- SUBLOT LINE

APPROVED
 LORAIN CO.
 MAYOR
 DATE 10-16-19
 BY R. MAINES
 #19-04205-C

10-00-015-112-016

REFERENCES:

Lorain County Engineer's Survey Records:
 12-3426, 18-03868-D, 22-58, S-0377

Lorain County Recorder's Records:
 PLAT VOLUME 22, PAGE 58
 DEEDS AS NOTED

OCTOBER, 2019



CIVIL ENGINEERING & SURVEYING
 257 SOUTH COURT STREET
 SUITE 6
 MEDINA, OHIO 44256
 PHONE: (330)723-1828
 FAX: (330)723-6637

PROJECT No. 31,886

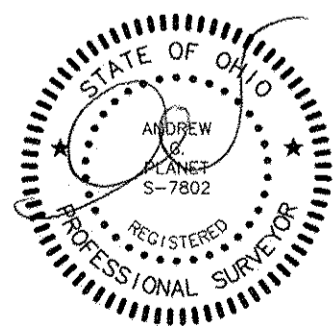

CERTIFICATION:

I HEREBY CERTIFY THIS DRAWING TO BE OF A SURVEY MADE BY ME AND/OR UNDER MY DIRECT SUPERVISION AND TO BE TRUE AND ACCURATE TO THE BEST OF MY KNOWLEDGE.

DISTANCES ARE GIVEN IN FEET AND DECIMAL PARTS THEREOF. BEARINGS ARE REFERENCED TO AN ASSUMED MERIDIAN AND ARE USED TO INDICATE ANGLES ONLY.

 ANDREW G. PLANET, P.S. REG. SURVEYOR NO. 7802

10-10-2019
 DATE