

APPROVED
LORAIN CO.
MAP DEPT
DATE 8-7-19
PAGE 9-00-011
BY R. MAINES
#19-04-004

WAYNE W. & SUE A. PALLER
11/14/88 DOC NO 1988-0041837
PPN 09-00-011-000-010

REMAINDER 25.1959 AC CALC

TIMOTHY A. MAHAR & DIANNE L. MAHAR
O.R.V. 345, P. 160 11/13/90
PPN 09-00-011-000-023
30.4228 AC DEED

CLINTON M. & DEBORAH A. STACKHOUSE
12/08/95 DOC NO 1995-0378459
PPN 09-00-011-000-016

DALE A. & CHRISTINE L. DEWITT
12/17/*93 DOC NO 1993-0266012
PPN 09-00-011-000-027

THOMAS Y. & MARY JO SKEENS
DEED VOLUME 1401, PAGE 148
PPN 09-00-011-000-017

MARYANN WATSON
DOC NO 2011-0368363 02/25/11
PPN 09-00-011-000-020

SPLIT 1
227683.8 SQ. FT.
5.2269 ACRES

ORIGINAL LOT 89 HENRIETTA TOWNSHIP
ORIGINAL LOT 11 RUSSIA TOWNSHIP

QUARRY ROAD 60' C.R. 30

BEARINGS ARE REFERENCED TO THE OHIO STATE PLANE COORDINATE SYSTEM, NORTH ZONE (NAD 1983) BASED ON GPS OBSERVATIONS TAKEN ON JULY 12, 2013 USING THE OHIO DEPARTMENT OF TRANSPORTATION CORS NETWORK AND WGS 1984 ELLIPSOID.

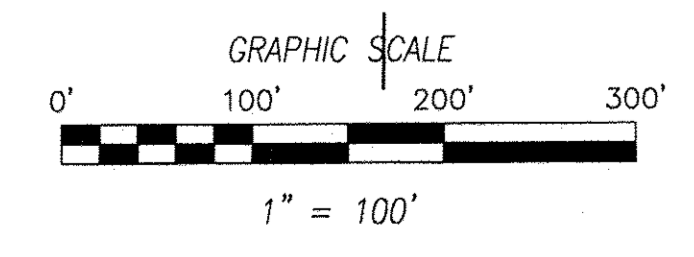

THE INFORMATION SHOWN HEREON WAS PREPARED BY ME FROM THE RESULTS OF A BOUNDARY SURVEY CONDUCTED BY ME IN JULY 2013 IN ACCORDANCE WITH O.A.C. 4733-37.
Phil A. Rosebeck
PHIL A. ROSEBECK REGISTERED SURVEYOR NO. 6696

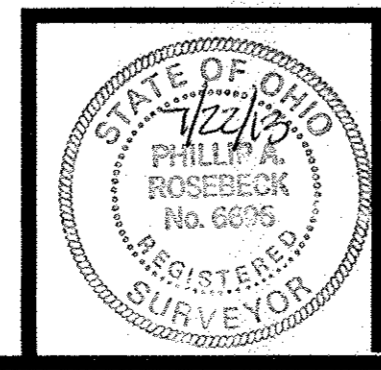

SURVEY & SPLIT
MICHAEL L. MURPHY, JR. & MARCI MURPHY
PART OF ORIGINAL NEW RUSSIA TOWNSHIP LOT 11,
LORAIN COUNTY, STATE OF OHIO
JULY 12, 2013

NO.	DATE	DESCRIPTION	BY
0	07/22/13	ORIGINAL ISSUE	PAR

P.A. ROSEBECK & ASSOCIATES
REGISTERED SURVEYOR
705 WILLOW CREEK DRIVE, AMHERST, OHIO 44001
PHONE: (440) 988-4657

SHEET
1
OF
1

