

3-22-19  
 16-00-089  
 B. MAINES  
 #19-04064-0

5/8" IRON PIN FOUND  
 30.00' FROM CENTERLINE  
 (BY PERPENDICULAR MEAS.)  
 USED FOR CENTERLINE  
 UP 2"

1/2" IRON PIPE FOUND  
 N0° 48' 19"E 0.46' FROM CORNER  
 USED FOR LINE  
 DOWN 3"

1/2" IRON PIPE FOUND  
 S89° 58' 19"W 10.26' FROM CORNER  
 USED FOR LINE  
 UP 6"

1/2" BENT IRON PIN FOUND  
 S89° 51' 54"W 29.81' FROM CORNER  
 USED FOR LINE  
 UP 6"

1/2" IRON PIPE FOUND  
 S89° 58' 19"W 29.97' FROM CORNER  
 USED FOR LINE  
 DOWN 1"

1/2" IRON PIN FOUND  
 S89° 53' 51"W 30.00' FROM CORNER  
 USED FOR LINE  
 UP 3"

**NOTES**

- All iron pins set are 5/8"x30" rebar with yellow plastic caps stamped "HOZALSKI P.S. 8677/ VECTOR SURVEYING", set 7" above ground, unless otherwise noted.
- All drillholes set are 5/8" in diameter.

**TOTAL AREA**

1.3091 acres (Calc)  
 1.33 acres (Deed)  
 0.1308 acres (5,697.7068 ft<sup>2</sup>) Within R/W

**LEGEND**

SET	FOUND	DESCRIPTION
○	●	IRON PIN/ROD
◇	◆	SURVEY NAIL
⊗	⊙	MAG SPIKE
⊕	⊖	DRILL HOLE
⊙	⊕	RAILROAD SPIKE
⊙	⊕	MONUMENT BOX
⊙	⊕	CONCRETE MONUMENT
⊙	⊕	IRON PIPE
⊙	⊕	STONE
⊙	⊕	WOOD POST
---	---	CENTERLINE
---	---	RIGHT-OF-WAY

**ABBREVIATIONS**

D	per deed	PC	point of curvature
P	per plat	PRC	point of reverse curvature
M	measured	PT	point of tangency
C	calculated	OL	Original Lot
U	used	GL	Great Lot
FND	found	SL	Sublot
CL	centerline	R/W	right-of-way
POB	place of beginning		
PPOB	principal place of beginning		

**REFERENCES**

- Lorain County Survey Records**  
 Survey for Peter Grabenstetter (Dec, 1911)  
 Survey by McGlinchy & Assoc. (Aug, 1975)  
 Survey for Gordy Hales By John R. Hamilton (1988)  
 Survey for Mike Sauter By John R. Hamilton (Nov, 1991)  
 Survey by John Poznyak (Jun, 1997)
- Lorain County Deed Records**  
 Volume and Pages as indicated  
**ODOT Centerline Survey Records**  
 Medina-Elyria Road I.C.H. No. 314, Section Q-1 (1925)  
 LOR-57-2.22 (2013)

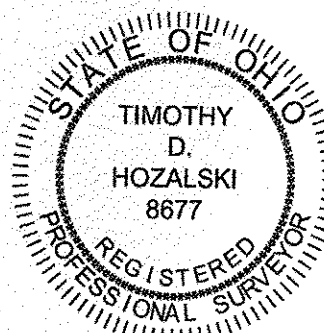

3-15-19  
 Timothy D. Hozalski, P.S. Date

**Retracement for**  
**Matt & Ashley Waldron**  
 Being a parcel of land located in part of Original Lot 89,  
 Grafton Township, Township 4 North, Range 16 West,  
 Connecticut Western Reserve, Lorain County, Ohio

SCALE 1"=80'  
 BEARINGS ARE RELATIVE TO THE OHIO STATE PLANE  
 COORDINATE SYSTEM, NORTH ZONE (3401), NAD83(2011),  
 AND CORRECTED VIA THE ODOT VRS  
 MINIMUM ERROR OF CLOSURE: 1 : 10,000



OFFICE: 440-865-8445 AMHERST, OH  
 VECTORSURVEYING@YAHOO.COM  
 Job No. 19-018 Drawn By: CAD  
 Date: Mar, 2019 Checked By: TDF