

11-00-091-000-179, 11-00-092-000-094

SURVEY
OF PART OF

ORIGINAL EATON TOWNSHIP LOTS 91 AND 92
TOWNSHIP OF EATON COUNTY OF LORAIN STATE OF OHIO

ORIGINAL LOT NO. 91

ORIGINAL LOT NO. 91
ORIGINAL LOT NO. 92

CHESTNUT RIDGE ROAD 60'



N76°52'18"E
100.00' R.#U.

46.32'
2-1" PIPES FND.
0.26' W 30.60' S
0.18' W 30.73' S

1100092000017
RAY & DENICE MARCINKO
INSTRUMENT NO. 2001-0768417

0.39 ac. IN O.L.
91

1100092000019 2.012 ACRES
RODGER W JR & DAPHNE L DYSON
INSTRUMENT NO. 1999-0611612

1100092000018 1.103 ACRES
RODGER J & DAPHNE L DYSON
INSTRUMENT NO. 2000-667922

1100092000016
TISHA S RAY
INSTRUMENT NO. 2016-0611050

1100092000020
PATRICIA A BOGGS
INSTRUMENT NO. 2007-0211961

1100092000078
TERRY C CHRISTENSEN
INSTRUMENT NO. 2017-0650393

896.95' CALC.

NO2°07'30"W
395.56' REC. USED

NO2°07'30"W
395.56' REC. USED

0.10' S.
0.15' S. 0.41' W
0.13' W.
N76°52'18"E
100.00'

NO2°07'30"W 493.37' CALC.

NO2°07'30"W 485.33' CALC..

NO2°07'30"W

LEGEND:

- ⊕ = 5/8" REBAR SET WITH I.D. CAP
- = PIPE FOUND
- ◉ = PIPE FOUND AND USED
- ▲ = REBAR FOUND
- △ = REBAR FOUND AND USED
- = MONUMENT BOX
- ⊙ = FENCE POST

DATE: FEBRUARY 15, 2018

BASIS OF BEARINGS: ARE ASSUMED

BARBOSA AND ASSOCIATES LLC
5604 CASE ROAD
NORTH RIDGEVILLE, OH 44039
440 327-4776

PROPERTY ADDRESS:
38075 CHESTNUT RIDGE ROAD
ELYRIA, OHIO 44035

PREPARED AT THE REQUEST OF:
RODGER DYSON

GRAPHIC SCALE

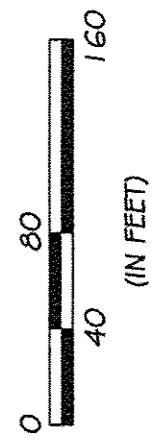

SCALE: 1" = 80'

APPROVED LORAIN CO. MAP DEPT
DATE 4-9-18
PAGE 11-00-092
BY R. MAINES #18-03802

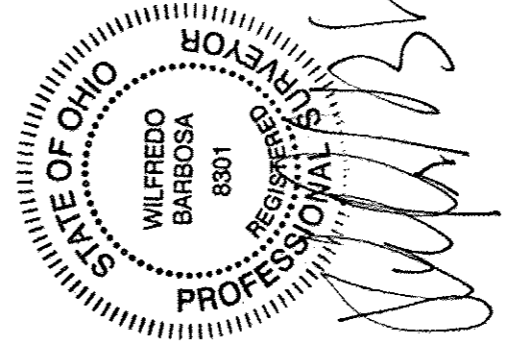

DRAWN BY: WB	CHECKED BY: WB
JOB No: 2018-1-1	SHEET 1 of 1