



OFFICE: 440-865-8445 AMHERST, OH  
VECTORSURVEYING@YAHOO.COM  
Job No. 17-083 Drawn By: CAD  
Date: Nov, 2017 Checked By: TDH

**Retracement Survey  
for David Hozalski**

Being a parcel of land located in part of Original Lot 61, New Russia Township, Twp 5 North, Range 18 West, Connecticut Western Reserve, Lorain County, Ohio

SCALE 1"=200'  
200 0 200 400  
BEARINGS ARE RELATIVE TO THE OHIO STATE PLANE COORDINATE SYSTEM, NORTH ZONE (3401), NAD83(2011), AND CORRECTED VIA THE ODOT VRS  
MINIMUM ERROR OF CLOSURE: 1 : 10,000

**REFERENCES**

**Lorain County Survey Records**  
Survey by T.L. Gibson (Aug, 1913)  
Survey by Rodger G. Simon (Nov, 1998)  
Survey by Thomas Simon & Assoc. (Aug, 1999)  
Survey by Vector Surveying Services (June, 2015)  
**Lorain County Deed Records**  
Volume and Pages as indicated

**LEGEND**

SET FOUND DESCRIPTION

- IRON PIN/ROD
- ◇ SURVEY NAIL
- ⊙ MAG SPIKE
- ⊗ DRILL HOLE
- ⊕ RAILROAD SPIKE
- △ MONUMENT BOX
- CONCRETE MONUMENT
- IRON PIPE
- ▲ STONE
- WOOD POST

**ABBREVIATIONS**

(D) PER DEED (M) MEASURED (P) PER PLAT  
(C) CALCULATED (GS) PER GIBSON SURVEY  
(VS) PER VECTOR SURVEY  
ALL IRON PINS SET ARE 5/8"x30" REBAR WITH YELLOW PLASTIC CAPS STAMPED "HOZALSKI P.S. 8677/ VECTOR SURVEYING"  
ALL DRILL HOLES SET ARE 5/8" IN DIAMETER

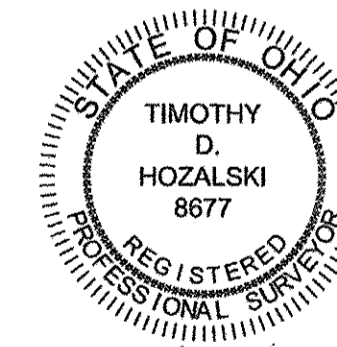

Timothy D. Hozalski, P.S. 8677  
Date 11-27-17

APPROVED  
LORAIN CO.  
MAP DEPT  
DATE 2-1-18  
PAGE 9-00-061  
BY R. MAINES  
#18-03828C

09-00-061-000-004  
-005

**AREA BREAKDOWN**

**Within Parcel One:** 33.1026 acres (Calculated)  
32.5 acres (Deed)  
Within R/W: 0.1888 acres (8,223.5575 ft<sup>2</sup>)  
**Within Parcel Two:** 2.4899 acres (Calculated)  
2.5 acres (Deed)  
Within R/W: 0.2265 acres (9,865.6953 ft<sup>2</sup>)  
**Total Area:** 35.5925 acres  
Within R/W: 0.4153 acres (18,089.2528 ft<sup>2</sup>)

