

**PLAT OF LOT SPLIT**

PREPARED FOR  
**BRENNEMAN**

SITUATED IN THE TOWNSHIP OF BROWNHELM, COUNTY OF LORAIN AND STATE OF OHIO; AND KNOWN AS  
BEING PART OF ORIGINAL BROWNHELM TOWNSHIP LOT NO. 61

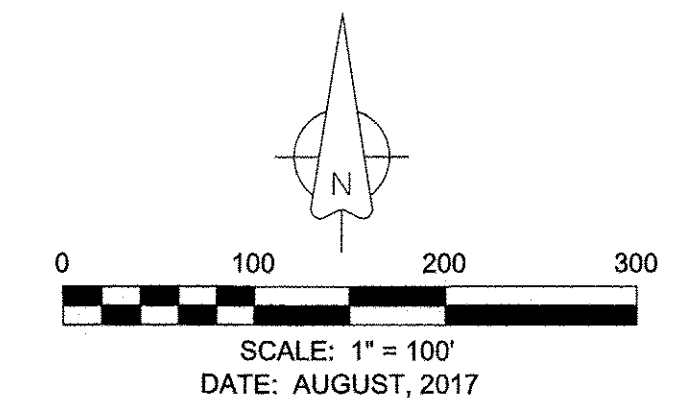

PARCEL NO. 0100061000004  
BODEN TRUST  
INSTRUMENT NO. 1996-0398196

PARCEL NO. 0100061000005  
JEFFERY & SHERRY BODEN  
INSTRUMENT NO. 2017-0636272

PARCEL NO. 0100061000006  
ELIZABETH M. & GREGORY BRENNEMAN  
INSTRUMENT NO. 1999-0608880  
Total Acreage  
569766.4 Sq. Feet  
13.080 Acres

PARCEL B  
439074.1 Sq. Feet  
10.080 Acres

PARCEL NO. 0100061000012  
D & R MILLER LAND COMPANY LTD  
INSTRUMENT NO. 2002-0815267

PARCEL NO. 0100061000008  
LORAIN COUNTY METRO PARKS  
INSTRUMENT NO. 1994-0314771

PARCEL A  
130668.4 Sq. Feet  
3.000 Acres

PARCEL NO. 0100068000017  
D & R MILLER LAND COMPANY LTD  
INSTRUMENT NO. 2003-0893689

PARCEL NO. 0100061000016  
DAVID & SANDRA MILLER

LOCATION MAP

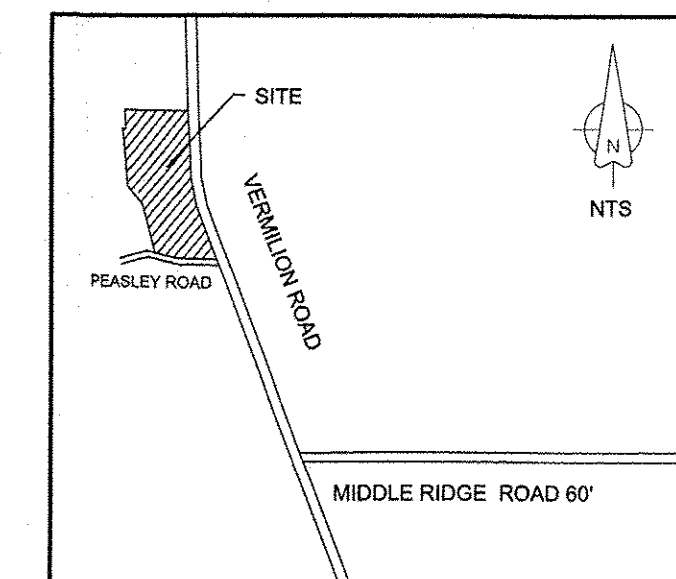

APPROVED  
LORAIN CO.  
MAP DEPT  
DATE 10-23-17  
PAGE 1-00-061  
BY R. MAINES  
#17-03738

01-00-061-000-017  
-018

LEGEND

- IPF = Iron Pin Found
- IPMF = Iron Pin Monument Found
- IPCS = Iron Pin Capped Set
- IPCF = Iron Pin Capped Found
- = Iron Pipe Found
- ⊗ = Rail Road Spike Found



CERTIFICATION

THIS PLAT WAS PREPARED FROM A FIELD SURVEY, ANALYSIS OF RECORDED DEEDS AND LORAIN COUNTY RECORDS, BEARINGS SHOWN HEREON ARE CALCULATED FROM DEED AND SURVEY RECORD, DISTANCES ARE GIVEN IN FEET AND DECIMAL PARTS THEREOF. ALL OF WHICH I BELIEVE TO BE CORRECT.

*Sean A. Boland* 9/26/17  
SEAN A. BOLAND, P.S.  
REGISTERED OHIO PROFESSIONAL  
SURVEYOR NO. 7699  
Boland Land Surveying LLC  
bolandsurveying@gmail.com  
440-785-2943

BASIS OF BEARINGS  
Center Line Vermilion Road  
record N 33°09'00" West