

- SURVEY LEGEND**
- ⊙ - 5/8" Rebar Set w/cap CESO, Inc
 - ⊙ - Iron Pin Found as described
 - - Iron Pipe Found & Described
 - ⌵ - Railroad Spike Set
 - ⊠ - Monument Fnd. & Ustd.
- Fnd. (F) - Found Obs. (O) - Observed
 Msd. (M) - Measured Rec. (R) - Deed
 Ustd. (U) - Used Calc. (C) - Calculated

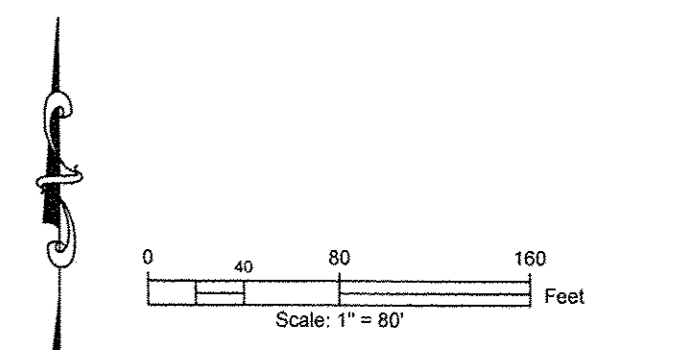

BASIS OF BEARINGS
 The Basis of Bearings for this survey is NAD 83, OHIO NORTH (2011)

I hereby state that this plat is a true and accurate representation of the premises shown hereon and was based on an actual survey performed on the ground under my supervision.

Date: 7/31/17
 Steven W. Clutter, P.S. 7655
 CESO, Inc.
 395 Springside Drive Suite 202
 Akron, OH 44333
 (330) 665-0660

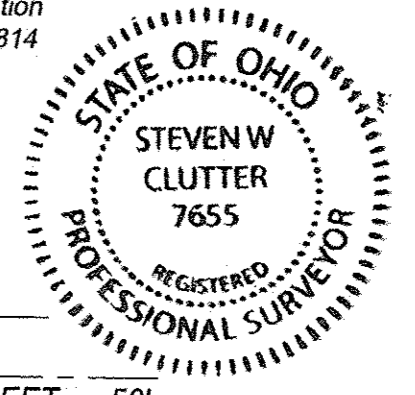

APPROVED
 LORAIN CO.
 MAP DEPT.
 DATE 10/30/17
 BY T. Sullivan
 03736
 SCAN # 49242

APPROVED BY PLANNING COMMISSION
 CITY OF ELYRIA, OH
 NO PLAT REQUIRED
 DATE 8/24/17

K & M ASSOCIATES LOT SPLIT

ELYSIA CITY SCHOOLS

CITY OF ELYRIA ORIGINAL CARLISLE TWP., SECTION 3 LORAIN COUNTY, OHIO

SCALE: 1" = 80' DATE: JULY 31, 2017

DESIGN: JOB NO.: 752290
 DRAWN: SHEET NO.:
 CHECKED: swc 1 OF 1

CESO
 WWW.CESO.INC.COM