

APPROVED
LORAIN CO.
DATE 8-7-17
PAGE 11-00-057
BY R. MAINES
#17-03709

11-00-057-000-069
-070
-071

LEGEND

SET FOUND DESCRIPTION

○	IRON PIN/ROD
◇	SURVEY NAIL
⊙	MAG SPIKE
⊗	DRILL HOLE
⊕	RAILROAD SPIKE
□	MONUMENT BOX
⊞	CONCRETE MONUMENT
○	IRON PIPE
▲	STONE
■	WOOD POST

AREA BREAKDOWN

Within Split Parcel: 4.2772 acres

Within Consolidation Parcel: 5.4894 acres
Within R/W: 0.1126 acres (4,905.7252 ft²)

Within Remainder Parcel: 1.9273 acres
Within R/W: 0.1084 acres (4,721.6253 ft²)

ABBREVIATIONS

(D) PER DEED (M) MEASURED (P) PER PLAT
(C) CALCULATED (FS) PER FAIRVIEW SURVEY

ALL IRON PINS SET ARE 5/8"x30" REBAR WITH YELLOW PLASTIC CAPS STAMPED "HOZALSKI P.S. 8677 / VECTOR SURVEYING"

ALL DRILL HOLES SET ARE 5/8" IN DIAMETER

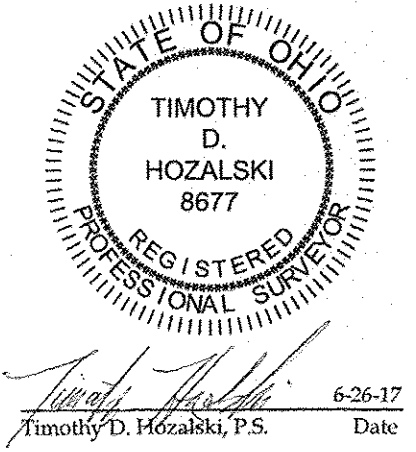

REFERENCES

Lorain County Survey Records

- Survey for Tom Stemmer, Jr. by Gary E. Penfound (Sep, 1977)
- Survey for Tom Stemmer, Jr. by Gary E. Penfound (Jun, 1978)
- Survey for Hugh A. & Sandra L. Graham by Gary E. Penfound (Aug, 1978)
- Survey for Roy L. & Helen M. Milner by Gary E. Penfound (Jul, 1979)
- Survey for Joe Shairba by Laundon-Simon-Cahl & Assoc. Inc. (Nov, 1994)
- Survey for Maury & Sharon Hernandez by Fairview Land Surveying (Sep, 2000)
- Survey by Haywood Civil Engineering & Land Surveying, Inc. (Jul, 2015)

Lorain County Subdivision Plat Records

- Garden of Eaton Allotment No. 1 (Dec, 1978)(PV 34, Pg 75)

Lorain County Deed Records

Volume and Pages as indicated

Lot Split & Consolidation for Hugh & Sandra Graham

Being a parcel of land located in part of Original Lot 57, Eaton Township, Twp 5 North, Range 16 West, Connecticut Western Reserve, Lorain County, Ohio

SCALE 1"=80'

BEARINGS ARE RELATIVE TO THE OHIO STATE PLANE COORDINATE SYSTEM, NORTH ZONE (3401), NAD83(2011), AND CORRECTED VIA THE ODOT VRS

MINIMUM ERROR OF CLOSURE: 1: 10,000

VECTOR SURVEYING SERVICES, LLC

OFFICE: 440-865-8445 AMHERST, OH
VECTORSURVEYING@YAHOO.COM

Job No.	17-045	Drawn By:	CAD
Date:	Jun, 2017	Checked By:	TDH