

ACCEPTED
 LOAN CO.
 MORTGAGE
 DATE 6-5-17
 PAGE 1-00-043
 BY R. MAINES
 #17-03686-X

01-00-043-000-003
 01-00-044-000-009

AREA BREAKDOWN

Within Parcel 1: 1.8752 acres (Calc)
 Within R/W: 0.1291 acres (5,626.9468 ft²)
 Within O.L. 44: 0.6273 acres (27,326.4099 ft²)
 Within O.L. 43: 1.2479 acres
 1.838 acres (Deed)

Within Parcel 2: 0.6354 acres (27,677.0156 ft²)
 Within R/W: 0.0868 acres (3,779.2946 ft²)
 0.66 acres (Deed)

LEGEND

SET	FOUND	DESCRIPTION
○	●	IRON PIN/ROD
◇	◆	SURVEY NAIL
⊙	⊚	MAG SPIKE
⊗	⊘	DRILL HOLE
⊕	⊖	RAILROAD SPIKE
⊠	⊡	MONUMENT BOX
⊙	⊚	CONCRETE MONUMENT
○	●	IRON PIPE
▲	▲	STONE
■	■	WOOD POST

ABBREVIATIONS

(D) PER DEED (M) MEASURED (P) PER PLAT
 (C) CALCULATED (SS) PER SNEZEK SURVEY
 (RS) PER ROSEBECK SURVEY (SP) PER SPILLMAN SURVEY
 (LS) PER LAUNDON, SIMON, CAHL SURVEY
 ALL IRON PINS SET ARE 5/8"x30" REBAR WITH
 YELLOW PLASTIC CAPS STAMPED "HOZALSKI P.S.
 8677 / VECTOR SURVEYING", SET 5" ABOVE
 GROUND, UNLESS OTHERWISE NOTED.
 ALL DRILL HOLES SET ARE 5/8" IN DIAMETER

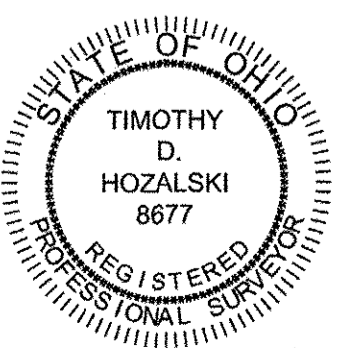

REFERENCES

Lorain County Survey Records
 Survey for Robert D. & Michele A. Skidmore By Laundon-Simon-Cahl & Assoc. Inc. (Dec, 1991)
 Survey by KS Associates (Jun, 1993)
 Survey for Mary V. Lynn Estate by Rosebeck & Assoc. (Aug, 2003)
 Survey for Robert C. Joslyn by Snezek & Assoc. (Dec, 2014)
 Survey for Denny J. & Lisa M. Owens by Spillman Surveying (Nov, 2015)

Lorain County Deed Records
 Volume and Pages as indicated

Retracement for Matthew & Louise Erickson
 Being a parcel of land located in part of Original Lot 43 & 44, Brownhelm Township, City of Vermilion, Twp 6 North, Range 19 West, Connecticut Western Reserve, Lorain County, Ohio
 SCALE 1"=60'
 BEARINGS ARE RELATIVE TO THE OHIO STATE PLANE COORDINATE SYSTEM, NORTH ZONE (3401), NAD83(2011), AND CORRECTED VIA THE ODOT VRS
 MINIMUM ERROR OF CLOSURE: 1 : 10,000

VECTOR SURVEYING SERVICES, LLC

OFFICE: 440-865-8445 AMHERST, OH
 VECTORSURVEYING@YAHOO.COM

Job No. 17-039-A	Drawn By: CAD
Date: May, 2017	Checked By: TDH