

SURVEYOR'S CERTIFICATE: THIS SURVEY WAS PERFORMED IN ACCORDANCE WITH SECTION 4733-37 OF THE OHIO ADMINISTRATIVE CODE STANDARDS FOR BOUNDARY SURVEYS

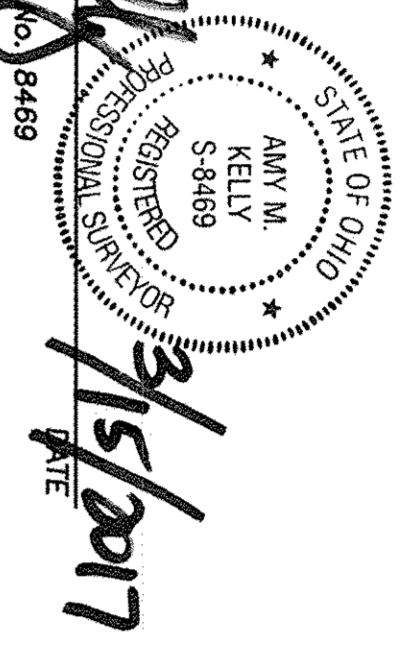

APPROVED/REJECTED BY THE CITY ENGINEER OF AVON, OHIO

LOT SPLIT SURVEY SITUATED IN CITY OF AVON, COUNTY OF LORAIN, AND STATE OF OHIO AND KNOWN AS BEING PART OF ORIGINAL AVON TOWNSHIP SECTION NUMBERS 16 & 21

04-00-021-000-212 CUSTOM CLINERY, INC INST. #2008-0124810 21.3619 ACRES (REC.)

04-00-021-000-228 BCSA PROPERTIES LIMITED PARTNERSHIP INST. #2005-0071045 14.020 ACRES (REC.)

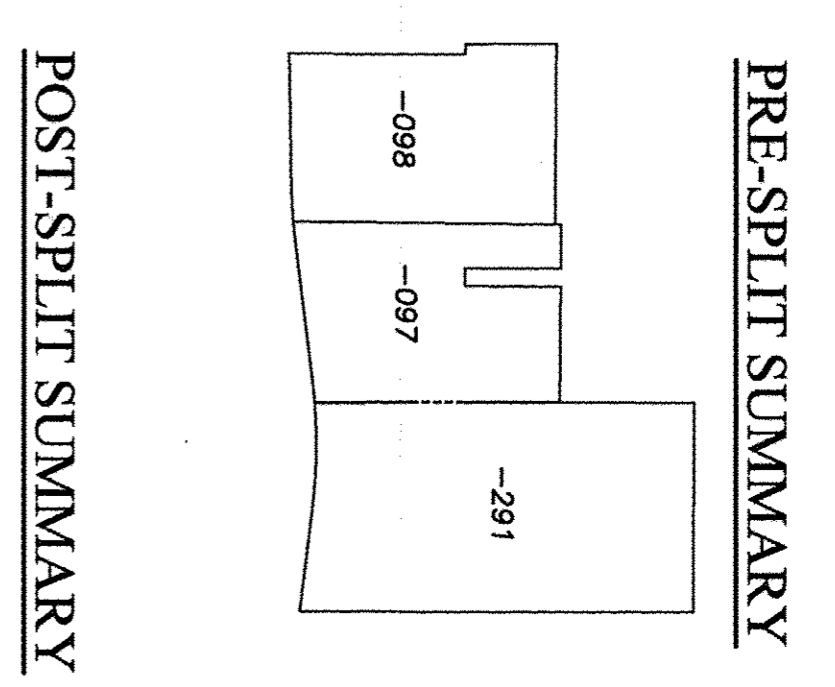

POST-SPLIT SUMMARY

Table with columns: REVISION(S), DATE, BY, DESCRIPTION

REFERENCES: LORAIN COUNTY TAX MAP RECORDS, LORAIN COUNTY DEED RECORDS FOR SUBJECT, ADJOINING PARCELS, etc.

LEGEND: (R) (REC.) RECORD INFORMATION, (M) (MEAS.) MEASURED INFORMATION, (C) (CALC.) CALCULATED INFORMATION, etc.

GRAPHIC SCALE: 0 50 100 200 (IN FEET) SCALE: 1" = 100'

BRAMHALL ENGINEERING AND SURVEYING COMPANY 801 MOORE ROAD AVON, OHIO 44011 (440) 934-7878

SHEET 1 OF 1 JOB NO. 15-4216

