

MAP OF SURVEY  
for  
**367 SOUTH MAIN STREET**

Known as being part of Original Russia Township Lot No. 96,  
now situated in the

**CITY OF OBERLIN**  
**COUNTY OF LORAIN - STATE OF OHIO**

**Mc Steen & Associates**  
LAND SURVEYORS  
1415 East 286th Street Wickliffe, OH 44092  
440.585.9800 Fax 440.585.9802 www.mcsteen.com

This survey is a boundary survey prepared in accordance with Chapter 4733-37, Ohio Administrative Code. The basis of bearings for this survey is North 00°-00'-00" East as the centerline of South Main Street, as evidenced by monuments found, and is an assumed meridian used to denote angles only. Distances are given in feet and decimal parts thereof. All iron pins shown as set are 30" long 5/8" rebar with an identification cap stamped "McSTEEN CA 96-026".

*Adam D. Treat*

ADAM D. TREAT

REG. PROF. SURV. No. 8058

Job No.: 16-142

Field Date: September 1, 2016

Survey Date: September 9, 2016

Latest Revision Date:

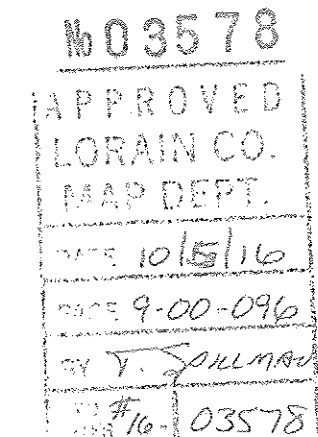
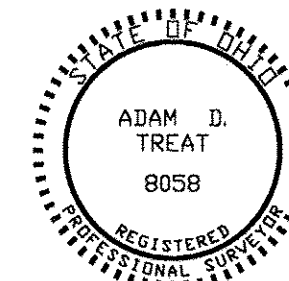

SCAN # 48962

© 2016 McSteen & Associates, Inc.

- denotes rebar found as noted
- ☒ denotes rebar inside monument box assembly found as noted
- denotes iron pipe found as noted
- ⊙ denotes 5/8" diameter x 30" long rebar with "McSTEEN CA 96-026" ID cap set

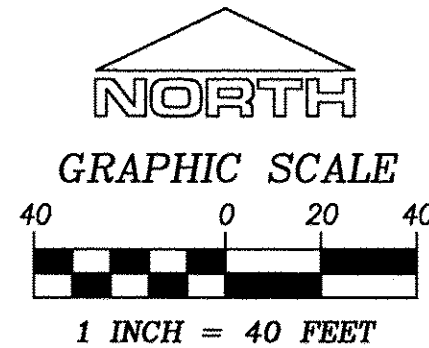

**SOUTH MAIN STREET (66')**

**EAST HAMILTON STREET (60')**

