

File Name: C:\Users\Vector Surveying\Documents\Surveying files\Jobs\2016\16-048-Donna Reisz-37176 Chestnut Ridge Rd Retracement\_Eaton Twp\16-048-reisz.dwg

- ① 1" IRON PIPE FND N0° 09' 38"W 30.68' FROM CL 0.15' WEST OF LINE (BY PERPENDICULAR MEAS.) DOWN 1"
- ② 3/4" IRON PIPE FND N0° 07' 10"E 41.35' FROM CL USED FOR LINE- DOWN 7"
- ③ 1" IRON PIPE FND N0° 11' 38"E 195.95' FROM CL 0.25' EAST OF LINE (BY PERPENDICULAR MEAS.) UP 5"
- ④ 5/8" IRON PIN SET 31.20' FROM CL FLUSH W/ GROUND
- ⑤ 3/4" IRON PIPE FND N0° 07' 10"E 41.67' FROM CL USED FOR LINE- DOWN 1"
- ⑥ 3/4" IRON PIPE FND N0° 03' 53"E 41.61' FROM CL NOT USED- DOWN 1"
- ⑦ 3/4" IRON PIPE FND N0° 07' 10"E 41.40' FROM CL USED FOR LINE- DOWN 2"
- ⑧ 3/4" OBLITERATED IRON PIPE FND & REPLACED WITH 5/8" IRON PIN SET- UP 5"

**REFERENCES**

Lorain County Survey Records  
 Clarence S. Brush Subdivision Plat by Laundon & Huffman (July, 1960)  
 Survey for Henry Sunderman by Laundon, Simon, Cahl & Assoc. (Apr., 1987)  
 Survey for Melvin & Robert Ternes by Carl Anderson (2000)  
 Lorain County Deed Records  
 Volume and Pages as indicated

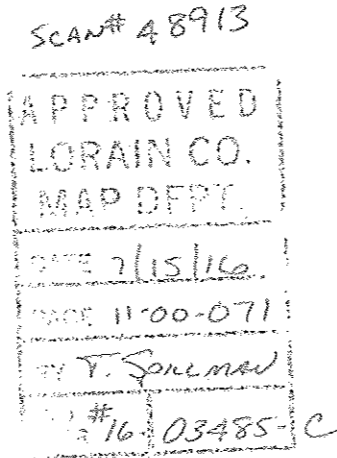

1" IRON PIPE FND N0° 14' 32"E 30.83' FROM CL USED FOR LINE UP 5"

1" IRON PIN IN MONUMENT BOX FOUND & USED FOR CL

P.O.B. 1" IRON PIN IN MONUMENT BOX FOUND & USED FOR CL

N67° 43' 30"E 193.62'(M) 193.68'(AS)

**ABBREVIATIONS**

(D) PER DEED (M) MEASURED  
 (P) PER CLARENCE S. BRUSH SUBDIVISION PLAT  
 (C) CALCULATED (AS) PER ANDERSON SURVEY  
 (LSC) PER LAUNDON, SIMON, CAHL SURVEY  
 ALL IRON PINS SET ARE 5/8"x30" REBAR WITH YELLOW PLASTIC CAPS STAMPED "HOZALSKI P.S. 8677/ VECTOR SURVEYING"  
 ALL DRILL HOLES SET ARE 5/8" IN DIAMETER

**LEGEND**

SET	FOUND	DESCRIPTION
○	●	IRON PIN/ROD
◇	◆	SURVEY NAIL
⊙	⊛	MAG SPIKE
⊗	⊘	DRILL HOLE
⊕	⊖	RAILROAD SPIKE
△	▲	MONUMENT BOX
⊠	⊡	CONCRETE MONUMENT
○	●	IRON PIPE
▲	▲	STONE
■	■	WOOD POST

**TOTAL AREA**

0.9993 ACRES (43,529.3860 ft<sup>2</sup>)  
 0.0815 ACRES (3,551.4811 ft<sup>2</sup>) WITHIN R/W

**Retracement for Donna Reisz**  
 Being a parcel of land located in part of Original Lot 71, Eaton Township, Twp 5 North, Range 16 West, Connecticut Western Reserve, Lorain County, Ohio

SCALE 1"=80'  
  
 BEARINGS ARE RELATIVE TO THE OHIO STATE PLANE COORDINATE SYSTEM, NORTH ZONE (3401), NAD83(2011), AND CORRECTED VIA THE ODOT VRS  
 MINIMUM ERROR OF CLOSURE: 1 : 10,000

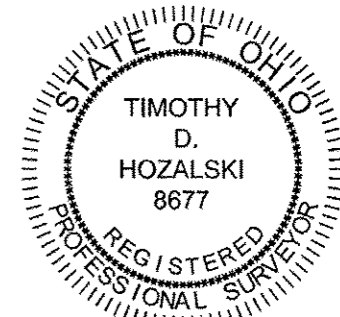

*Timothy D. Hozalski*  
 Timothy D. Hozalski, P.S. 7-06-16 Date



OFFICE: 440-865-8445 WAKEMAN, OH  
 VECTORSURVEYING@YAHOO.COM  

Job No.	16-048	Drawn By:	CAD
Date:	July, 2016	Checked By:	TDH

