

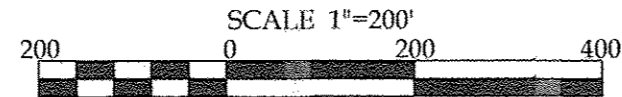

Retracement Survey for Charles & Wilda Collier
Being a parcel of land located in part of Original Lot 24,
Pittsfield Township, Twp 4 North, Range 18 West, Connecticut
Western Reserve, Lorain County, Ohio



BEARINGS ARE RELATIVE TO THE OHIO STATE PLANE
COORDINATE SYSTEM, NORTH ZONE (3401), NAD83(2011),
AND CORRECTED VIA THE ODOT VRS
MINIMUM ERROR OF CLOSURE: 1 : 10,000

OFFICE: 440-865-8445 WAKEMAN, OH
VECTORSURVEYING@YAHOO.COM

Job No.	16-006	Drawn By:	CAD
Date:	Feb, 2016	Checked By:	TDH

ABBREVIATIONS

(D) PER DEED (M) MEASURED (P) PER PLAT
(C) CALCULATED (PS) PER PISANELLI SURVEY
ALL IRON PINS SET ARE 5/8"x30" REBAR WITH
YELLOW PLASTIC CAPS STAMPED "HOZALSKI P.S.
8677/ VECTOR SURVEYING"

REFERENCES

Lorain County Survey Records
Survey by John Pozywak (5/1977)
Survey by Michael Pisanelli (5/2001)
Lorain County Deed Records
Volume and Pages as indicated

LEGEND

SET	FOUND	DESCRIPTION
○	●	IRON PIN/ROD
◇	◆	SURVEY NAIL
⊕	⊕	RAILROAD SPIKE
▲	▲	MONUMENT BOX
○	○	IRON PIPE

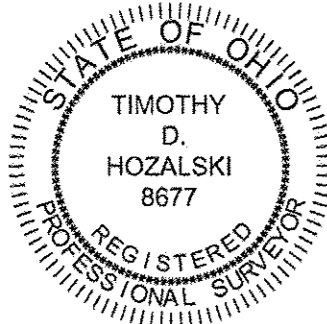

Timothy D. Hozalski
Timothy D. Hozalski, P.S. 2-03-16
Date

TOTAL AREA

64.0539 ACRES
2.1513 ACRES WITHIN R/W

Charles R. Collier & Wilda W. Collier
Trust Agreement, dated 11/09/1993
Instrument # 2003-0904544

Carl A. & Teresa M. Pelton
D.V. 1087, Pg. 502

KIPTON-NICKLE PLATE RD. (60' R/W)

N89° 44' 54"E
977.66'(M) 677.69'(PS) ORIGINAL LOT 24 ORIGINAL LOT 23

P.O.B.
1" IRON PIN IN
MONUMENT BOX
FND & USED

MAG NAIL
FND & USED
FLUSH

Douglas S. &
Catherine M. Benford
O.R. Vol 141, Pg.757

5/8" IRON PIN
W/ "MAP" CAP
FND & USED
UP 4"

396.00'(M)
923.90'(M)
S1° 11' 49"W

5/8" IRON PIN
W/ "MAP" CAP
FND & USED
UP 4"

5/8" IRON PIN W/ "MAP"
CAP FND 0.11' WEST OF LINE
(BY PERPENDICULAR MEASUREMENT)
UP 4"

Steven J. Schuster
Instrument #
2014-0499161

03484

APPROVED LORAIN CO. MAP DEPT
DATE 3-16-16
PAGE 14C
BY JHotfield
#16-03484

5/8" IRON PIN W/ "BRAMHALL"
CAP FND 0.14' NORTH OF LINE
(BY PERPENDICULAR MEASUREMENT)
UP 4"

1" IRON PIPE
FND & USED
RUSTED OFF-DOWN 2"

799.78'(PS)
799.85'(M)
S0° 18' 37"E
759.80'(C)
759.78'(PS)

5/8" IRON PIN W/ "McGANNON"
CAP FND 2.15' NORTH OF LINE
(BY PERPENDICULAR MEASUREMENT)
UP 4"

ORIGINAL LOT 24
ORIGINAL LOT 37

Jason Van Wingerden
Instrument # 2015-0566476

ORIGINAL LOT 23
ORIGINAL LOT 38

H&T Farms, Ltd.
Instrument #
2011-0359685