

**AREA BREAKDOWN**  
 Within Original Lot 11: 78.8063 acres  
 Within Original Lot 61: 34.7642 acres  
 Within Original Lot 10: 33.0388 acres  
 Within Original Lot 12: 1.8743 acres  
 Within Original Lot 1: 0.2000 acres (8,711.1894 ft<sup>2</sup>)  
**Total Combined Area: 148.6836 acres**  
 Within Baumhart Rd. R/W: 2.0111 acres

APPROVED  
 LORAIN CO.  
 RECORDS  
 DATE 1-13-16  
 PAGE 8-H  
 BY R. MAINES  
 #16-0336CA  
 08-12-001-000-002  
 08-13-010-000-018  
 08-13-011-000-002  
 08-13-012-000-012  
 09-00-061-000-006

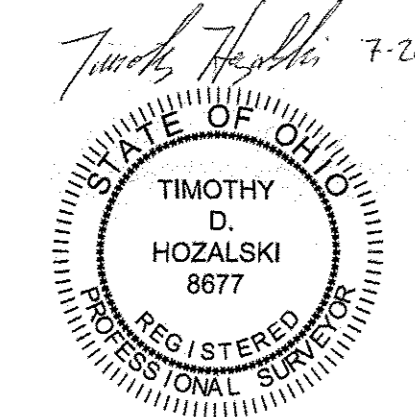

- LEGEND**
- | SET | FOUND | DESCRIPTION       |
|-----|-------|-------------------|
| ○   | ●     | IRON PIN/ROD      |
| ○   | ●     | SURVEY NAIL       |
| ⊕   | ⊕     | MAG SPIKE         |
| ⊗   | ⊗     | DRILL HOLE        |
| ⊕   | ⊕     | RAILROAD SPIKE    |
| ⊕   | ⊕     | MONUMENT BOX      |
| ⊕   | ⊕     | CONCRETE MONUMENT |
| ○   | ○     | IRON PIPE         |
| ○   | ○     | STONE             |
| ■   | ■     | WOOD POST         |

**Curve Table**

Curve #	Length	Radius	Delta	Chord Direction	Chord Length
C1	213.54	1909.86	6° 24' 22"	S7° 29' 52"W	213.42
C2	9.07	1909.86	0° 16' 20"	S10° 50' 08"W	9.07
C3	133.33	2546.41	3° 00' 00"	S12° 33' 10"W	133.31
C4	436.73	1909.86	13° 06' 07"	N7° 25' 06"E	435.78

**REFERENCES**  
 Lorain County Survey Records  
 Vol. 27, Page 70 (Jan, 1961)  
 Survey by T.L. Gibson (Aug, 1913)  
 Survey by John Pozywak (Jun, 1991)  
 Survey by Rodger G. Simon (Nov, 1998)  
 Survey by Thomas Simon & Assoc. (Aug, 1999)  
 Survey by Bramhall & Assoc. (Oct, 2001)  
 Survey by Vector Surveying Services (June, 2015)  
 Lorain County Deed Records  
 Volume and Pages as indicated

**Retracement & Consolidation Survey for David Hozalski**  
 Being a parcel of land located in part of Original Lot 1, Tract 12, part of Original Lots 10, 11, and 12, Tract 13, Henrietta Township, Twp 5 North, Range 19 West, and part of Original Lot 61, New Russia Township, Twp 5 North, Range 18 West, Connecticut Western Reserve, Lorain County, Ohio

SCALE 1"=200'  
 200 0 200 400

BEARINGS ARE RELATIVE TO THE OHIO STATE PLANE COORDINATE SYSTEM, NORTH ZONE (840), NAD83(2011), AND CORRECTED VIA THE ODOT VRS MINIMUM ERROR OF CLOSURE: 1 : 10,000

**VECTOR SURVEYING SERVICES, LLC**  
 OFFICE: 440-825-8445  
 VECTOR@SURVEYINGSERVICES.COM  
 Job No. 14-002 Drawn By: CAD  
 Date: Dec, 2015 Checked By: TDH