

PLAT OF SURVEY PREPARED
FOR
THOMAS M. McCRAW

INST. # 2012-0403136

SITUATED IN THE TOWNSHIP OF PITTSFIELD, COUNTY OF LORAIN, STATE OF OHIO
AND BEING PART OF ORIGINAL PITTSFIELD TOWNSHIP LOT 30



CAMDEN TWP.
PITTSFIELD TWP. O.L. 30

QUARRY RD. 60'

EASEMENT TO THE STATE OF OHIO DV. 298 PG. 4

PIFER, EDWARD K.
& CHERYL I.
INST. # 1999-0625972

1.2450 AC.
McCRAW, THOMAS M.
INST. # 2012-0403136

BRICKER, ROBERT L.
& ROBIN MARIE
DV. 1259 PG. 318

271.25' R.
271.17' CALC.
S 01°43'00" E

271.17' CALC.
271.25' R.
S 01°43'00" E
416.52' CALC.
416.60' R.

1.17 AC. REC.
0.7914 AC. CALC.
N 87°58'00" W
200' R.
200.43'

L=244.76' R.
L=244.74' CALC.
R=11450.20

R=11459.20
L=1960.01
Tap=992.55

R=333.03
L=1957.92
Tap=740.02

U.S. ROUTE 20

APPROVED
LOHMEYER CO.
RECORDS

DATE 2-22-16

PAGE 14-A

BY R. MAINES

#10-03387A

LEGEND

- I.P. FD
- ⊗ MON. BOX I.P. FD
- ⊙ 5/8" REBAR SET
CAPPED
T. SPILLMAN
P.S. 8595

BASIS OF BEARINGS - NORTH LINE OF O.L. 30
OF LORAIN COUNTY RECORDS (N 87°58'00" W)
& PENFOUND SURVEY DATED DEC. 3, 1956
IRON PIN SET APPROX. 20" LONG
WITH PLASTIC CAP T. SPILLMAN P.S. 8595

DIMENSIONS SHOWN ON THIS PLAT ARE EXPRESSED
IN FEET AND DECIMAL PARTS THEREOF. BEARINGS
ARE TO AN ASSUMED MERIDIAN AND ARE USED TO
INDICATE ANGLE ONLY. ALL DIMENSIONS
WERE FOUND BY MEASUREMENTS
HEREON. ALL DIMENSIONS ARE CORRECT
TO THE BEST OF MY KNOWLEDGE AND BELIEF.

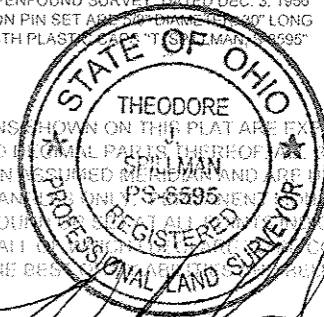

Theodore Spillman
THEODORE SPILLMAN, P.S. 8595

SPILLMAN SURVEYING
PROFESSIONAL LAND SURVEYORS

694 OAKHURST CT.
AMHERST, OHIO 44001
(440) 320-7875

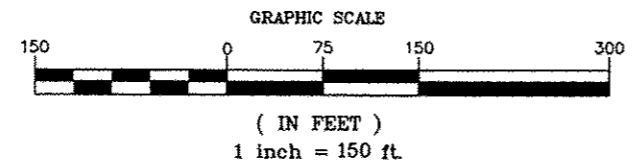

14-00-030-000-029-030