

**REFERENCES**

LORAIN COUNTY ENGINEER'S MONUMENT REFERENCE SURVEY.  
 SURVEY FOR ROBERT LODGE BY C. WARYU APRIL 26, 1993  
 SURVEY FOR ROBERT & GINA LODGE BY P. A. ROSEBECK & ASSOCIATES FEB. 7, 2001  
 DEED RECORDS SHOWN HEREON.

**LEGEND**

IRON PIPE FOUND ●  
 IRON PIN SET ○  
 LORAIN COUNTY MONUMENT ■

OMNIS INDUSTRIES  
 DEED VOLUME 975, PAGE 437  
 PPN 09-00-024-000-002  
 24.85 ACRES

BEARINGS ARE REFERENCED TO THE MONUMENTED CENTERLINE  
 OF PYLE S. AMHERST ROAD AS REFERENCED IN THE OWNER'S DEED  
 RECORDED IN DOCUMENT NO. 2001-0741978 DATED APRIL 3, 2001.  
 "S 00°00'04\" W" ASSUMED MERIDIAN ALONG CENTERLINE



**03331**  
 APPROVED  
 LORAIN CO.  
 MAP DEPT  
 DATE 12-29-14  
 PAGE 09-00-023-018  
 BY [Signature]  
 #14-03331

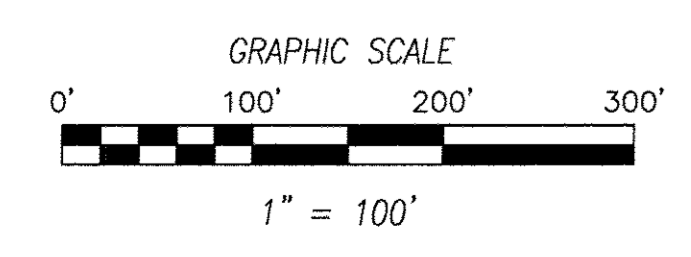

THE INFORMATION SHOWN HEREON WAS PREPARED  
 BY ME FROM THE RESULTS OF A BOUNDARY SURVEY  
 CONDUCTED BY ME IN APRIL AND JULY 2013 IN  
 ACCORDANCE WITH O.A.C. 4733-37.  
 [Signature]  
 PHIL A. ROSEBECK REGISTERED SURVEYOR NO. 6696

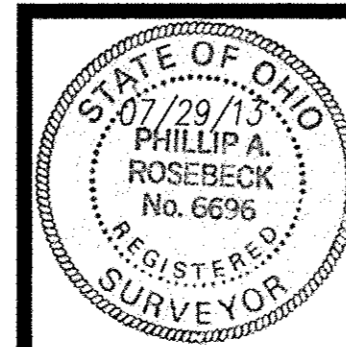

SURVEY & SPLIT  
**ROBERT G. LODGE & GINA MCKAY LODGE**  
 PART OF ORIGINAL RUSSIA TOWNSHIP LOTS 23 & 33,  
 LORAIN COUNTY, STATE OF OHIO  
 JULY 29, 2013

NO.	DATE	DESCRIPTION	BY
0	07/29/13	ORIGINAL ISSUE	PAR

**P.A. ROSEBECK & ASSOCIATES**  
 REGISTERED SURVEYOR  
 705 WILLOW CREEK DRIVE, AMHERST, OHIO 44001  
 PHONE: (440) 988-4657

SHEET  
 1  
 OF  
 1