

C:\Documents and Settings\All Users\Documents\autocad drawings\2004\040413.S.dwg, 10/15/2004 1:49:29 PM, 1:40

ANY INFORMATION OR DATA ON THIS DRAWING IS NOT INTENDED TO BE SUITABLE FOR REUSE BY ANY PERSON, FIRM, OR CORPORATION OR ANY OTHERS ON EXTENSIONS OF THIS PROJECT OR FOR ANY USE ON ANY OTHER PROJECT. ANY REUSE WITHOUT WRITTEN VERIFICATION AND ADAPTATION BY THE ENGINEER OR SURVEYOR FOR THE SPECIFIC PURPOSE INTENDED WILL BE AT THE USER'S SOLE RISK AND WITHOUT LIABILITY OR LEGAL EXPOSURE TO THE ENGINEER OR SURVEYOR. REUSE OF ANY INFORMATION OR DATA ON THIS DRAWING BY ANY PERSON, FIRM OR CORPORATION IS A VIOLATION OF THE AGREEMENT AND IS SUBJECT TO LITIGATION BY ENGINEER OR SURVEYOR.

2 WORKING DAYS BEFORE YOU DIG CALL TOLL FREE 800-362-2764 0460 UTILITIES PROTECTION SERVICE

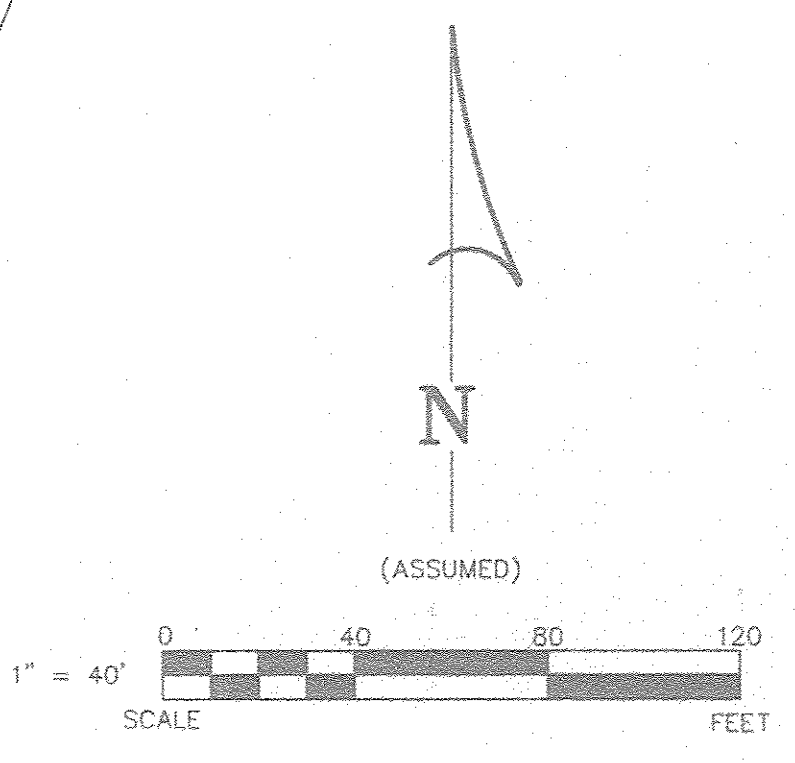

#01792
APPROVED
LORAIN CO.
MAP DEPT
DATE 11/18/04
PAGE 20-20-010-c
BY UHATfield
#04-01792

REFERENCES

DEED VOLUMES, OFFICIAL RECORD VOLUMES AND INSTRUMENT NUMBERS AND PAGES AS SHOWN
LORAIN COUNTY ENGINEER'S FIELD BOOK VOL. 177, PGS. 40-47
SURVEY FOR PARCEL 2020-010-000-005 BY A. BURRAS & ASSOC., DATED JANUARY 13, 1967
SURVEY FOR PARCEL 2020-010-000-009 BY W. L. FOX, DATED JANUARY 4, 1984
SURVEY FOR PARCEL 2020-010-000-003 BY K. E. MCCARTNEY & ASSOCIATES, DATED APRIL, 1989
SURVEY FOR PARCEL 2020-010-000-011 BY W. L. FOX, DATED NOVEMBER 14, 1989
SURVEY FOR PARCEL 2020-010-000-013 BY K. E. MCCARTNEY & ASSOCIATES, DATED JUNE 1996

LEGEND

- SET FOUND
- ⊕ MONUMENT
- ⊙ RAILROAD SPIKE
- ⊙ P.K. NAIL
- ⊙ IRON PIPE
- ⊙ DRILL HOLE
- ⊙ 5/8" x 30" IRON ROD
- ⊙ IRON ROD
- ⊙ FENCE POST
- ⊙ STONE
- ⊙ MONUMENT BOX
- D DEED
- P PLAT
- M MEASURED
- C CALCULATED
- ∅ OUTSIDE DIAMETER
- SR SURVEY RECORD

THIS SURVEY DOES NOT INCLUDE A TITLE SEARCH. ALL EASEMENTS OR OTHER ENCUMBRANCES ON OR OVER THE LAND ARE NOT SHOWN ON THIS SURVEY. PLEASE FURNISH ALL INFORMATION IF THESE ARE REQUIRED ON THIS PLAT. ALL FOUND SURVEY MONUMENTS WERE AT GRADE OR PAVEMENT SURFACE AND IN GOOD CONDITION, UNLESS OTHERWISE NOTED.

I HEREBY DECLARE THAT I HAVE SURVEYED THE ABOVE DESCRIBED PROPERTY DURING SEPTEMBER-OCTOBER, 2004 AS PER LEGAL DESCRIPTION FURNISHED TO ME. THIS SURVEY IS SUBJECT TO ALL LEGAL HIGHWAYS, EASEMENTS, RESTRICTIONS, LEASES OF RECORD AND OF RECORDS IN RESPECTIVE UTILITY OFFICES. THE BEARINGS REFERRED TO HEREON ARE BASED ON AN ASSUMED MERIDIAN AND ARE FOR THE PURPOSE OF ANGULAR MEASUREMENTS.



John M. Musteric 10-15-2004
JOHN M. MUSTERIC, P. S. NO. 7629 DATE

J. MUSTERIC & ASSOCIATES
CONSULTING ENGINEERS and SURVEYORS
303 SOUTH ARCH STREET
FREMONT, OHIO 43420
419-355-8214

SURVEY FOR
TODD A. & CHRISTINE L. CRAWSHAW
BEING A PARCEL OF LAND SITUATED IN SURPLUS LOT 10 OF THE GORE STRIP,
T-2-N, R-19-W, ROCHESTER TOWNSHIP, LORAIN COUNTY, OHIO

EXISTING	PROPOSED
DRAWN JOB 10/04 JMM	CHECKED JOB 10/04 JMM
DATE	DATE
REVISIONS	REVISIONS