

SURVEY

SHIRLEY M. JONES  
 8210 PYLE-S.AMHERST ROAD, AMHERST, OH 44001  
 PPN 05-00-014-000-008  
 PART OF ORIGINAL AMHERST TOWNSHIP LOT 14,  
 AMHERST TOWNSHIP, LORAIN COUNTY, STATE OF OHIO  
 P. A. ROSEBECK & ASSOCIATES - REG. SURVEYOR  
 705 WILLOW CREEK DRIVE, AMHERST, OH 44001  
 PH: 440-988-4657  
 SCALE 1"=250' 07/01/14

*Phil A. Rosebeck*

PHIL A. ROSEBECK  
 REG. SURVEYOR 6696

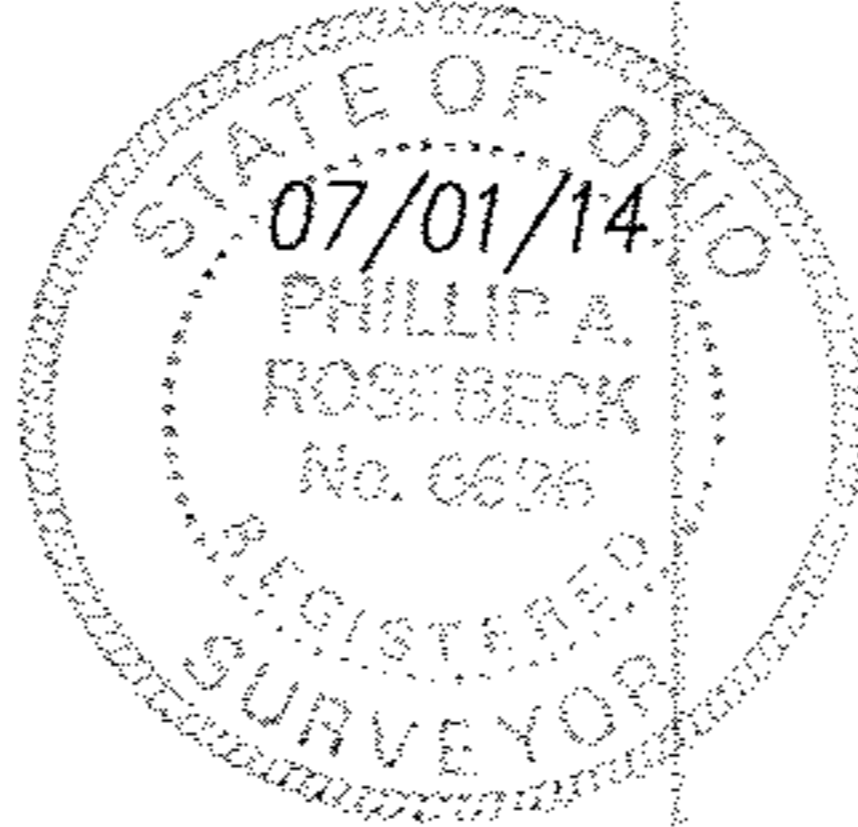

REFERENCES:

SCHEMATIC PLAN - PYLE S. AMHERST RD. PID9339  
 SURVEY FOR HENRY OTT 1926 WARDEN & LAUNDON  
 SURVEY FOR WALTER SMITH, JR. 1998 P. MCGANNON  
 2013-0452467 FAWN A. & WALTER N. SMITH  
 DEED VOL 445, PAGE 582 MCQUATE TO STILGENBAUER  
 DEED VOL 581, PAGE 572 STILGENBAUER TO SZUCH

MIDDLE RIDGE RD.

N 624470.46  
 E 2040499.38

IPIN MON BOX  
 FD & USED

S 07°01'36" E 591.69'

O.L. 15

N 623883.26  
 E 2040571.76

IPIN MON BOX  
 FD & USED

S 00°22'43" W 330.12'

O.L. 14

ANGLE POINT  
 NO MONUMENT

S 06°33'39" E 675.16'

N 622882.49  
 E 2040646.71

IPIN MON BOX  
 FD & USED

S 11°13'51" W 425.15'

N 622465.51  
 E 2040563.92

IPIN MON BOX  
 FD & USED

O.L. 7

O.L. 14

RODNEY H. BAILEY 10/21/57  
 DEED VOLUME 708, PAGE 229

S 89°43'30" W 582.60'CALC. 584.04'REC.

3/4" IPIPE FD  
 USED  
 N 622174.40  
 E 2039929.71

5/8" IPIN SET  
 @326.40'C.L.  
 N 622175.70  
 E 2040185.90

3/4" IPIPE FD  
 @26.38'C.L.  
 N 622177.07  
 E 2040485.89

3/4" IPIPE FD  
 59.93'S, 0.22'E.

SHIRLEY M. JONES 01/14/14  
 DOC. NO. 2014-0492213  
 2.3226 ACRES DEED  
 2.3176 ACRES SURVEY

5/8" IPIN SET  
 @252.27'C.L.  
 N 621997.66  
 E 2040228.06

3/4" IPIPE FD  
 @27.23'C.L.  
 N 621998.40  
 E 2040453.03

3/4" IPIPE FD  
 USED  
 N 621996.67  
 E 2039929.66

N 89°48'38" E 550.64'CALC. 548.50'REC.

JASON E. JASINSKI 09/27/07  
 DOC. NO. 2007-0224310

TIMOTHY WAYNE ABRAHAM, TRUSTEE  
 01/15/13 DOC. NO. 2013-0444374

S 00°01'03" W  
 177.75'CALC, 178.73'REC.

181.57'CALC. 182.00'REC.

S 10°09'23" W 790.63'CALC  
 PYLE-S.AMHERST ROAD 50'

316.14'CALC. 315.20'REC.

APPROVED LORAIN CO. MAP DEPT
DATE 9-12-14
PAGE 5-00-014 A
BY R. MARINES
#14-03018 D

IPIN MON BOX  
 FD & USED

N 621687.33  
 E 2040424.51

WALTER N. SMITH, JR., TR. 12/08/05  
 DOC. NO. 2005-0115390.

GRAPHIC SCALE

0' 100' 200' 300'



SCALE: 1"=100'

Scan # 40923

05-00-014-000-008