



LAUNDON • SIMON • CAHL & ASSOC., INC.
 CONSULTING ENGINEERS & SURVEYORS
 110 MIDDLE AVE., ELYRIA, O. 44035

SURVEY FOR:

CHARLES J. & EVANGELINE
 FANNARA

Orig. Lot 44	City of	Date FEB. '92 Scale 1"=100'
Orig. Sec	Village of	Dwn. by R.G.S. Chkd. by R.C.
Tract	County of LORAIN	Job No. 92-2152 F.B.222/72
Township of COLUMBIA	State of OHIO	Printed

REV. 9-24-92 R.G.S.

JOSEPH C. JR. &
 CHERYL A.
 HAMMER
 O.R.V. 988 P. 31

RICHARD A. &
 WENDY K.
 KOLLER
 O.R.V. 83 P. 887

LARRY J. SR. & GAIL M.
 ROBERTS
 O.R.V. 1355 P. 646

2.0880 Ac.

6.89°-14'-00" W. 504.08
 604.08' E



REBECCA L. FITCH
 INST. N° 970476401

DAVID M. BLAHNIK &
 PATRICIA A. WINCH
 O.R.V. 97 P. 674

-052 CHAS. J. & EVANGELINE C. FANNARA
 INST. N°s 980540354 & 990596969

I.P. Fd. - Used

N. 0°-46'-00" W

120'-030

S. 0°-46' E.

120'

100.00

I.P. Fd.

6.89°-14'-00" W.
 550.66' E

532.85' E

N. 89°-14'-00" E. 237.99' E

I.P. Set

S. 0°-46'-00" E.
 40.00

I.P. Set

RONALD W. FITCH
 V. 1287 P. 557

131.35'

32.84'

43.78'

32.84'

N. 23°-14'-00" E.

131.35'

361.21'

492.56' to R.R.S. Fd.

ENICHOLS RD.

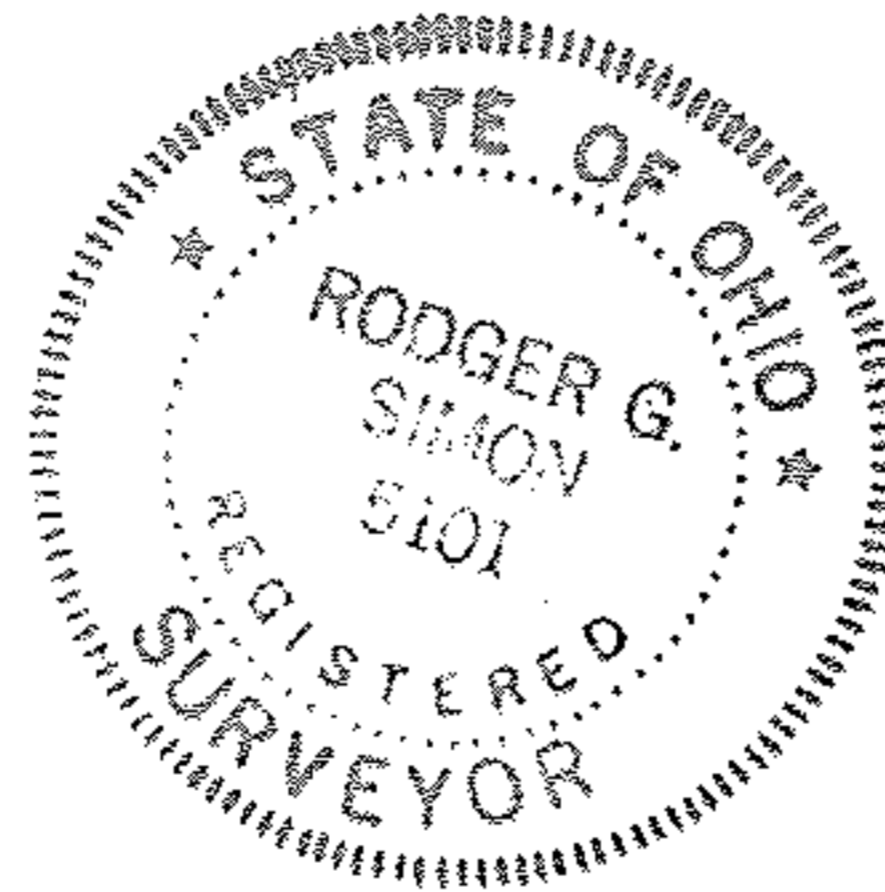

COLUMBIA WEST RIVER RD. 60'

99-0059

APPROVED LORAIN CO. MAP DEPT.
DATE 7-16-99
PAGE 12-00-044-A
BY D. Holland
VOID AFTER 99 00159

REV. 5-17-99
 REV. 4-6-99

12-00-044-A

12-00-044-000-B-C-D-E

SCAN # 48083