

11-00-072-000

STATE OF OHIO  
D.V. 1131

PCL. 188B-WL  
P. 684

OHIO

RE-LOCATED

RTE.



514.18' 10' ESMT. N-62°43'22"-E 554.45' R/W

EATON TOWNSHIP  
BD. OF TRUSTEES  
D.V. 1195 P. 895  
5.55 AC.

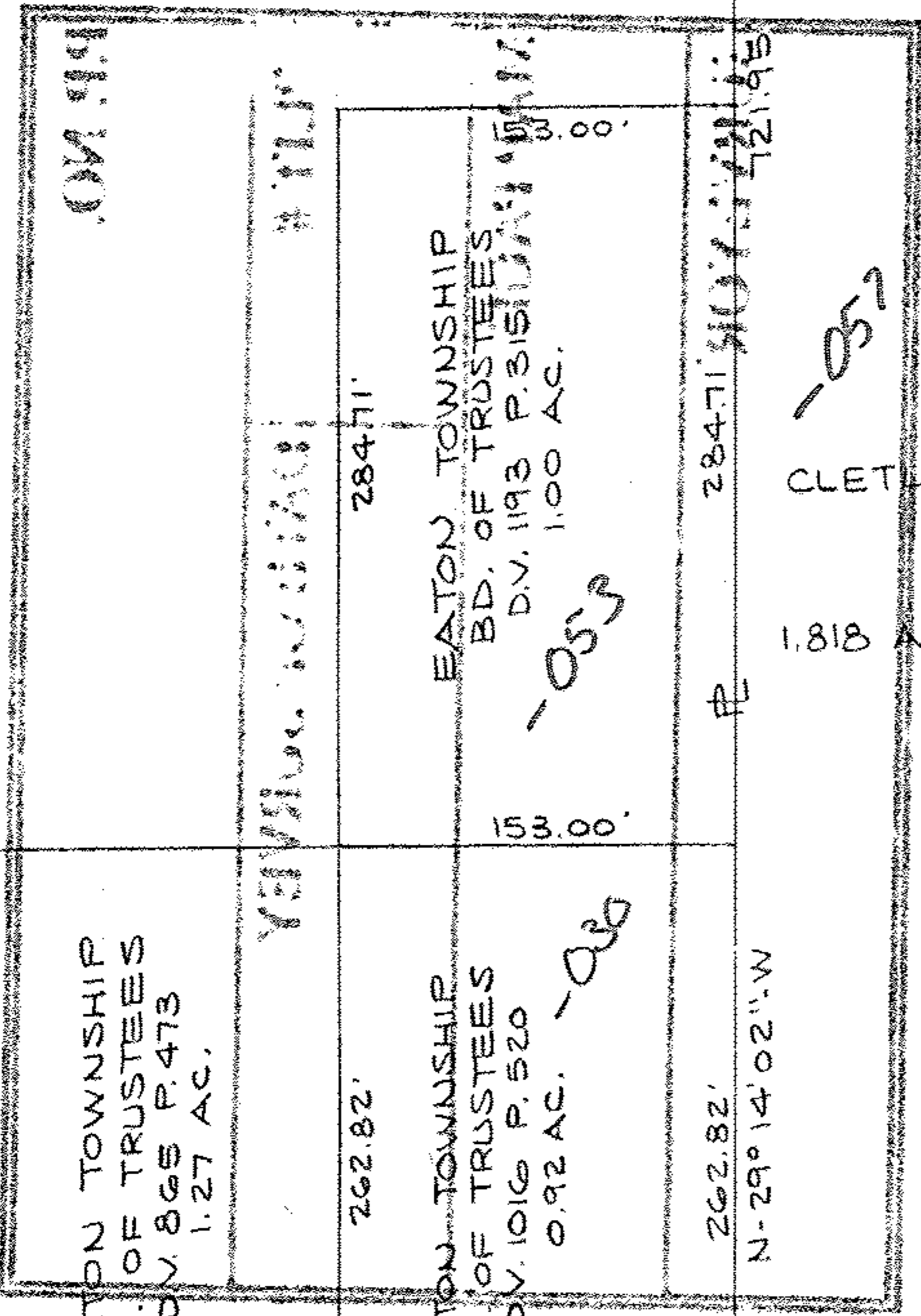

CLETUS P. GILGENBACH  
1.818 AC.

BUTTERNUT RIDGE ROAD #14497

PREPARED FROM RECORD ONLY.  
SCALE: 1" = 100'  
DEC. 23, 1981

APPROVED  
LORAIN CO.  
MAP DEPT.  
DATE 1-20-82  
PAGE 11-B  
BY T. McHair

PARCEL MAP  
PART OF EATON TOWNSHIP ORIGINAL  
LOT NO. 72  
TOWNSHIP OF EATON COUNTY OF LORAIN  
STATE OF OHIO

PREPARED BY  
KLEINOEDER-SCHMIDT & ASSOC.  
CONSULTING ENGINEERS & SURVEYORS