

GEORGE TASSE
Vol 830, Pg. 517

WESTLAKE SPORTSMAN CLUB
Vol 941, Pg. 577

BERNARD & FRANCES BATEMAN

VOL 695, Pg. 31

405.12 obs 405.60 Dd.

Vol 737, Pg. 599

Vol. 733, Pg. 567

Vol. 682, Pg. 137

Vol. 898, Pg. 53

SAM & JEAN BUCCI
Vol 883, Pg. 213

Vol 890, Pg. 208
435.60'

PAUL HRNCHAR ET AL
5/4/67
V. 943, Pg. 702

To
MARSHA CUNDIFF
7.1609 ACRES

To
SAM & JEAN BUCCI
3.4347 ACRES

60' R/W
N 02' 1" E

LDYE RD.

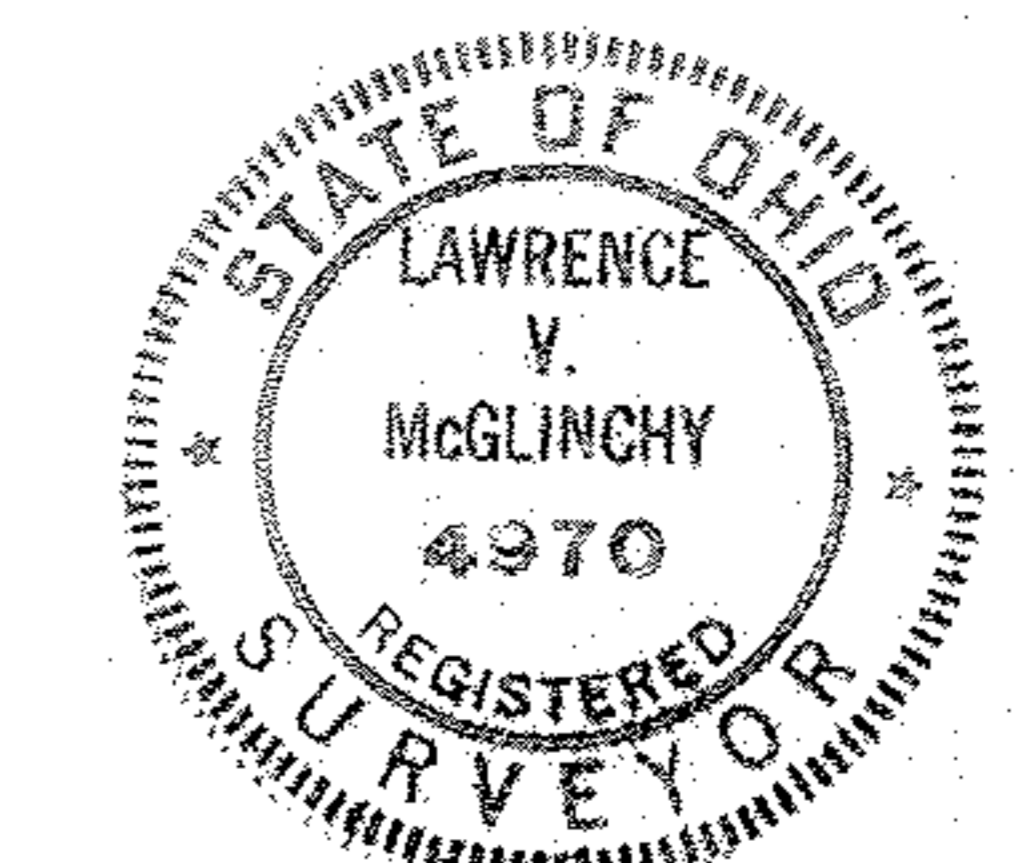

REV. 4-30-75

PLAT OF SURVEY FOR
ROY & MARGARET BORCHERT
(PAUL HRNCHAR ET AL PROPERTY)
O.L. 29, EATON TWP, LORAIN CO., OHIO

McGLINCHY & ASSOCIATES
PROFESSIONAL ENGINEERS & SURVEYORS
538 W. BROAD. ST. ELYRIA, OHIO 44035
Job No 75168 1" = 100' FEB, 1975